

**Landscape Statistics**

Asphalt: 10.6%  
 Concrete: 12.6%  
 Permeable Pavers: 30.8%  
 Soft Scope: 46.0%

For Building and Other Site Statistics see Architectural Plans.

Estimated Quantity of New Tree Planting on Site to be 194 Trees.



**LEGEND:**

- Permeable Paving
- Concrete
- Concrete w/ Cut Pattern
- Asphalt
- Sod
- Raised Planting Bed
- Planting at Grade
- Decorative Fencing
- Existing Tree
- Proposed Tree
- Future Public Street Tree

- Landscape Notes**
- Dimensions are shown in meters unless noted otherwise. Do not scale drawings.
  - Contractor to review layout on site with Landscape Architect prior to commencing work.
  - Contractor to verify grades and identify discrepancies prior to initiating work. Report any changes, discrepancies, or substitutions to the Landscape Architect for review prior to work.
  - It is the contractor's responsibility to locate and verify all existing utilities and services prior to construction.
  - Plant material support systems must be removed by the contractor at time of final acceptance. No extras will be paid to complete this work.
  - Contractor to provide minimum one (1) year warranty from date accepted on all work unless otherwise specified.
  - Grading and servicing shown is for information purposes. For grading and servicing information refer to engineering drawings.
  - For lighting information and power distribution refer to the electrical drawings.
  - Drawings are for construction only if Landscape Architects stamp is signed and dated by the Landscape Architect, and plans are approved by the Municipality.
  - Tree planting within the municipal right-of-way to be undertaken by the Municipality unless noted otherwise.
  - Unless otherwise specified all landscaped areas are to be sodded.
  - Unless otherwise specified, all undeveloped areas shall be undisturbed and kept free and clear of debris.
  - The Owner is to be aware of the Migratory Birds Convention Act, 1994. This Act is implemented by Environment Canada and the Owner is to make every effort to avoid removal of vegetation from the period of March 31st to August 31st.

**STAMP:**

NOT FOR CONSTRUCTION

**WHITEHOUSE URBAN DESIGN**  
 LANDSCAPE ARCHITECTS & URBAN DESIGNERS

**REVISIONS / SUBMISSIONS**

NO.	DESCRIPTION	DATE:
5	For Zoning By-law Amendment	2022-02-04
4	For Zoning By-law Amendment	2022-01-31
3	For Zoning By-law Amendment	2021-09-29
2	For Zoning By-law Amendment	2021-04-08
1	For Client Review	2021-03-08

**CLIENT:**  
 New Horizon Development Group

**PROJECT TITLE:**  
 Pulse  
 1842 King Street East  
 Municipal File: FC-20-043

**SHEET TITLE:**  
 Preliminary Landscape Plan

**DWG No. L1**      **DRAWN BY:** KZ  
**SHEET No. 1 of 2**      **DESIGN BY:** LWS and KZ  
**PROJECT No:** 008-20      **CHECKED BY:** LWS  
**SCALE:** As shown      **NORTH ARROW:**

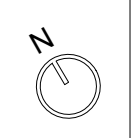

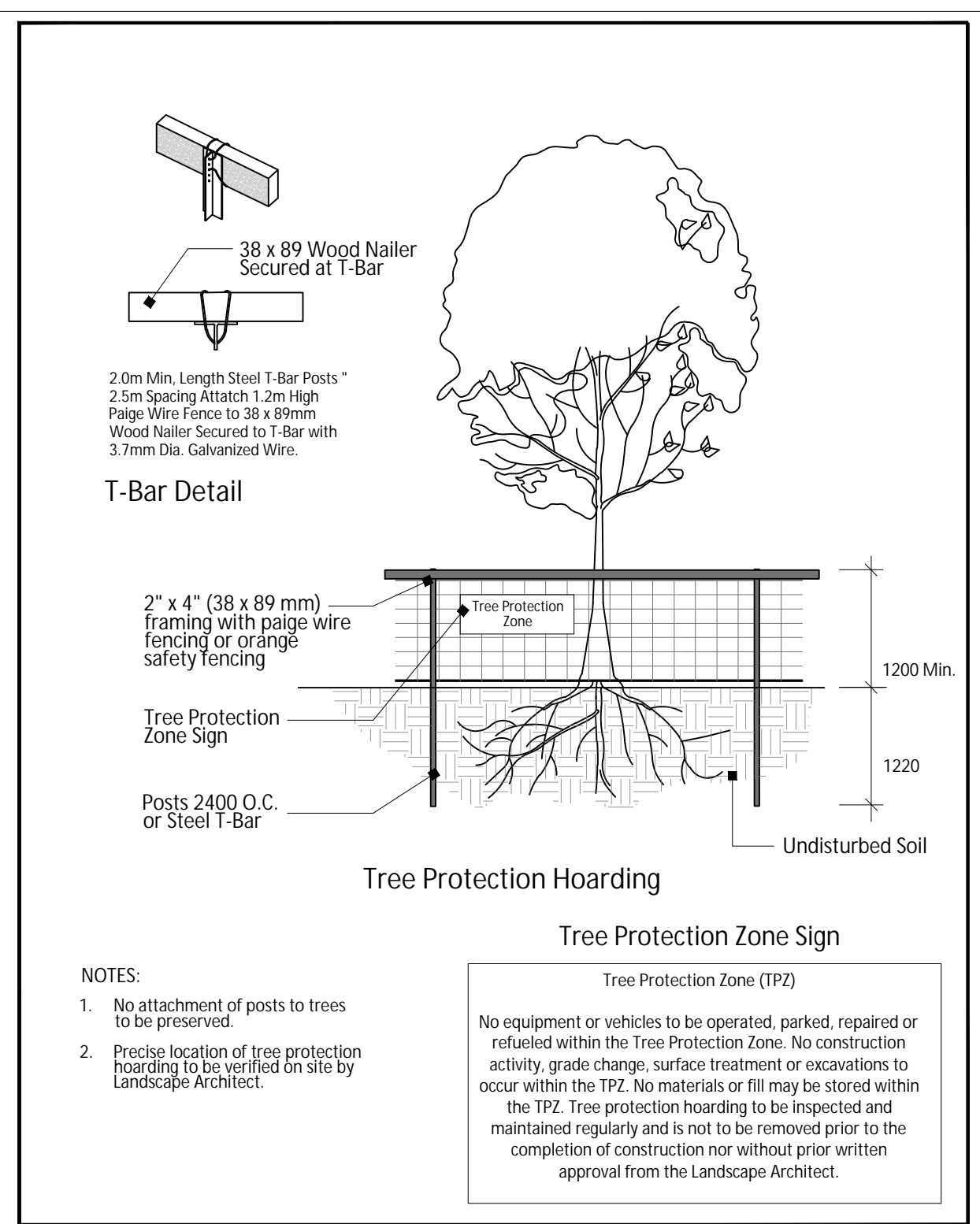
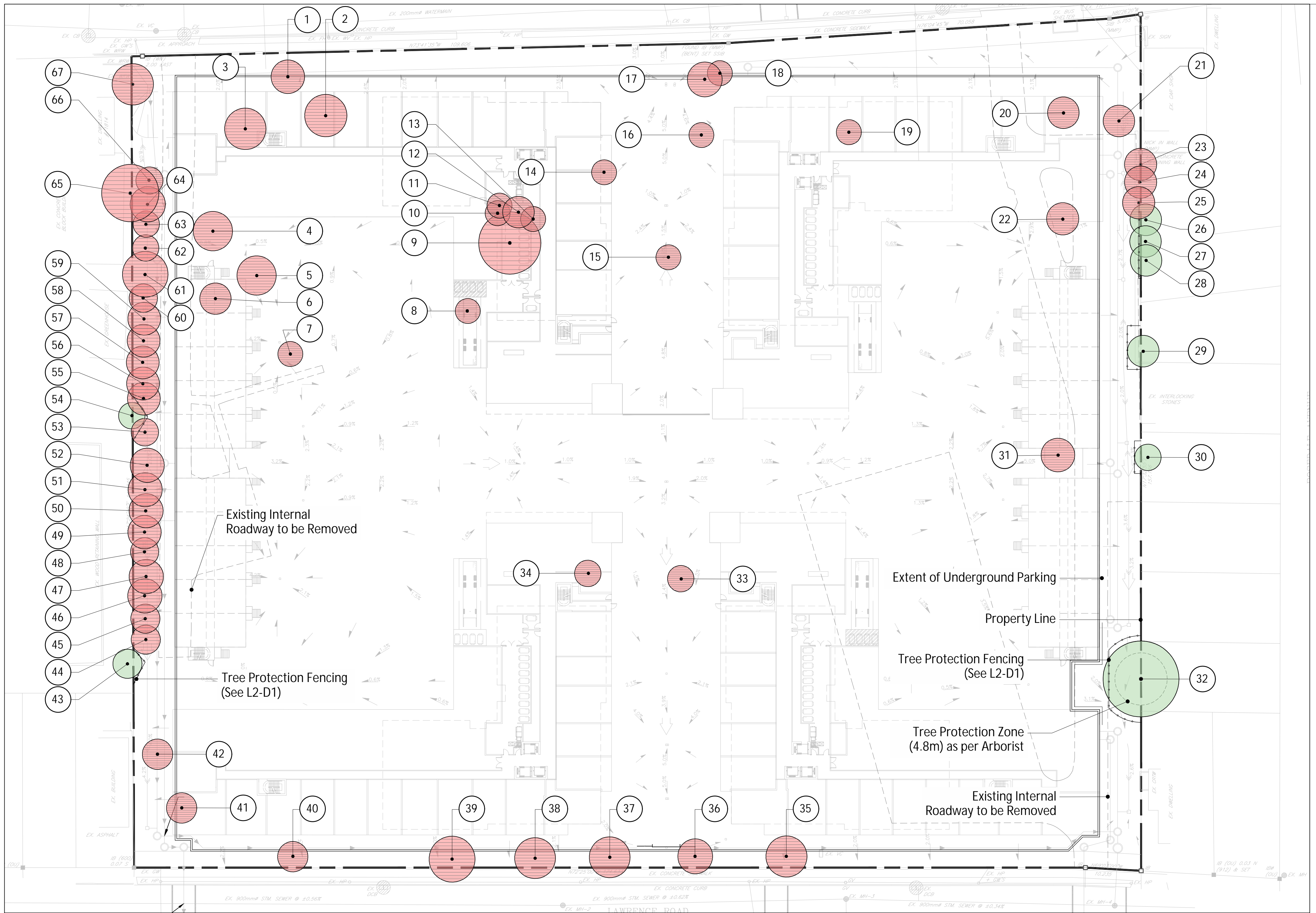

**D1 TREE PROTECTION ZONE DETAIL**

**NOTE (1):** A Verification of Tree Protection letter will be prepared by the tree management professional and submitted to the satisfaction of the City's Director of Planning, to confirm that all tree protection measures have been installed correctly.

**NOTE (2):** Where removal of a shared tree or adjacent tree is indicated, written approval by the shared/adjacent owner will be provided to the City under separate cover.

**MIGRATORY BIRDS**

- To assure compliance with the Migratory Birds Convention Act (MBCA 1994), incidental take of migratory birds, nests or eggs must be avoided by limiting activities during sensitive periods and mitigation measures to ensure appropriate nesting areas are re-established in the site.
- Vegetation clearing should not take place within the active nesting season between March 31<sup>st</sup> - August 31<sup>st</sup>.
- If the areas proposed for development are thoroughly checked during the active breeding season for bird nests by a qualified biologist during the construction phase, and no nests are found, then construction may be permitted.
- If any birds are found nesting, then in consultation with Environment Canada, a suitable buffer should be established around the nest, and no activities will be permitted within this buffer until the birds have left. However, it is possible to remove vegetation when fewer birds are breeding at the beginning and end of the timing window (i.e. Sept 1<sup>st</sup> - May 1<sup>st</sup>).

**QTY Tree Removal and Compensation Planting Statement**

0	No Public Trees are present on site.
67	Sixty Seven trees were inventoried as part of this development application. Fifty nine of the trees on the subject lands are proposed for removal, one of those is dead (#55). The target 1:1 replacement of removed trees is therefore calculated to be 58.

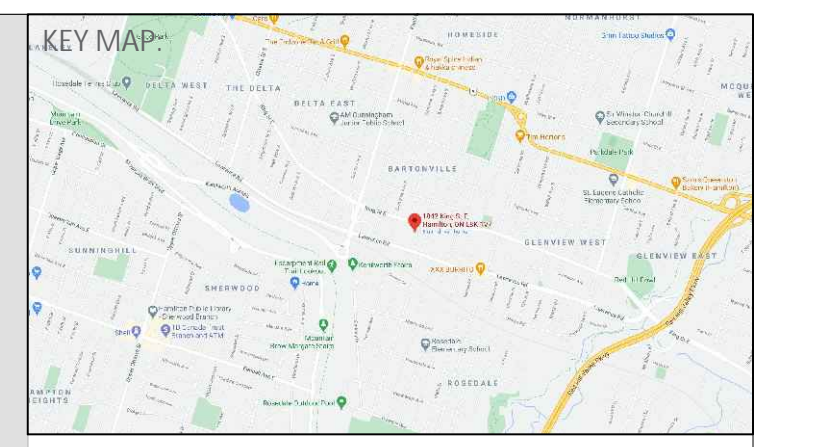

- LEGEND:**
- Existing Tree to be Removed
  - Existing Tree to be Retained
  - Tree Protection Fencing
  - Building Footprint
  - Existing Internal Roadway to be Removed

- Landscape Notes**
- Dimensions are shown in meters unless noted otherwise. Do not scale drawings.
  - Contractor to review layout on site with Landscape Architect prior to commencing work.
  - Contractor to verify grades and identify discrepancies prior to initiating work. Report any changes, discrepancies, or substitutions to the Landscape Architect for review prior to work.
  - It is the contractor's responsibility to locate and verify all existing utilities and services prior to construction.
  - Plant material support systems must be removed by the contractor at time of final acceptance. No extras will be paid to complete this work.
  - Contractor to provide minimum one (1) year warranty from date accepted on all work unless otherwise specified.
  - Grading and servicing shown is for information purposes. For grading and servicing information refer to engineering drawings.
  - For lighting information and power distribution refer to the electrical drawings.
  - Drawings are for construction only if Landscape Architect stamp is signed and dated by the Landscape Architect, and plans are approved by the Municipality.
  - Tree planting within the municipal right-of-way to be undertaken by the Municipality unless noted otherwise.
  - Unless otherwise specified all landscaped areas are to be sodded.
  - Unless otherwise specified, all undeveloped areas shall be undisturbed and kept free and clear of debris.
  - The Owner is to be aware of the Migratory Birds Convention Act, 1994. This Act is implemented by Environment Canada and the Owner is to make every effort to avoid removal of vegetation from the period of March 31<sup>st</sup> to August 31<sup>st</sup>.



**WHITEHOUSE URBAN DESIGN**  
LANDSCAPE ARCHITECTS & URBAN DESIGNERS

**REVISIONS / SUBMISSIONS**

NO.	DESCRIPTION	DATE:
5	For Zoning By-law Amendment	2022-02-04
4	For Zoning By-law Amendment	2022-01-31
3	For Zoning By-law Amendment	2021-09-29
2	For Zoning By-law Amendment	2021-04-08
1	For Client Review	2021-03-08

**CLIENT:** New Horizon Development Group

**PROJECT TITLE:** Pulse  
1842 King Street East  
Municipal File: FC-20-043

**SHEET TITLE:** Tree Protection Plan

**DWG No. L2** DRAWN BY: AP  
**SHEET No. 2 of 2** DESIGN BY: LWS and AP  
**PROJECT No: 008-20** CHECKED BY: LWS  
**SCALE:** As shown **NORTH ARROW:**

**Tree Inventory**

Tree #	Botanical Name	Common Name	DBH (cm)	Health Condition	Structural Condition	Fair-Good Health	Fair-Good Structure	Ownership	Comments	Recommendation: Rationale
1	Acer platanoides	Norway Maple	46	Fair	Fair	x	x	Private	Carling Roots	Remove: Tree within proposed building footprint.
2	Acer platanoides	Norway Maple	54	Fair	Fair	x	x	Private	Carling Roots	Remove: Tree within proposed building footprint.
3	Acer platanoides	Norway Maple	54	Fair	Fair	x	x	Private	Carling Roots	Remove: Tree within proposed building footprint.
4	Pinus nigra	Austrian Pine	54	Fair	Fair	x	x	Private	Dipodia Tip Blight	Remove: Tree within proposed building footprint.
5	Pinus nigra	Austrian Pine	54	Fair	Fair	x	x	Private	Dipodia Tip Blight	Remove: Tree within proposed building footprint.
6	Pinus nigra	Austrian Pine	46	Fair	Fair	x	x	Private	Dipodia Tip Blight	Remove: Tree within proposed building footprint.
7	Malus spp.	Crab Apple	26	Fair	Fair	x	x	Private		Remove: Tree within proposed building footprint.
8	Cedrela trichocarpa inermis	Honey Locust	32	Fair	Fair	x	x	Private		Remove: Tree within proposed building footprint.
9	Pinus abies	Norway Spruce	98	Fair	Fair	x	x	Private		Remove: Tree within proposed building footprint.
10	Pinus abies	Norway Spruce	40	Fair	Poor	x		Private	Trunk Growth Pattern curved But Corrected	Remove: Tree within proposed building footprint and in poor structure.
11	Pinus abies	Norway Spruce	40	Fair	Poor	x		Private	Trunk Growth Pattern curved But Corrected	Remove: Tree within proposed building footprint and in poor structure.
12	Pinus abies	Norway Spruce	42	Fair	Fair	x	x	Private		Remove: Tree within proposed building footprint.
13	Pinus abies	Norway Spruce	36	Fair	Fair	x	x	Private		Remove: Tree within proposed building footprint.
14	Acer platanoides	Norway Maple	40	Fair	Fair	x	x	Private		Remove: Tree within proposed building footprint.
15	Cedrela trichocarpa inermis	Honey Locust	26	Fair	Fair	x	x	Private		Remove: Tree within proposed building footprint.
16	Pinus abies	Norway Spruce	38	Fair	Fair	x	x	Private		Remove: Tree within proposed building footprint.
17	Betula pendula	Silver Birch	46	Fair	Fair	x	x	Private		Remove: Tree within proposed building footprint.
18	Betula pendula	Silver Birch	40	Fair	Fair	x	x	Private		Remove: Tree within proposed building footprint.
19	Pinus abies	Norway Spruce	24	Fair	Fair	x	x	Private		Remove: Tree within proposed building footprint.
20	Pinus nigra	Austrian Pine	48	Fair	Fair	x	x	Private	Dipodia Tip Blight	Remove: Tree within proposed building footprint.
21	Acer negundo	Boxelder	50	Fair	Fair	x	x	Private		Remove: Tree within proposed building footprint.
22	Cedrela trichocarpa inermis	Honey Locust	44	Fair	Fair	x	x	Private		Remove: Tree within proposed building footprint.
23	Acer negundo	Manitoba Maple	10	Fair	Poor	x		Private	Self Seeded	Remove: Tree within proposed retaining wall.
24	Acer negundo	Manitoba Maple	10	Fair	Poor	x		Private	Self Seeded	Remove: Tree within proposed retaining wall.
25	Acer negundo	Manitoba Maple	10	Fair	Poor	x		Private	Self Seeded	Remove: Tree within proposed retaining wall.
26	Acer negundo	Manitoba Maple	10	Fair	Poor	x		Private Adjacent Property	Self Seeded	Retain: Retaining wall to replace current condition.
27	Malus alba	Malus White	16	Fair	Poor	x		Private Adjacent Property	Self Seeded	Retain: Retaining wall to replace current condition.
28	Pinus abies	Norway Spruce	16	Fair	Poor	x		Private Adjacent Property	Self Seeded	Retain: Retaining wall to replace current condition.
29	Acer negundo	Manitoba Maple	40	Fair	Poor	x		Private Adjacent Property	Self Seeded	Retain.
30	Pinus nigra	Austrian Pine	10	Poor	Fair	x		Private Adjacent Property	Showing Decline	Retain.
31	Cedrela trichocarpa inermis	Honey Locust	52	Fair	Fair	x		Private		Remove: Tree within proposed retaining wall.
32	Juniperus nigra	Black Walnut	80	Fair	Fair	x	x	Shared at Property Line	Fenced within Adjacent Property	Retain: Unless removed it is proposed Adjacent Owner. See TYP Note (2)
33	Pinus nigra	Austrian Pine	40	Fair	Fair	x	x	Private		Remove: Tree within proposed underground parking.
34	Cedrela trichocarpa inermis	Honey Locust	26	Fair	Fair	x	x	Private		Remove: Tree within proposed underground parking.

Tree #	Botanical Name	Common Name	DBH (cm)	Health Condition	Structural Condition	Fair-Good Health	Fair-Good Structure	Ownership	Comments	Recommendation: Rationale
35	Tilia cordata	Little Leaf Linden	52	Fair	Fair	x	x	Private		Remove: Dipodia within proposed underground parking.
36	Cedrela trichocarpa inermis	Honey Locust	44	Fair	Fair	x	x	Private		Remove: Dipodia within proposed underground parking.
37	Cedrela trichocarpa inermis	Honey Locust	52	Fair	Fair	x	x	Private		Remove: Dipodia within proposed underground parking.
38	Pinus abies	Norway Spruce	56	Fair	Fair	x	x	Private		Remove: Dipodia within proposed underground parking.
39	Pinus abies	Norway Spruce	64	Fair	Fair	x	x	Private		Remove: Dipodia within proposed underground parking.
40	Prunus spp.	Cherry	40	Fair	Poor	x		Private	Very Unique But Poor Trunk Structure	Remove: Dipodia within proposed underground parking, and has poor structure.
41	Pinus nigra	Austrian Pine	48	Fair	Fair	x	x	Private		Remove: Tree within proposed building footprint.
42	Pinus nigra	Austrian Pine	40	Fair	Fair	x	x	Private		Remove: Tree within area of significant grading.
43	Acer negundo	Manitoba Maple	30	Fair	Poor	x		Private	Growing Through Fence	Retain.
44	Pinus nigra	Austrian Pine	28	Fair	Fair	x	x	Private		Remove: Within grading of proposed swale.
45	Pinus nigra	Austrian Pine	48	Fair	Fair	x	x	Private		Remove: Within grading of proposed swale.
46	Pinus nigra	Austrian Pine	42	Fair	Fair	x	x	Private		Remove: Within grading of proposed swale.
47	Pinus nigra	Austrian Pine	42	Fair	Fair	x	x	Private		Remove: Within grading of proposed swale.
48	Pinus nigra	Austrian Pine	40	Fair	Fair	x	x	Private		Remove: Within grading of proposed swale.
49	Pinus nigra	Austrian Pine	40	Fair	Fair	x	x	Private		Remove: Within grading of proposed swale.
50	Pinus nigra	Austrian Pine	44	Fair	Fair	x	x	Private		Remove: Within grading of proposed swale.
51	Pinus nigra	Austrian Pine	42	Fair	Fair	x	x	Private		Remove: Within grading of proposed swale.
52	Pinus nigra	Austrian Pine	50	Fair	Fair	x	x	Private		Remove: Within grading of proposed swale.
53	Pinus nigra	Austrian Pine	38	Fair	Fair	x	x	Private		Remove: Within grading of proposed swale.
54	Acer negundo	Manitoba Maple	16	Fair	Poor	x		Private Adjacent Property	Growing In Fence	Retain.
55	Pinus nigra	Austrian Pine	24	Dead	Poor			Private	Dead	Remove: Dead Tree
56	Pinus nigra	Austrian Pine	50	Fair	Fair	x	x	Private		Remove: Within grading of proposed swale.
57	Pinus nigra	Austrian Pine	48	Fair	Fair	x	x	Private		Remove: Within grading of proposed swale.
58	Pinus nigra	Austrian Pine	46	Fair	Fair	x	x	Private		Remove: Within grading of proposed swale.
59	Pinus nigra	Austrian Pine	46	Fair	Fair	x	x	Private		Remove: Within grading of proposed swale.
60	Pinus nigra	Austrian Pine	36	Fair	Fair	x	x	Private		Remove: Within grading of proposed swale.
61	Pinus nigra	Austrian Pine	68	Fair	Fair	x	x	Private		Remove: Within grading of proposed swale.
62	Pinus nigra	Austrian Pine	36	Fair	Fair	x	x	Private		Remove: Within grading of proposed swale.
63	Pinus nigra	Austrian Pine	40	Fair	Fair	x	x	Private		Remove: Within grading of proposed swale.
64	Pinus nigra	Austrian Pine	44	Fair	Fair	x	x	Private		Remove: Within grading of proposed swale.
65	Malus alba	Malus White	86	Fair	Poor	x		Shared	Growing Over Top Rail Of Chain Link Fence	Remove: Prior to removal of this fence tree will appear to adjacent street owner.
66	Pinus nigra	Austrian Pine	36	Fair	Fair	x	x	Private		Remove: Within footprint of accessibility ramp.
67	Juniperus nigra	Black Walnut	52	Fair	Fair	x	x	Private		Remove: Within distance of proposed catch basin.