

BRANTHAVEN MOUNT HOPE INC.
 7200 HWY. 10
 HAMILTON, ONTARIO

MOUNT HOPE DEVELOPMENT
 80 MARION ST. & 3306 HOMESTEAD DR.
 HAMILTON, ONTARIO

S. LEBELYN & ASSOCIATES LIMITED
 CONSULTING ENGINEERS
 1000 GERRARD ST. E. UNIT 101
 SCARBOROUGH, ONTARIO M1B 4Y7
 TEL: (416) 291-1111
 FAX: (416) 291-1112
 WWW: www.lebelyn.com

APPROVALS

NO.	DATE	BY	REVISIONS
1	MAY/15/18	BB	REVISED PER CITY COMMENTS

DESIGN: BB
 CHECKED: BB
 DRAWN: BB

DATE: Nov. 1, 17
 SCALE: 1:100
 PROJECT NO.: 16108
 SHEET NO.: C101

BRANTHAVEN MOUNT HOPE INC.
 7200 HWY. 10
 HAMILTON, ONTARIO

MOUNT HOPE DEVELOPMENT
 80 MARION ST. & 3306 HOMESTEAD DR.
 HAMILTON, ONTARIO

S. LEBELYN & ASSOCIATES LIMITED
 CONSULTING ENGINEERS
 1000 GERRARD ST. E. UNIT 101
 SCARBOROUGH, ONTARIO M1B 4Y7
 TEL: (416) 291-1111
 FAX: (416) 291-1112
 WWW: www.lebelyn.com

APPROVALS

NO.	DATE	BY	REVISIONS
1	MAY/15/18	BB	REVISED PER CITY COMMENTS

DESIGN: BB
 CHECKED: BB
 DRAWN: BB

MAINTAIN OVERLAND FLOW FROM THE EXTERNAL LOTS (UNDEVELOPED LOTS) THROUGH THE ROAD TO THE MAIN OVERLAND FLOW PIPE AND ALL DOWNSTREAM SEWERS ARE ASSIGNED TO THE 100-YEAR FLOOD RETURN PERIOD.

MAINTAIN THE MAJOR OVERLAND FLOW FOR THE REAR LOTS OF THE DEVELOPMENT TO MAINTAIN THE MAJOR OVERLAND FLOW A TOTAL CAPTURE STORM PIPE (CSP) FOR THE 100-YEAR FLOOD RETURN PERIOD.

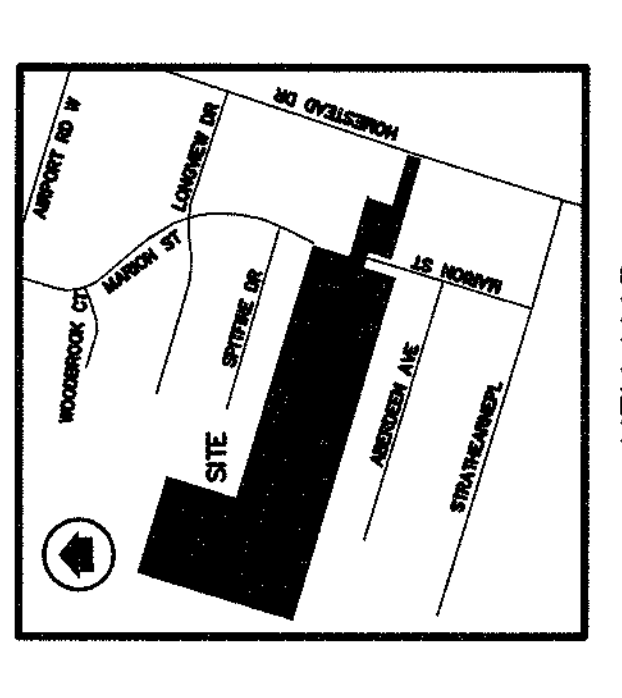

- LEGEND:**
- EXISTING GROUND ELEVATION
 - PROPOSED GROUND ELEVATION
 - PROPOSED SWALE ELEVATION
 - PROPOSED ELEVATION TO MATCH EXISTING
 - PROPOSED ELEVATION BY OTHERS
 - PROPOSED DIRECTION OF SHEET FLOW
 - EXISTING CATCHBASIN
 - EXISTING STORM/SANITARY MANHOLE
 - PROPOSED CATCHBASIN/REAR LOT CATCHBASIN
 - PROPOSED STORM/SANITARY MANHOLE
 - PROPOSED CATCHBASIN MANHOLE
 - PROPOSED EMERGENCY OVERLAND FLOW ROUTE
 - PROPOSED SLOTTED CONTROL FENCE
 - PROPOSED CATCHBASIN SET BACK

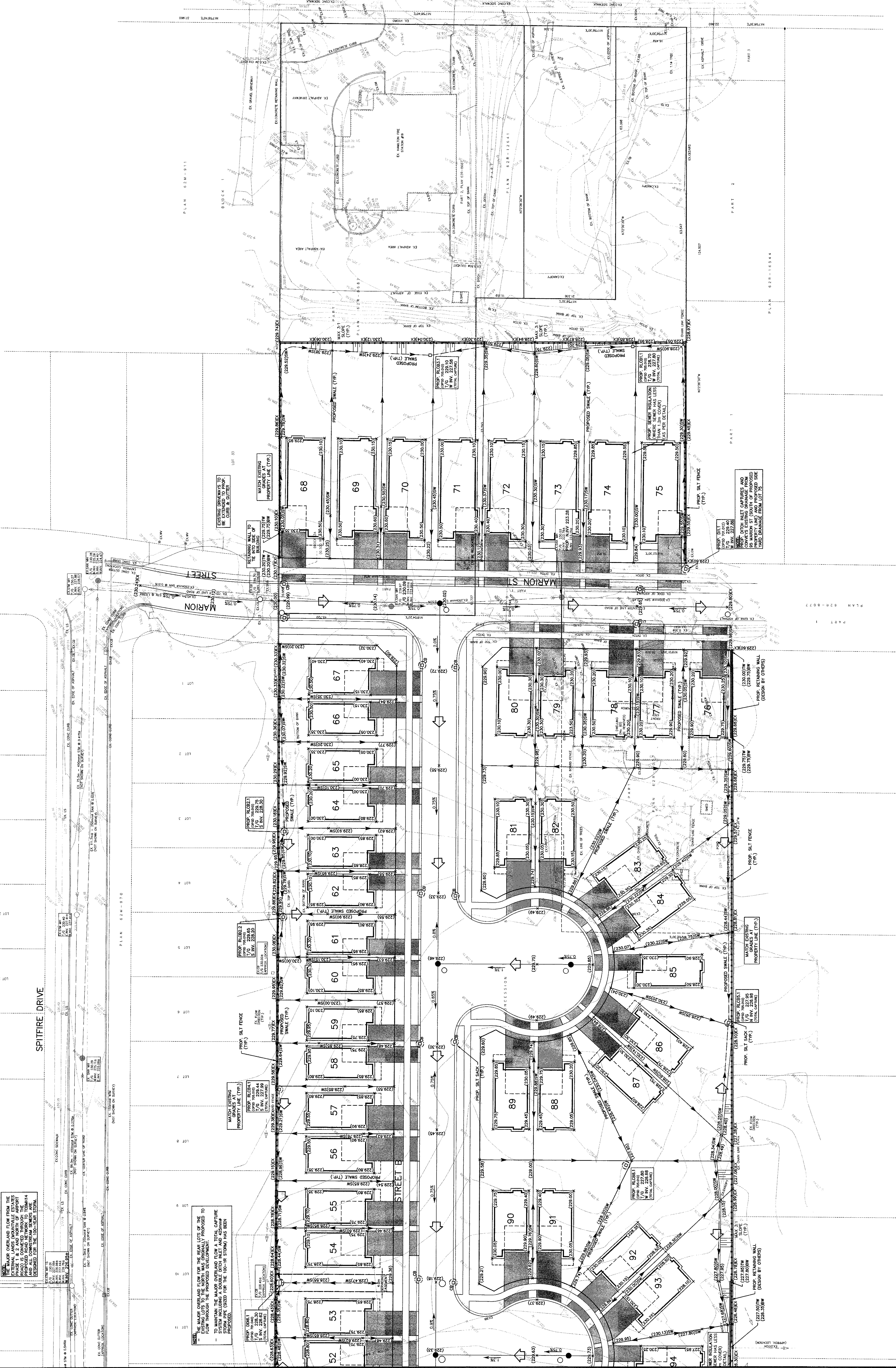

BENCH MARK NOTE:
 MOUNT HOPE SCHOOL, ALONG AIRPORT ROAD, 10.0 METERS NORTH OF THE PROPOSED DEVELOPMENT, IS A BENCH MARK WITH AN ELEVATION OF 233.03m. THE BENCH MARK IS A CONCRETE PILE WITH A DIAMETER OF 100mm AND A LENGTH OF 1.0m. THE BENCH MARK IS TO BE USED FOR THE 100-YEAR FLOOD RETURN PERIOD.

BRANTHAVEN MOUNT HOPE INC.
 7200 SHEPPARD AVENUE EAST
 SCARBOROUGH, ONTARIO

PROJECT NAME:
 MOUNT HOPE DEVELOPMENT
 80 MARION ST & 306 HOMESTEAD DR
 MARKHAM, ONTARIO

PROJECT NO.: 18108
DATE: C102
SCALE: 1:300

APPROVALS

NO.	DATE	BY	REVISIONS
DESIGN	BB	CHK'D	SP
DRAWN	BB	CHK'D	SP

DATE: Nov. 1, 17

S. LEBELLYN & ASSOCIATES LIMITED
 CONSULTING ENGINEERS
 1400 SHEPPARD AVENUE EAST
 SUITE 1000
 MARKHAM, ONTARIO L3R 9V4
 TEL: (905) 477-8877
 FAX: (905) 477-8878
 WWW: SLEB.COM

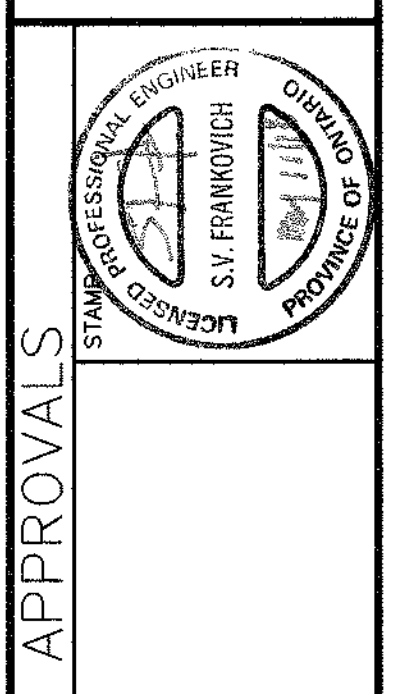

L.	MAJ/YS	BB	REVISIONS PER CITY COMMENTS
NO.	DATE	BY	REVISIONS

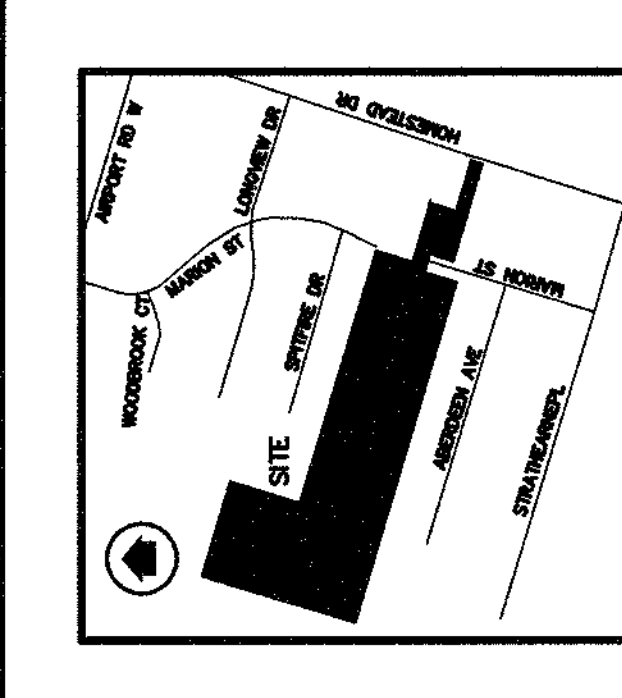

- LEGEND:**
- EXISTING CATCHBASIN
 - EXISTING STORM/SANITARY MANHOLE
 - PROPOSED CATCHBASIN/REAR LOT CATCHBASIN
 - PROPOSED STORM/SANITARY MANHOLE
 - PROPOSED HYDRANT
 - PROPOSED DATE VALVE
 - PROPOSED DOUBLE CATCHBASIN



BRANTHAVEN MOUNT HOPE INC.
 7200 HAMILTON ST.
 HAMILTON, ONTARIO

PROJECT NAME:
 MOUNT HOPE DEVELOPMENT
 80 MARION ST. & 3306 HOMESTEAD DR.
 HAMILTON, ONTARIO

CONSULTING ENGINEER:
 S. LEBELMAN & ASSOCIATES LIMITED
 CONSULTING ENGINEERS
 3228 South Service Road, Suite 100 East Wap. Burlington, Ont. L7R 3A8
 TEL: (905) 637-6979
 FAX: (905) 637-6978
 www.lebelman.ca

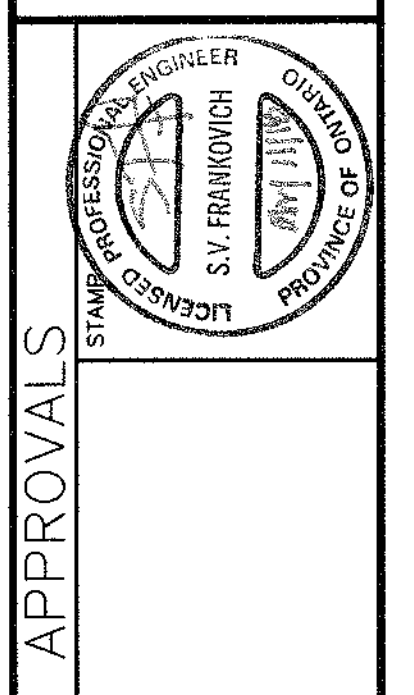

APPROVALS

NO.	DATE	BY	REVISIONS
DESIGN	BB	CHK'D	DATE
DRAWN	BB	CHK'D	DATE

PROJECT No.: 17065
SCALE: 1:300
DATE: Nov. 1, 17

FILE: SERVING PLAN 1 OF 2
PROJECT No.: 17065
SCALE: 1:300
DATE: Nov. 1, 17

1:000

SCALE

PROJECT No. 17065

FORMER No. DAP-2

DATE

REVISED PER CITY COMMENTS

REVISIONS

NO. DATE BY

DESIGN BB

CHK'D BB

DATE

Oct. 25, 17

STATION

APPROVALS

BRANTHAVEN MOUNT HOPE INC.

700 OVAL COURT

BURLINGTON, ONTARIO

MOUNT HOPE DEVELOPMENT

80 MARION ST & 306 HOMESTEAD DR

HAMILTON, ONTARIO

FILE

STORM DRAINAGE

AREA PLAN

2 OF 2

1:400

SCALE

PROJECT No. 17065

FORMER No. DAP-2

DATE

REVISED PER CITY COMMENTS

REVISIONS

NO. DATE BY

DESIGN BB

CHK'D BB

DATE

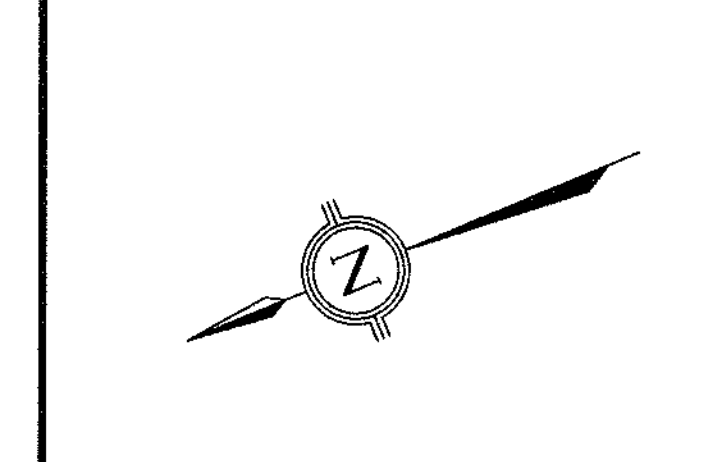
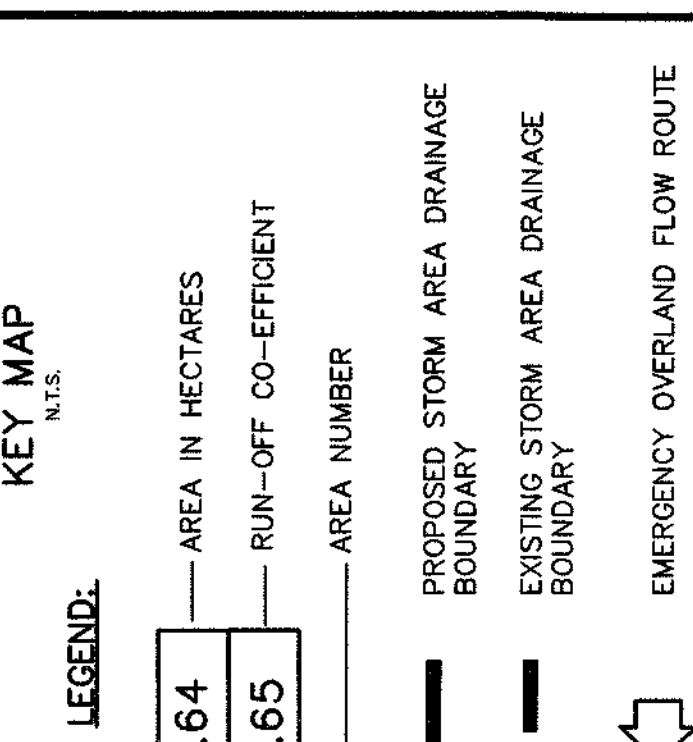
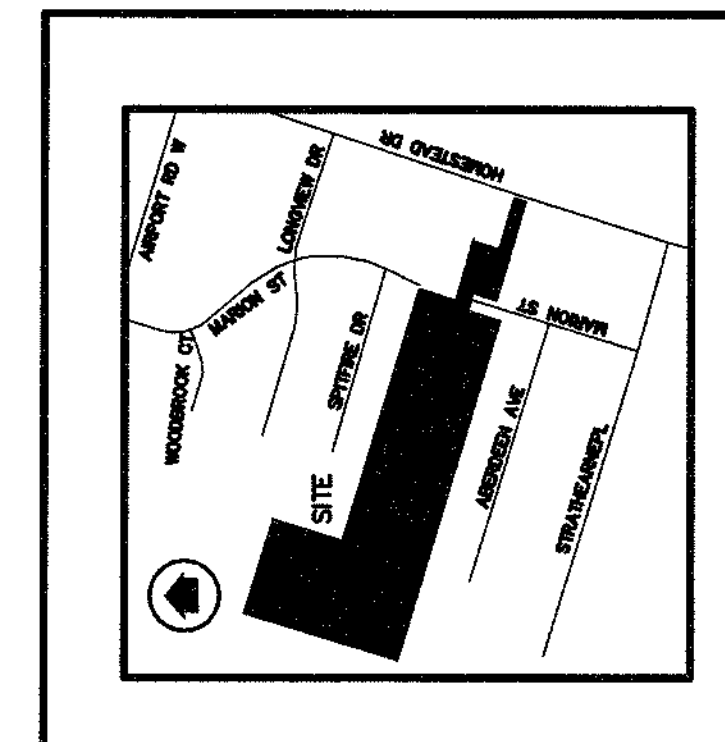

MOUNT HOPE SCHOOL DRAINAGE CUT-OFF SWALE & DITCH INLET (DD9)

EX4A 2.30
0.38

MOUNT HOPE SCHOOL DRAINAGE CUT-OFF SWALE & DITCH INLET (DD9)

EX4A 2.30
0.38

MOUNT HOPE SCHOOL DRAINAGE CUT-OFF SWALE & DITCH INLET (DD9)

EX4A 2.30
0.38

MOUNT HOPE SCHOOL DRAINAGE CUT-OFF SWALE & DITCH INLET (DD9)

EX4A 2.30
0.38

MOUNT HOPE SCHOOL DRAINAGE CUT-OFF SWALE & DITCH INLET (DD9)

EX4A 2.30
0.38

MOUNT HOPE SCHOOL DRAINAGE CUT-OFF SWALE & DITCH INLET (DD9)

EX4A 2.30
0.38

MOUNT HOPE SCHOOL DRAINAGE CUT-OFF SWALE & DITCH INLET (DD9)

EX4A 2.30
0.38

MOUNT HOPE SCHOOL DRAINAGE CUT-OFF SWALE & DITCH INLET (DD9)

EX4A 2.30
0.38

MOUNT HOPE SCHOOL DRAINAGE CUT-OFF SWALE & DITCH INLET (DD9)

EX4A 2.30
0.38

MOUNT HOPE SCHOOL DRAINAGE CUT-OFF SWALE & DITCH INLET (DD9)

EX4A 2.30
0.38

MOUNT HOPE SCHOOL DRAINAGE CUT-OFF SWALE & DITCH INLET (DD9)

EX4A 2.30
0.38

MOUNT HOPE SCHOOL DRAINAGE CUT-OFF SWALE & DITCH INLET (DD9)

EX4A 2.30
0.38

MOUNT HOPE SCHOOL DRAINAGE CUT-OFF SWALE & DITCH INLET (DD9)

EX4A 2.30
0.38

MOUNT HOPE SCHOOL DRAINAGE CUT-OFF SWALE & DITCH INLET (DD9)

EX4A 2.30
0.38

MOUNT HOPE SCHOOL DRAINAGE CUT-OFF SWALE & DITCH INLET (DD9)

EX4A 2.30
0.38

MOUNT HOPE SCHOOL DRAINAGE CUT-OFF SWALE & DITCH INLET (DD9)

EX4A 2.30
0.38

MOUNT HOPE SCHOOL DRAINAGE CUT-OFF SWALE & DITCH INLET (DD9)

EX4A 2.30
0.38

MOUNT HOPE SCHOOL DRAINAGE CUT-OFF SWALE & DITCH INLET (DD9)

EX4A 2.30
0.38

MOUNT HOPE SCHOOL DRAINAGE CUT-OFF SWALE & DITCH INLET (DD9)

EX4A 2.30
0.38

MOUNT HOPE SCHOOL DRAINAGE CUT-OFF SWALE & DITCH INLET (DD9)

EX4A 2.30
0.38

MOUNT HOPE SCHOOL DRAINAGE CUT-OFF SWALE & DITCH INLET (DD9)

EX4A 2.30
0.38

MOUNT HOPE SCHOOL DRAINAGE CUT-OFF SWALE & DITCH INLET (DD9)

EX4A 2.30
0.38

MOUNT HOPE SCHOOL DRAINAGE CUT-OFF SWALE & DITCH INLET (DD9)

EX4A 2.30
0.38

MOUNT HOPE SCHOOL DRAINAGE CUT-OFF SWALE & DITCH INLET (DD9)

EX4A 2.30
0.38

MOUNT HOPE SCHOOL DRAINAGE CUT-OFF SWALE & DITCH INLET (DD9)

EX4A 2.30
0.38

MOUNT HOPE SCHOOL DRAINAGE CUT-OFF SWALE & DITCH INLET (DD9)

EX4A 2.30
0.38

MOUNT HOPE SCHOOL DRAINAGE CUT-OFF SWALE & DITCH INLET (DD9)

EX4A 2.30
0.38

MOUNT HOPE SCHOOL DRAINAGE CUT-OFF SWALE & DITCH INLET (DD9)

EX4A 2.30
0.38

MOUNT HOPE SCHOOL DRAINAGE CUT-OFF SWALE & DITCH INLET (DD9)

EX4A 2.30
0.38

MOUNT HOPE SCHOOL DRAINAGE CUT-OFF SWALE & DITCH INLET (DD9)

EX4A 2.30
0.38

MOUNT HOPE SCHOOL DRAINAGE CUT-OFF SWALE & DITCH INLET (DD9)

EX4A 2.30
0.38

MOUNT HOPE SCHOOL DRAINAGE CUT-OFF SWALE & DITCH INLET (DD9)

EX4A 2.30
0.38

MOUNT HOPE SCHOOL DRAINAGE CUT-OFF SWALE & DITCH INLET (DD9)

EX4A 2.30
0.38

MOUNT HOPE SCHOOL DRAINAGE CUT-OFF SWALE & DITCH INLET (DD9)

EX4A 2.30
0.38

MOUNT HOPE SCHOOL DRAINAGE CUT-OFF SWALE & DITCH INLET (DD9)

EX4A 2.30
0.38

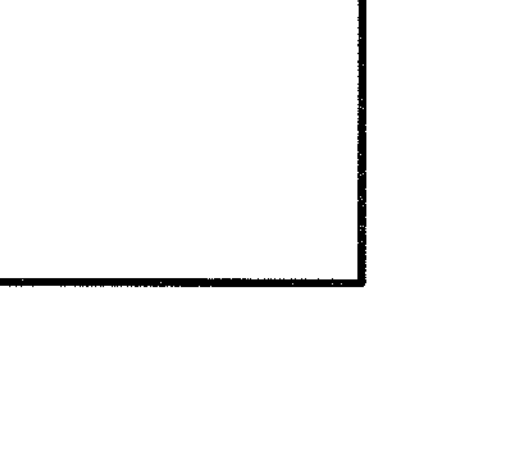
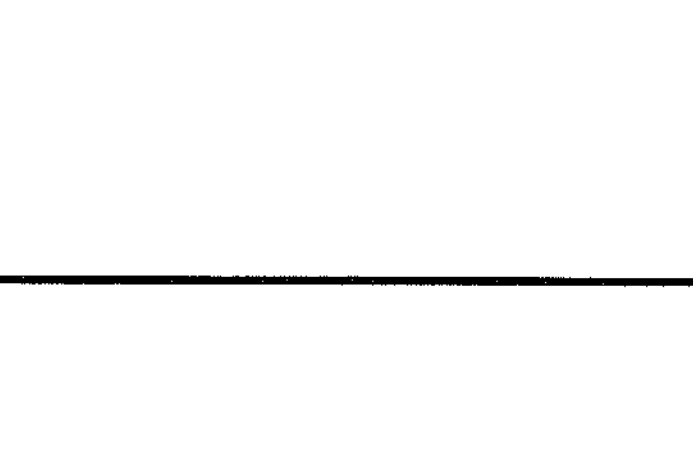
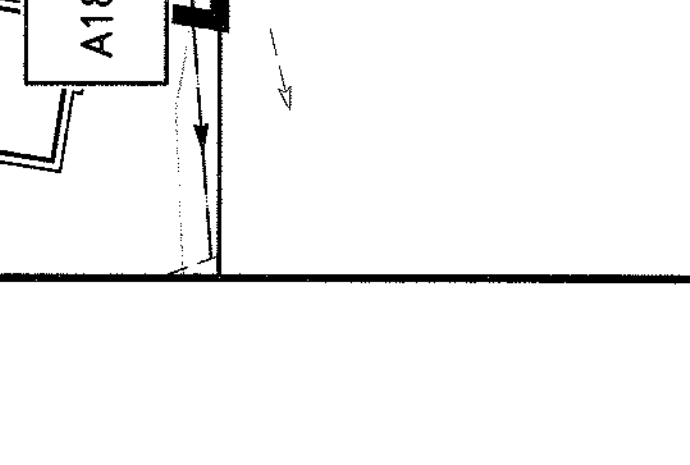
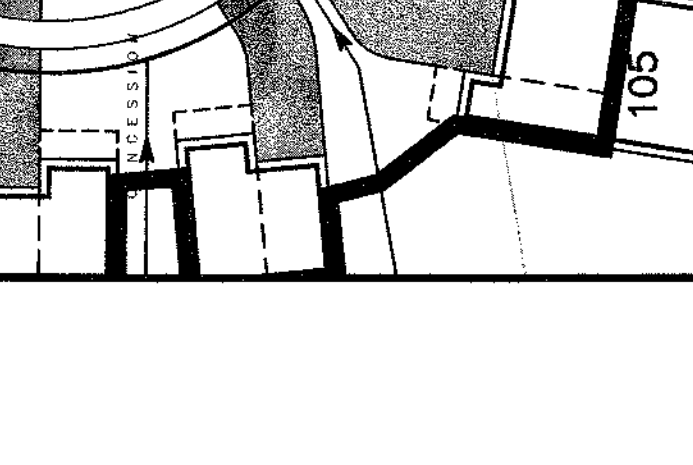
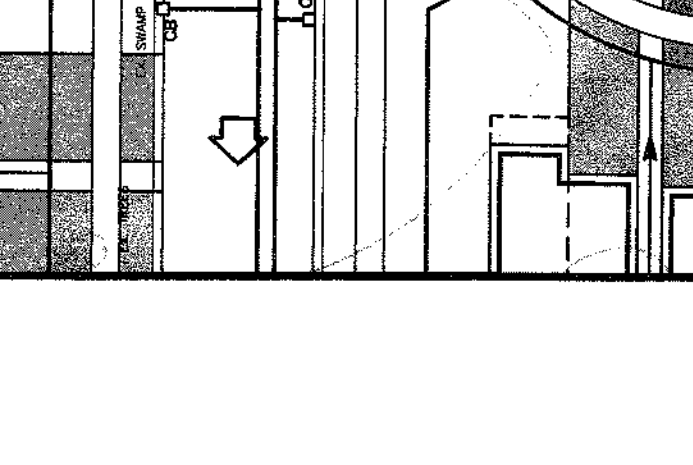
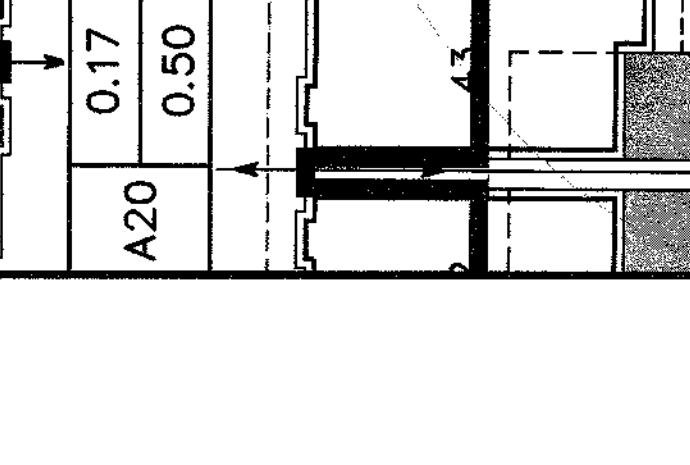
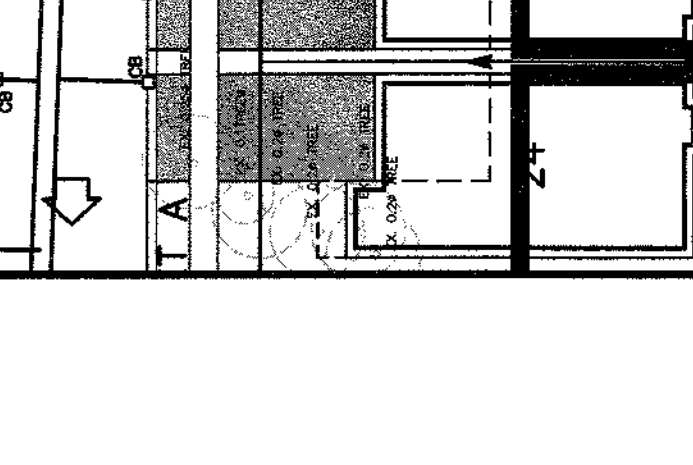
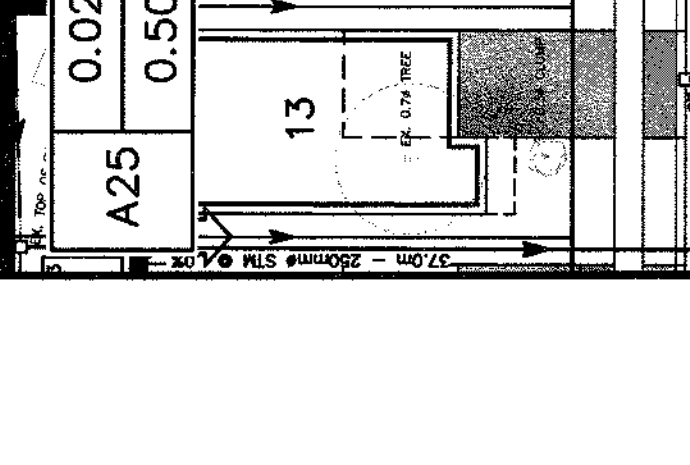
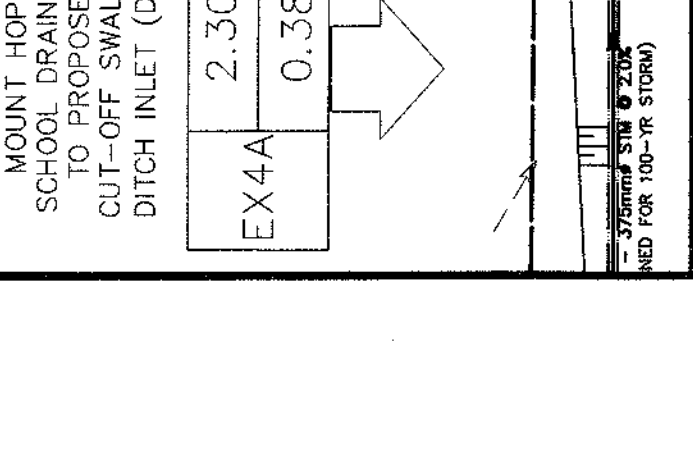
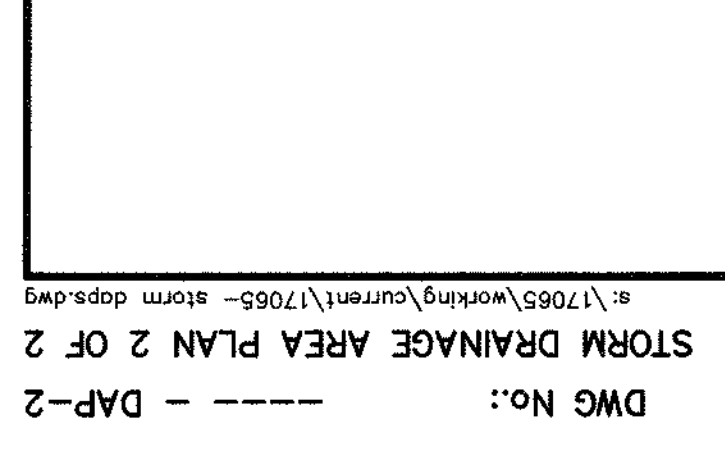
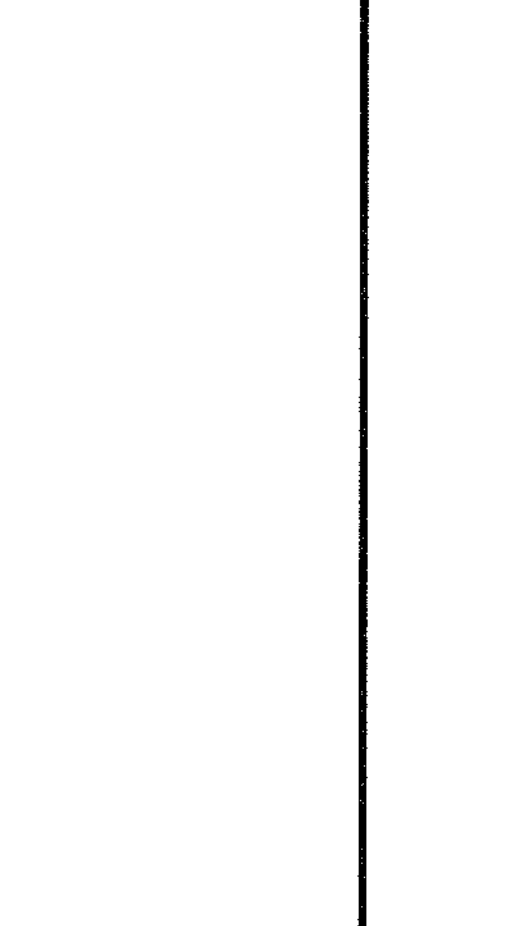
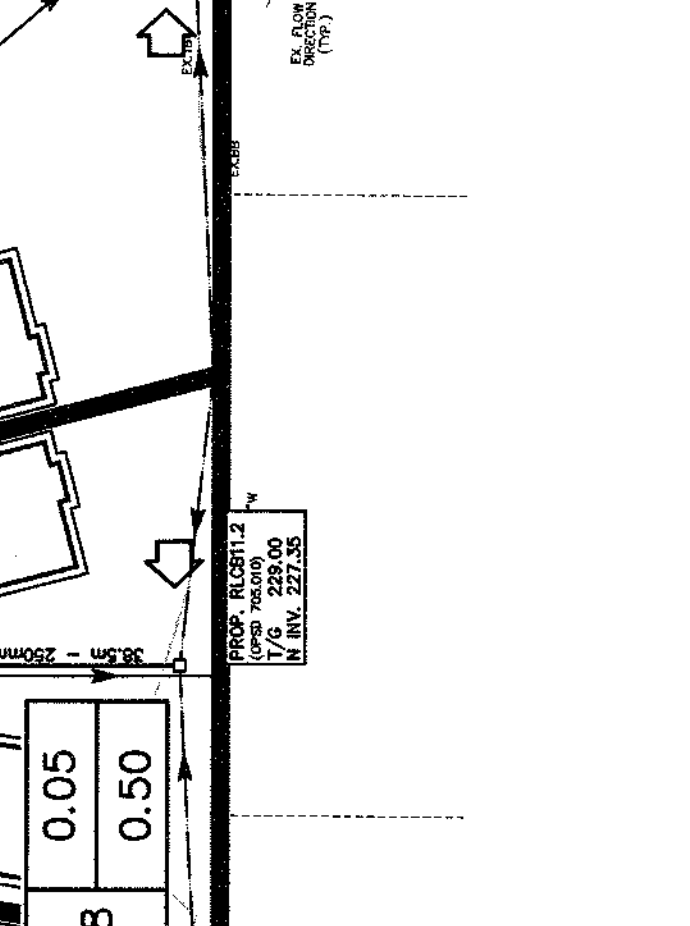
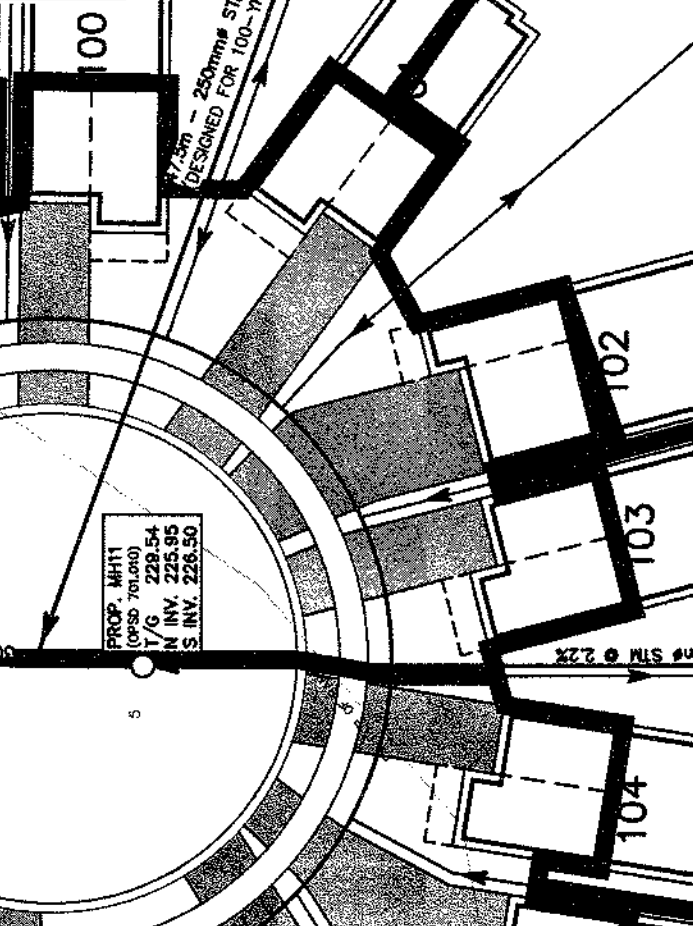
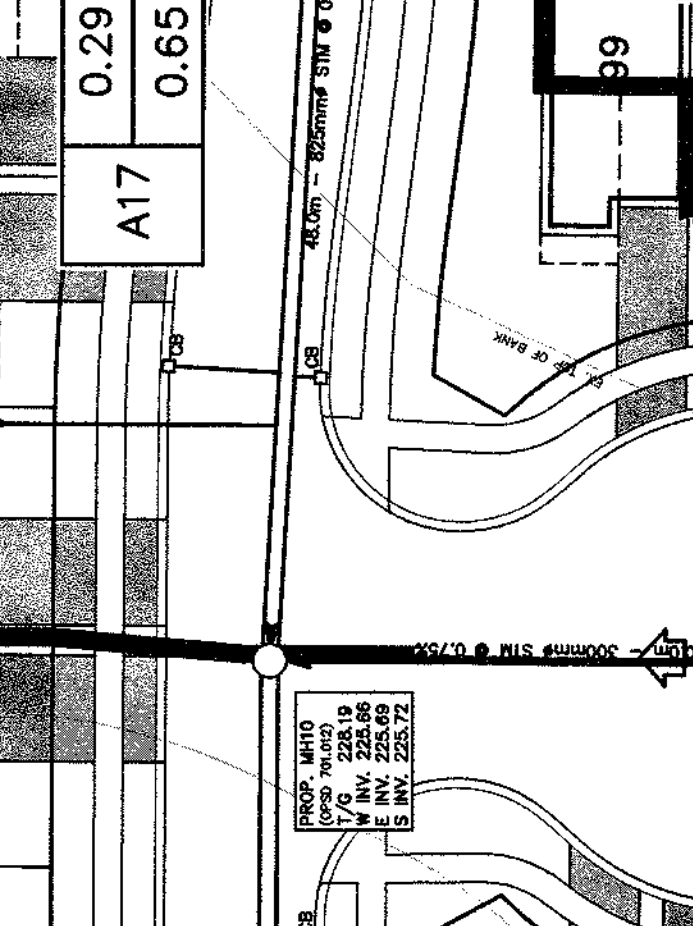
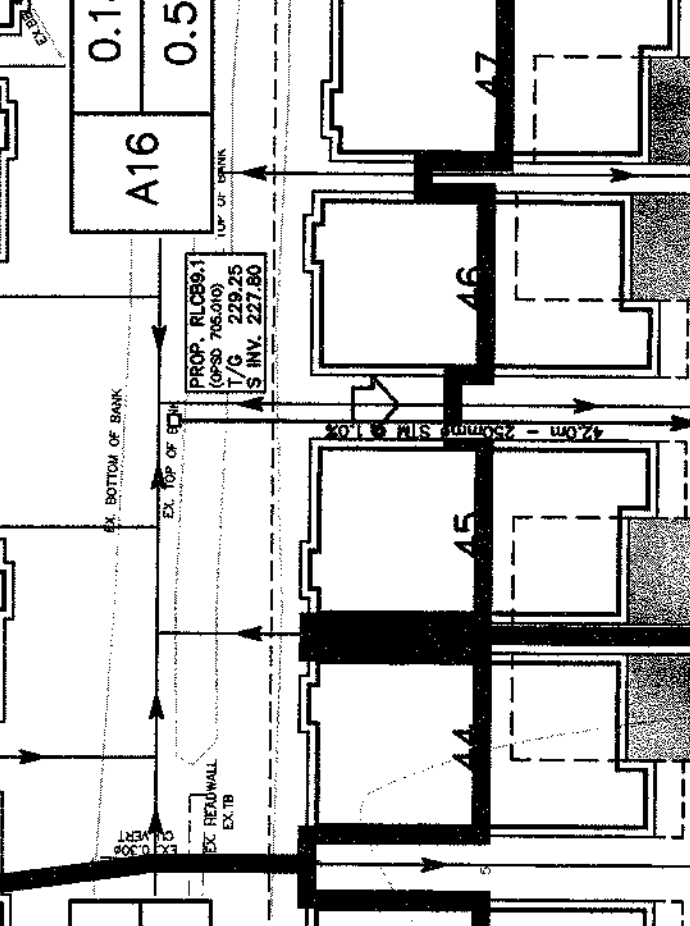
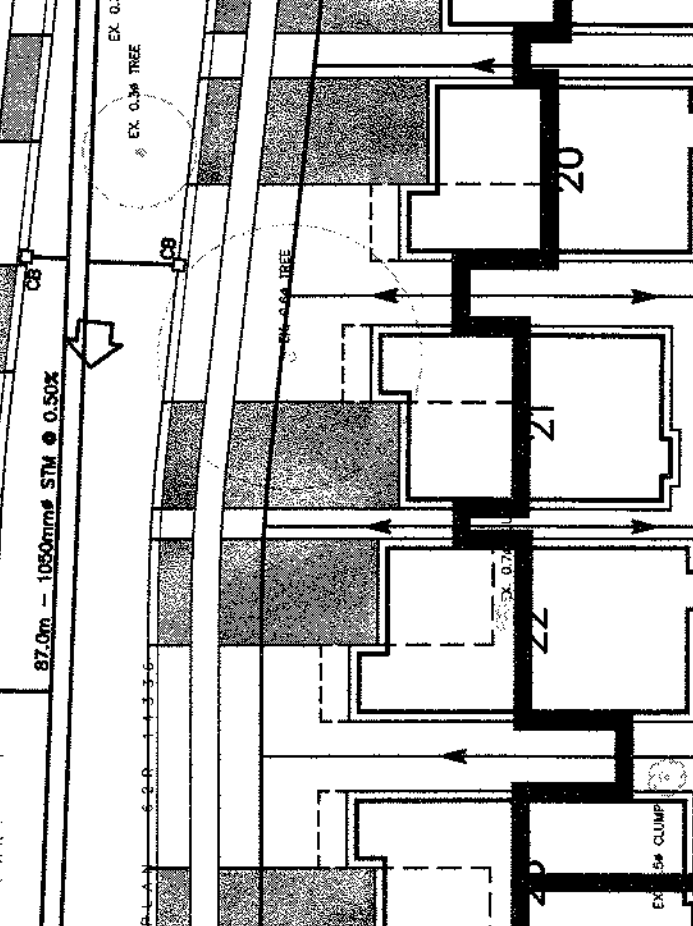
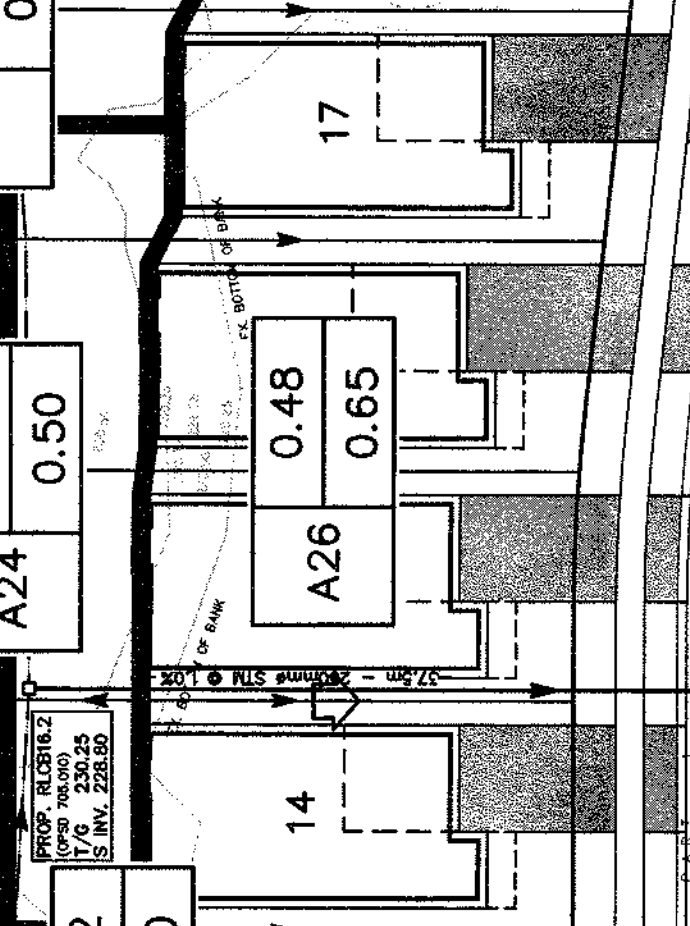
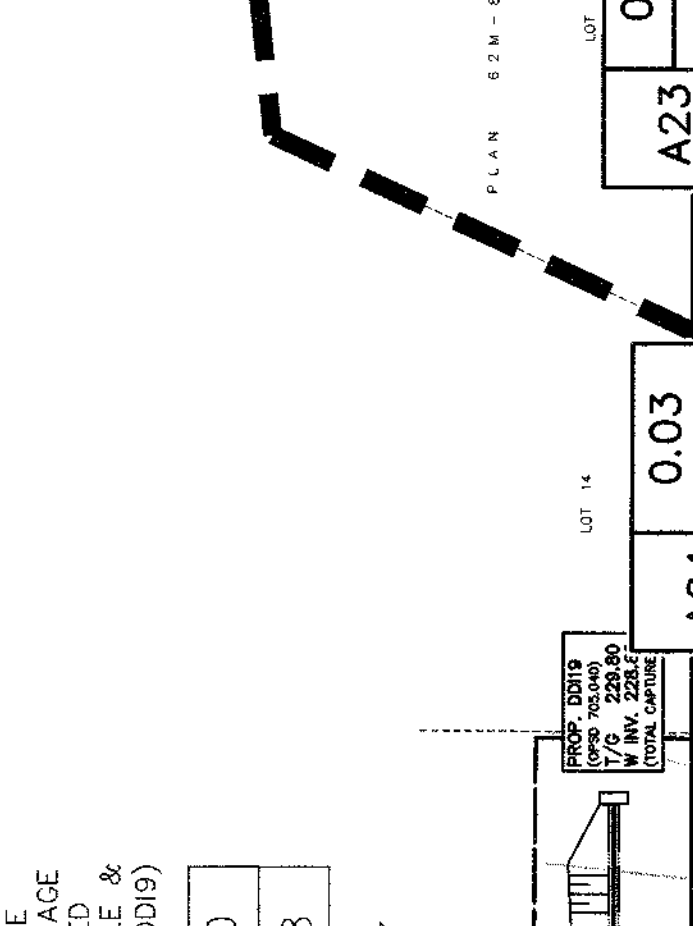
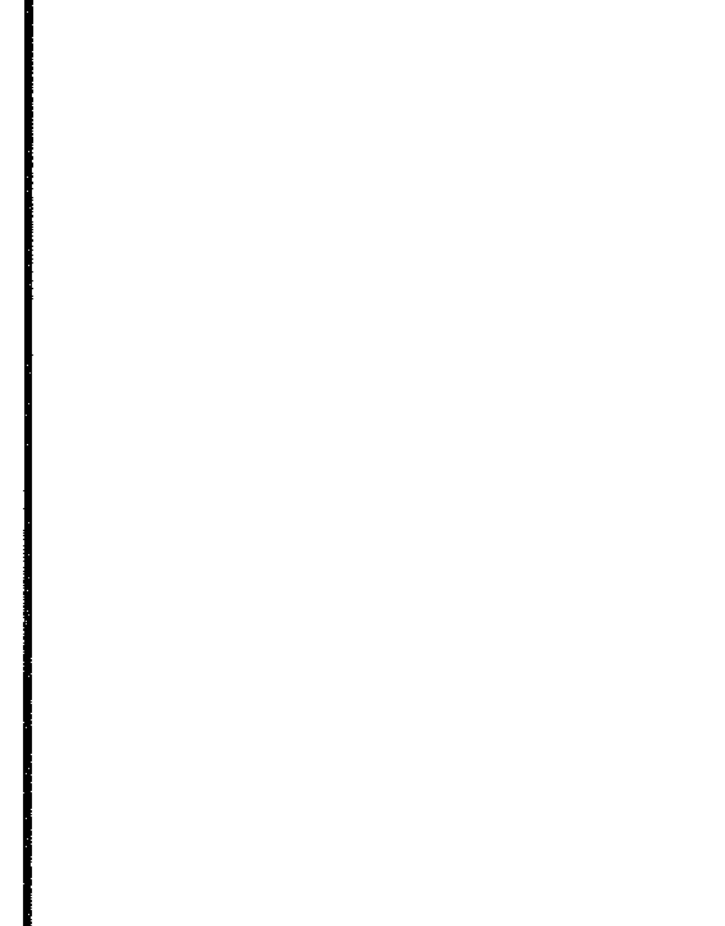
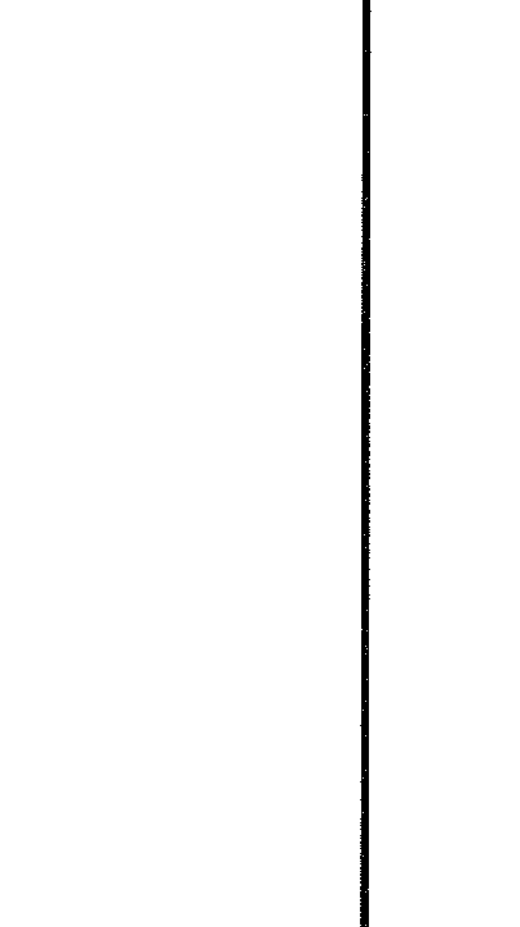
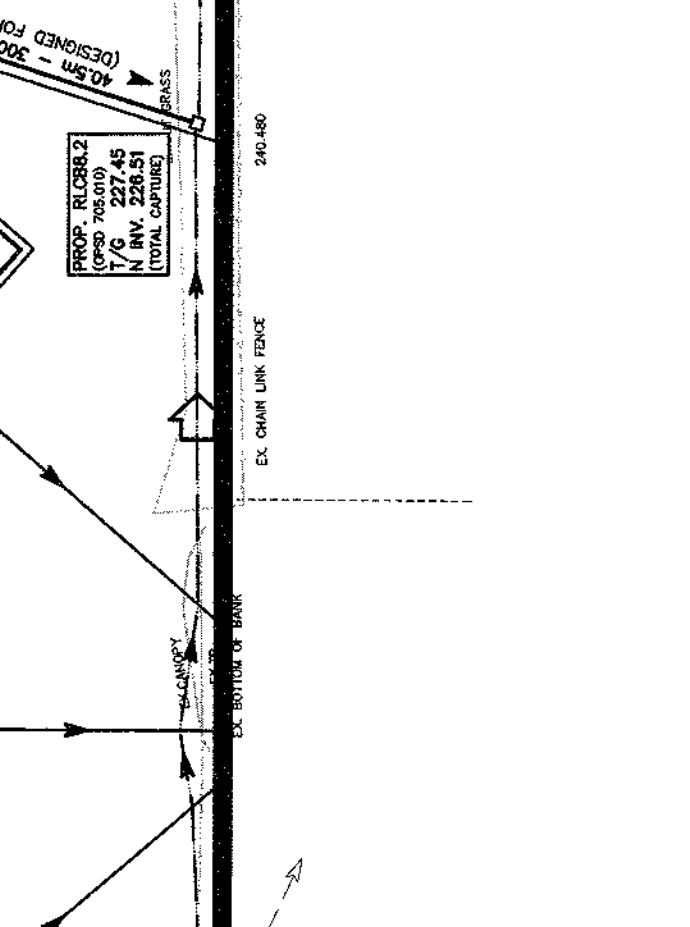
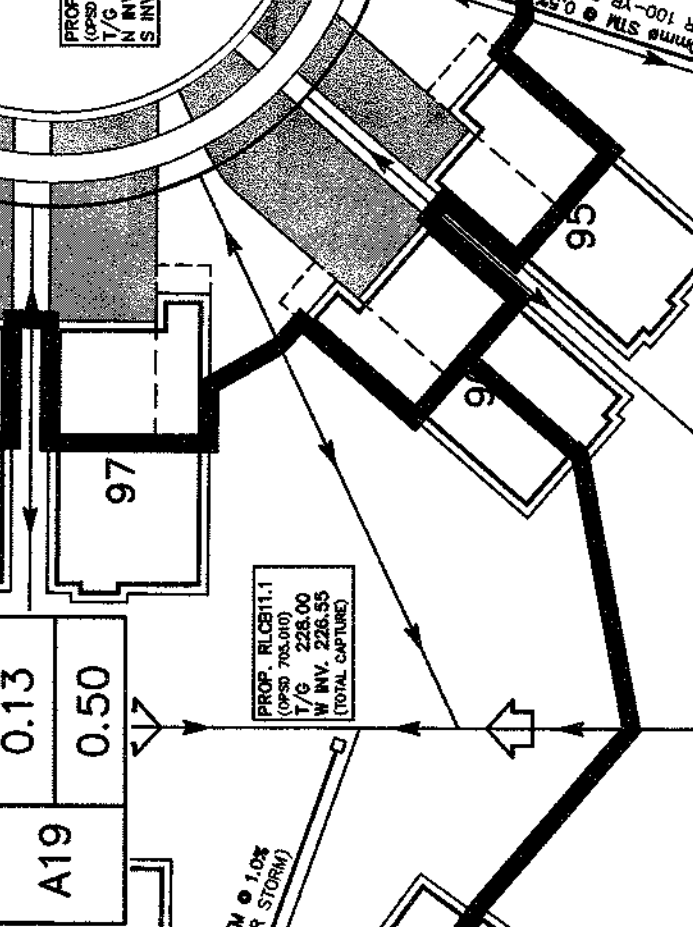
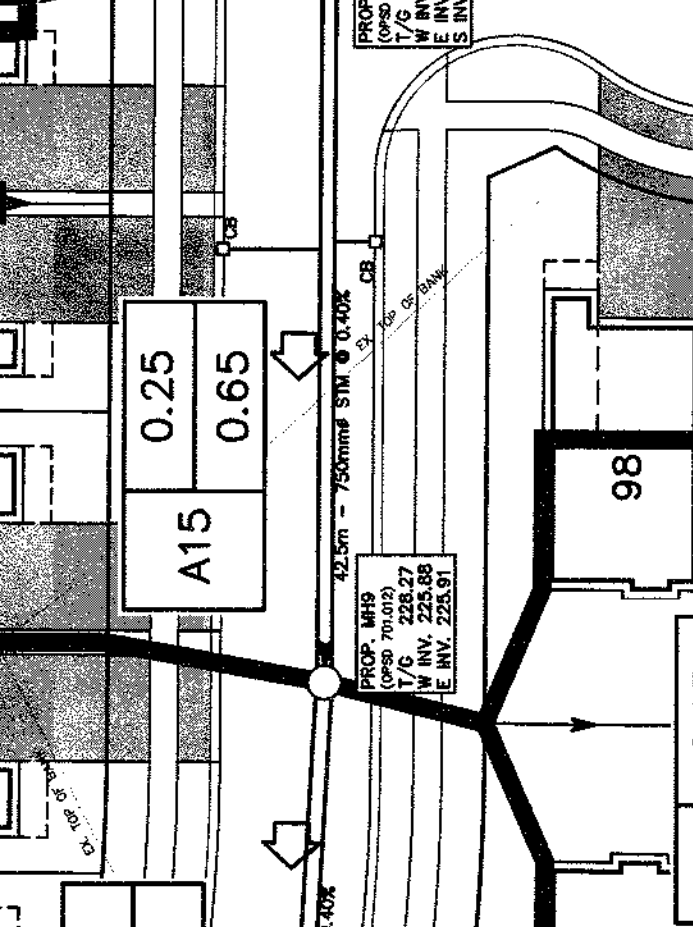
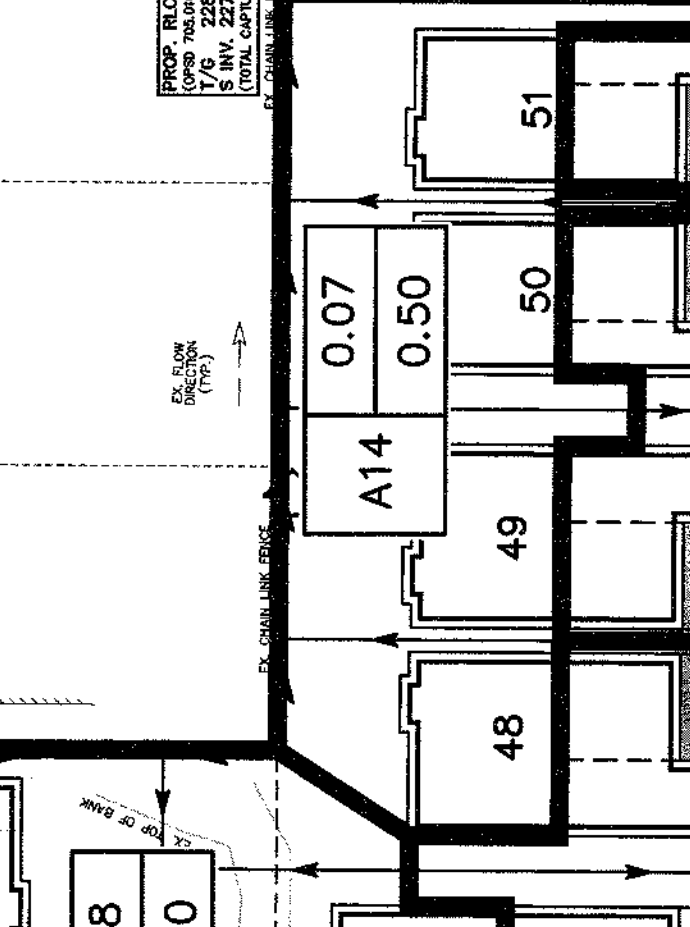
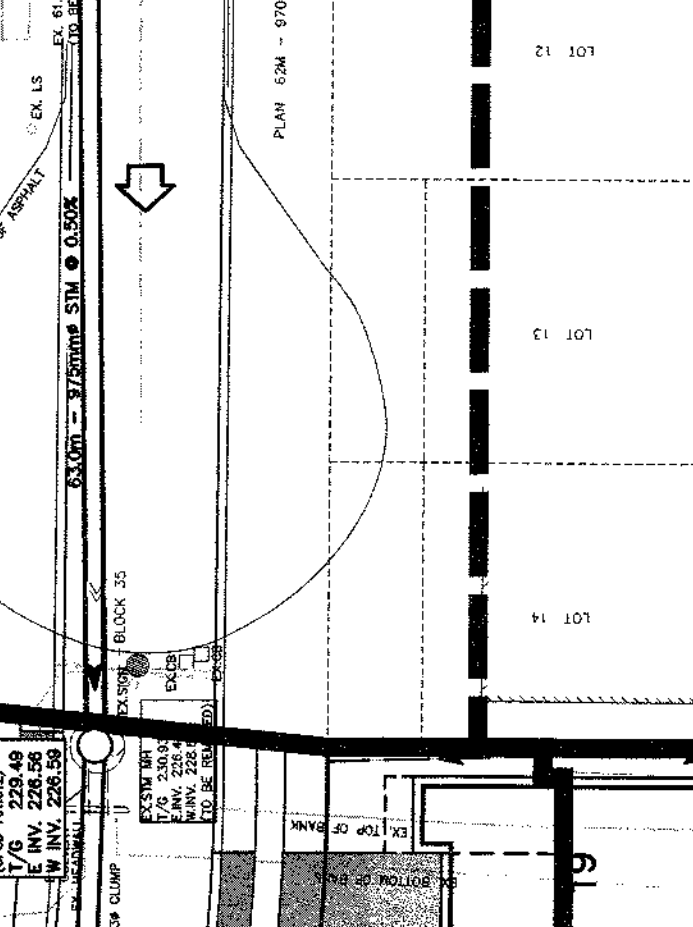
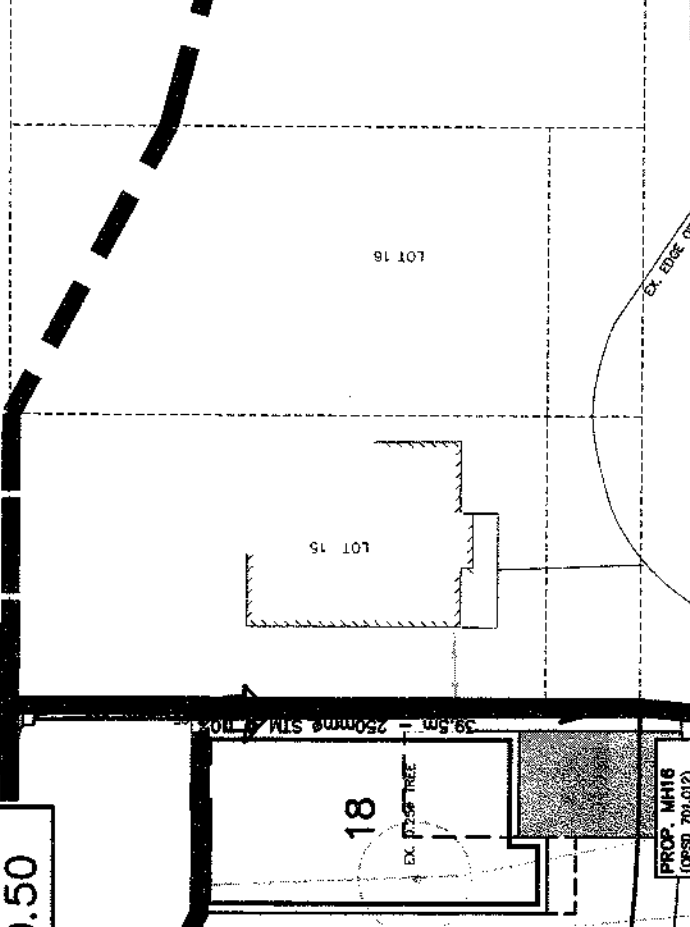
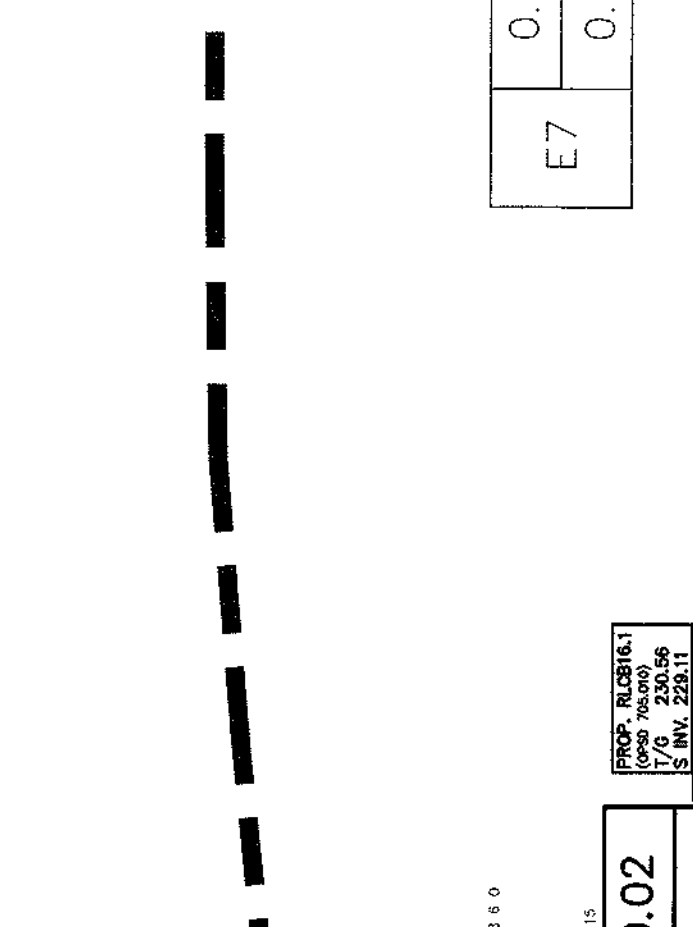
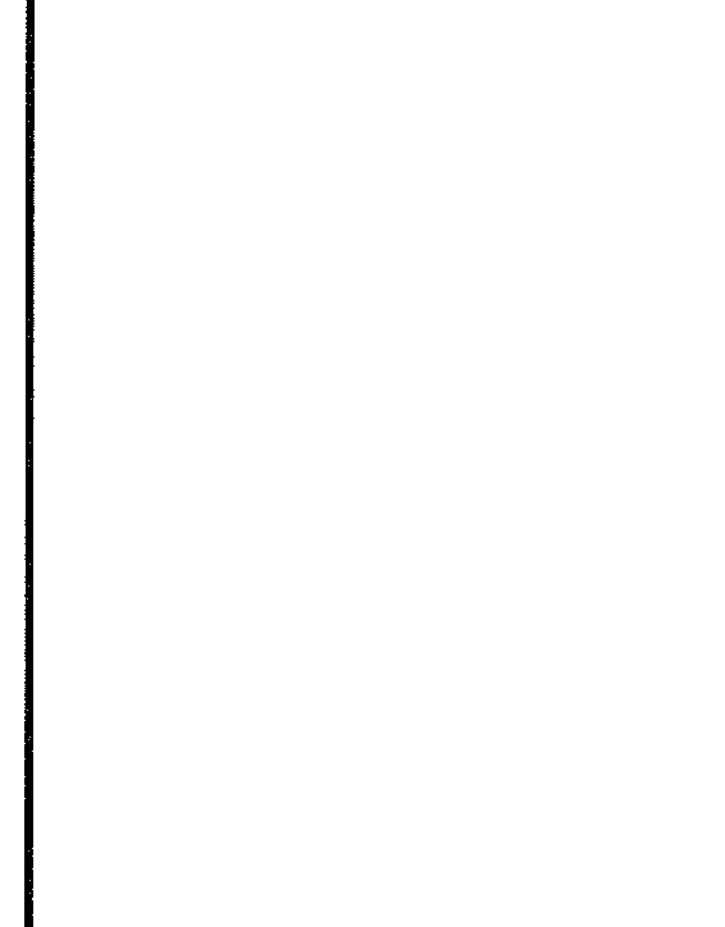
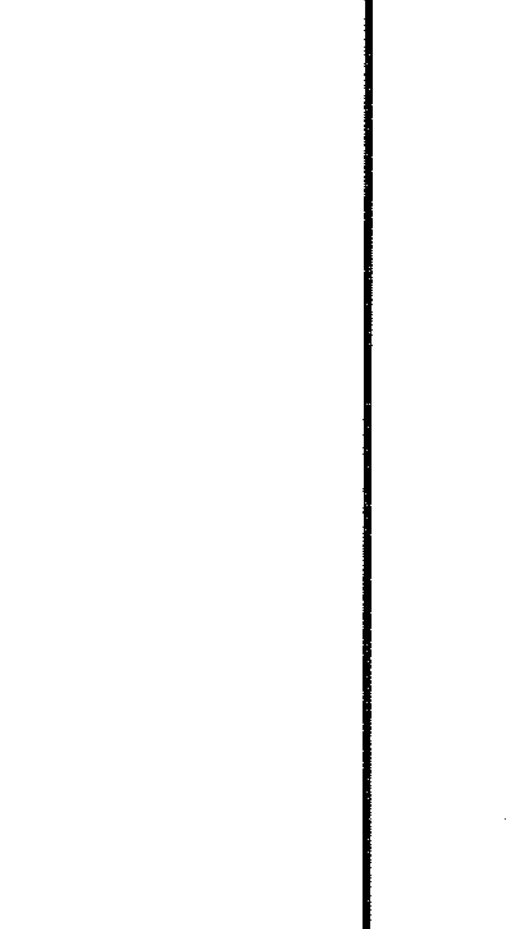
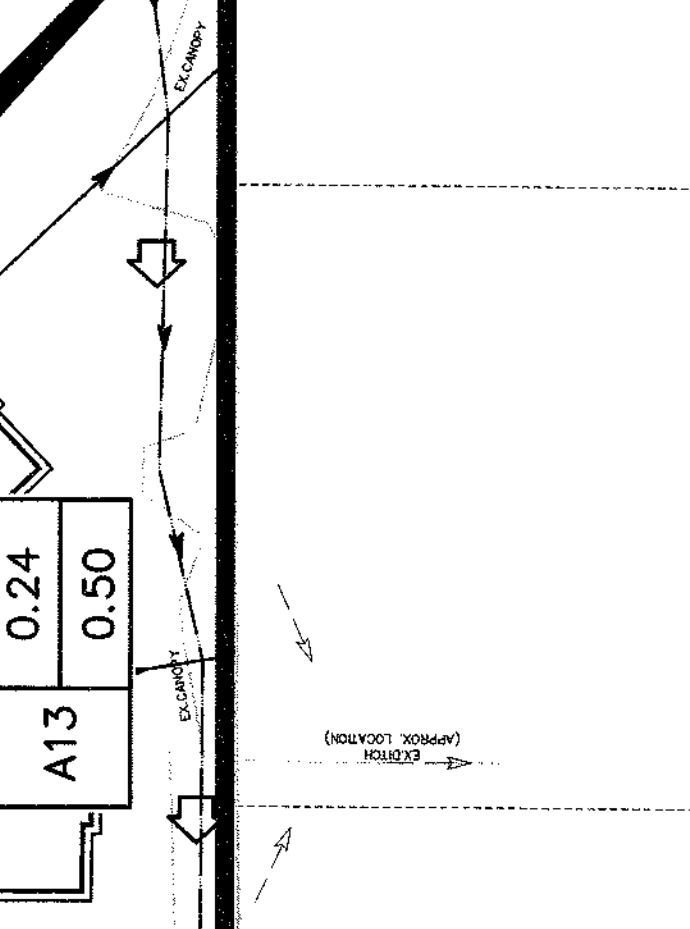
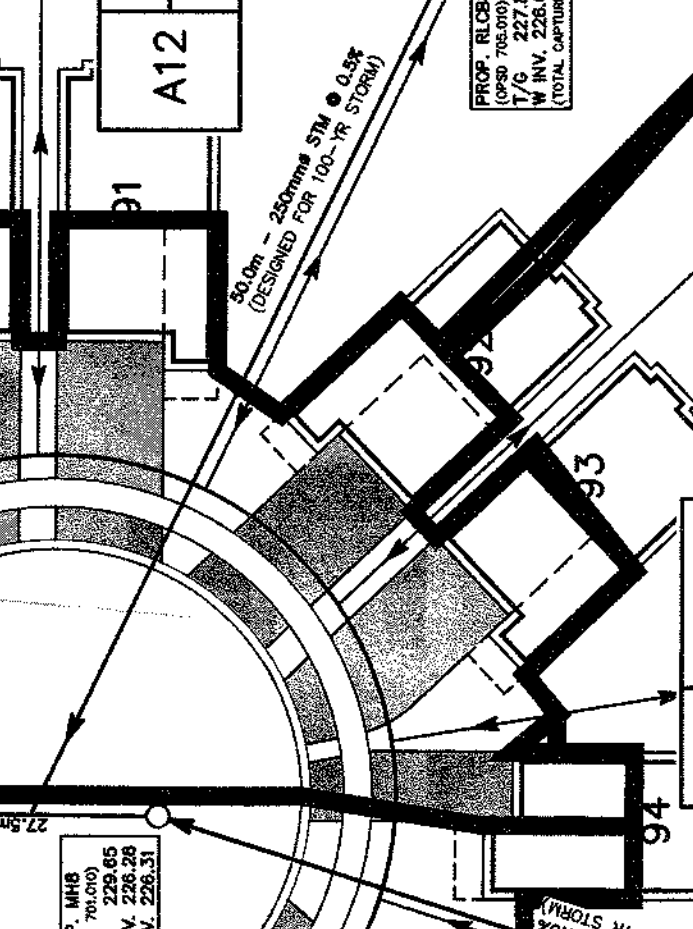
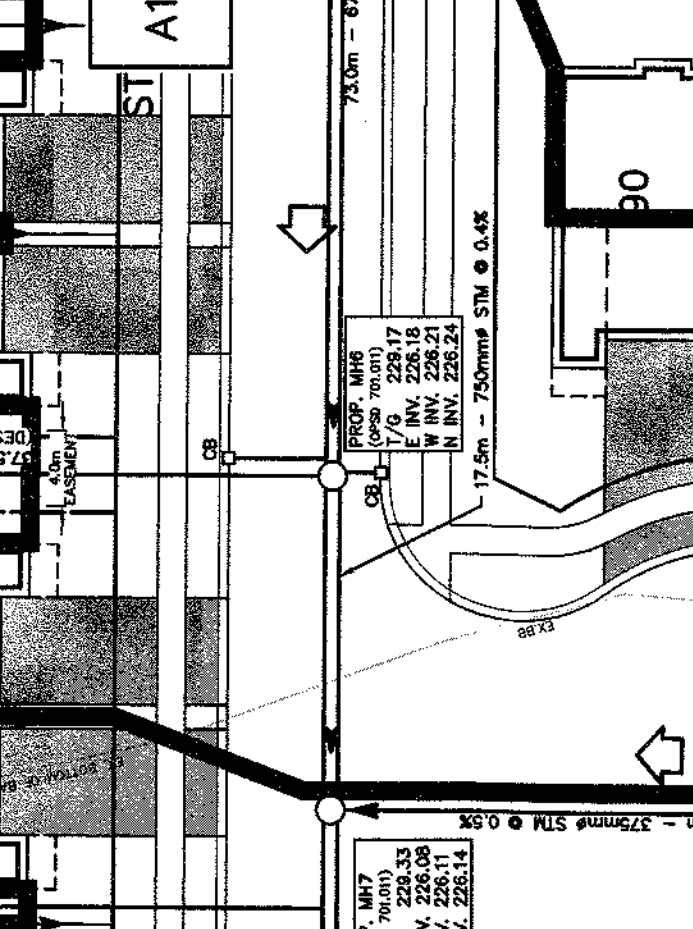
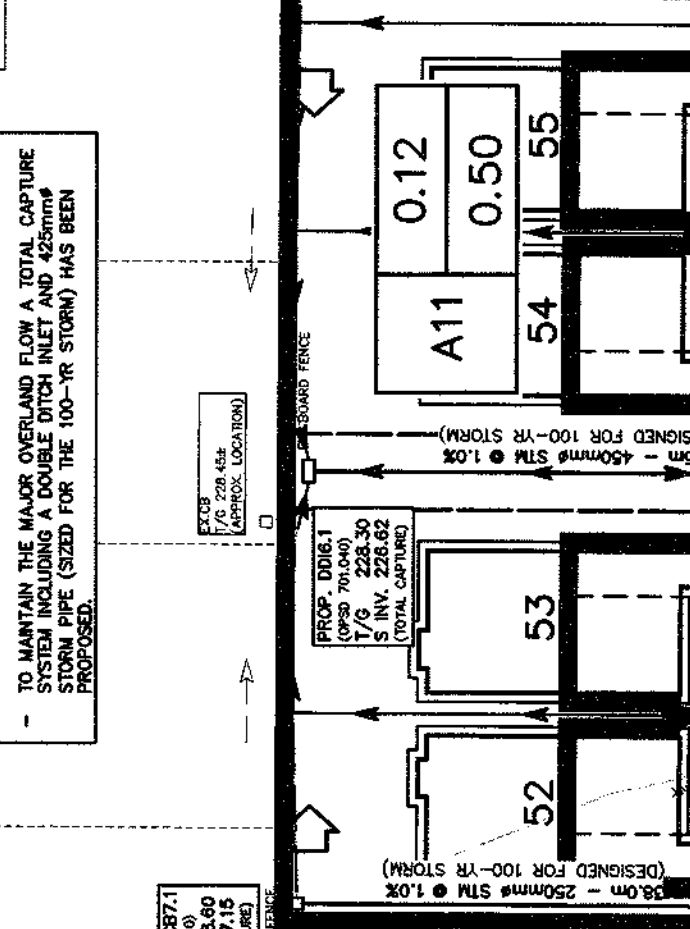
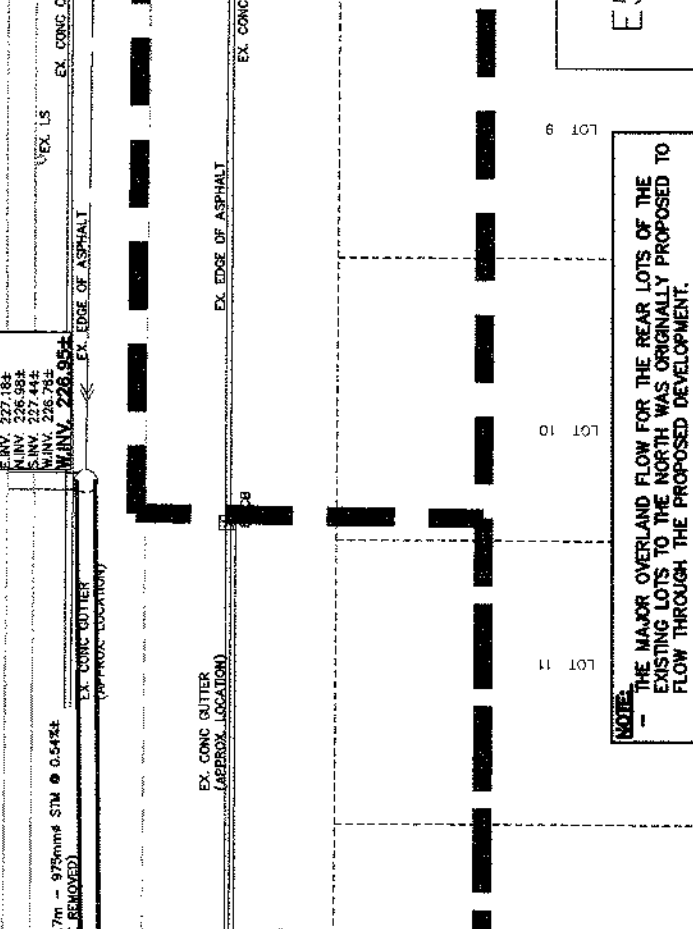
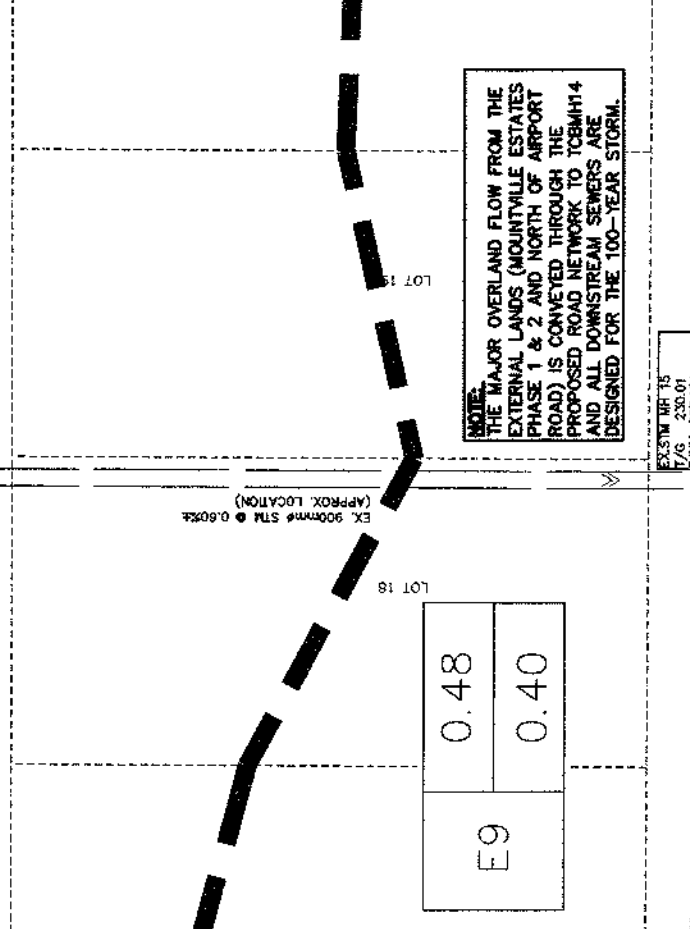
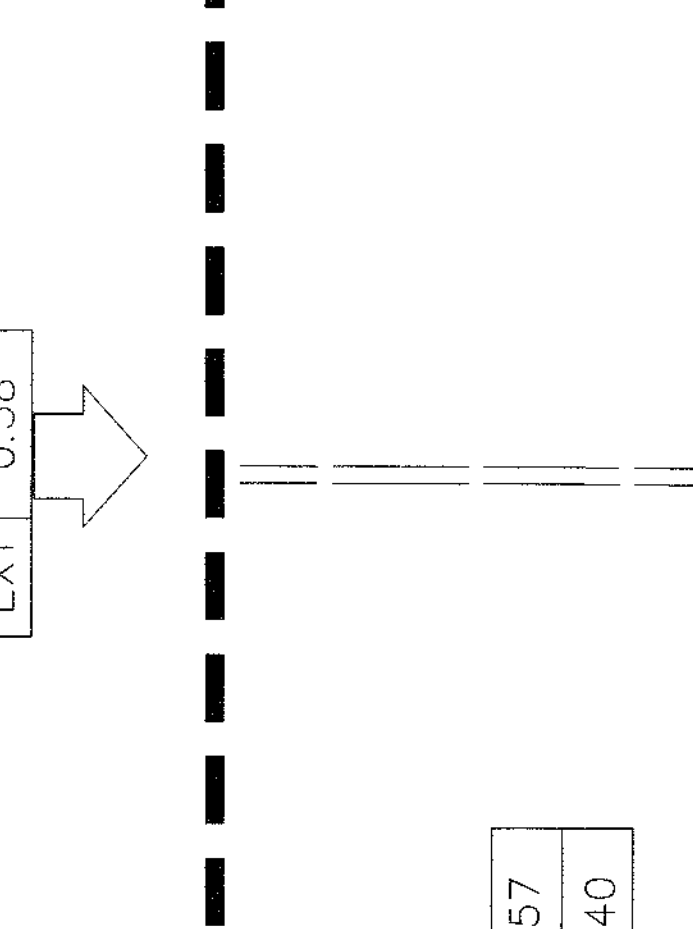
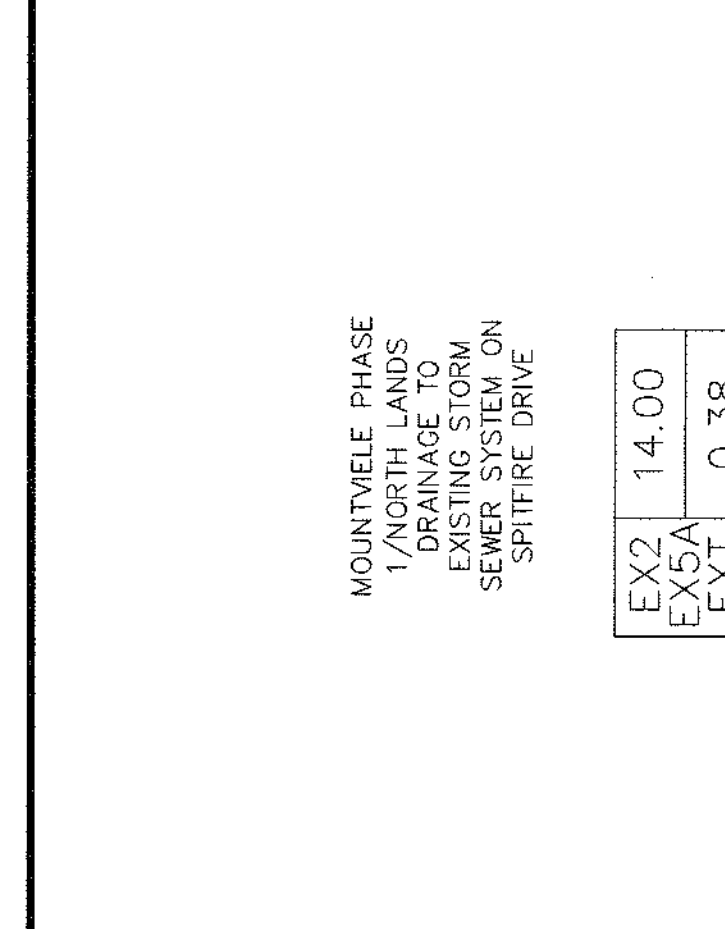
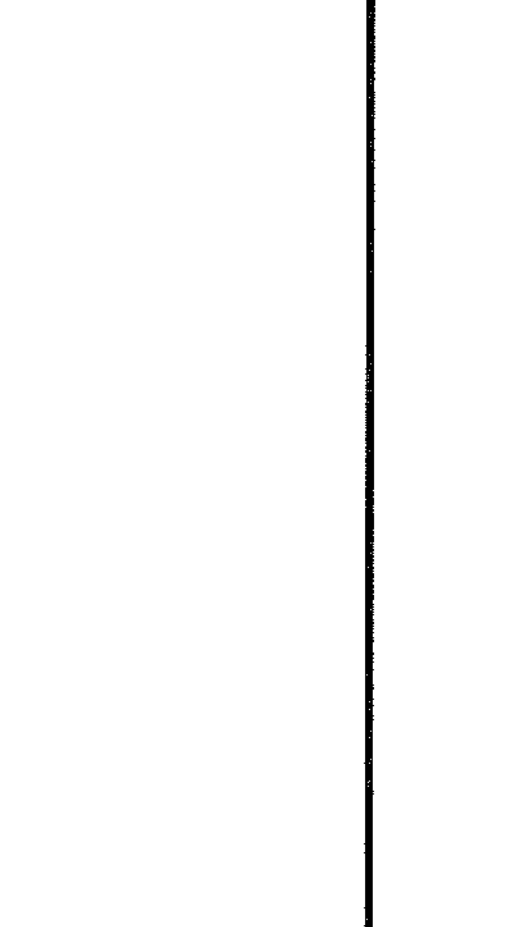
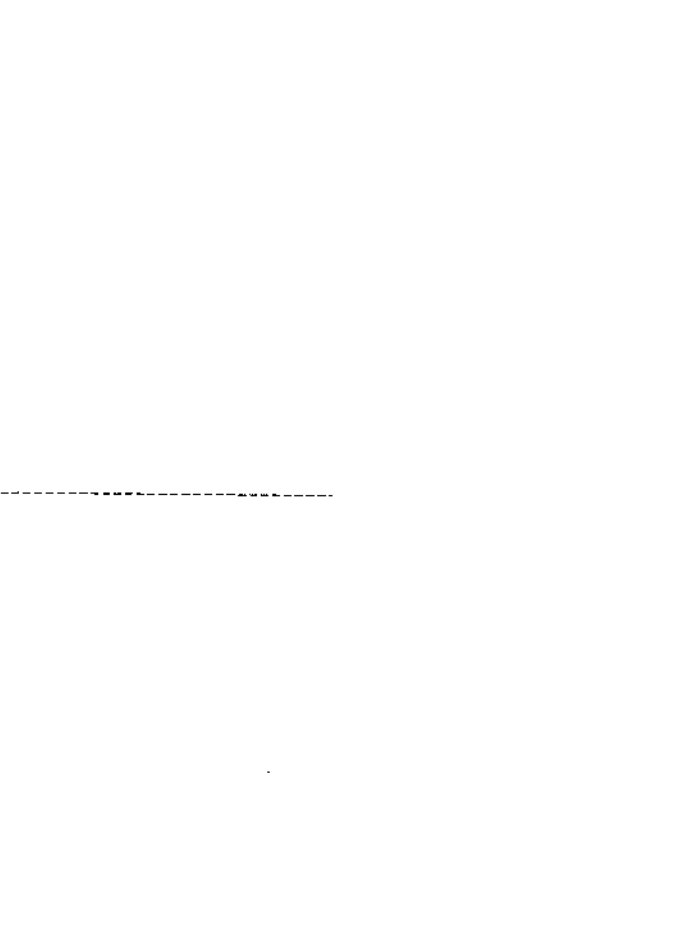
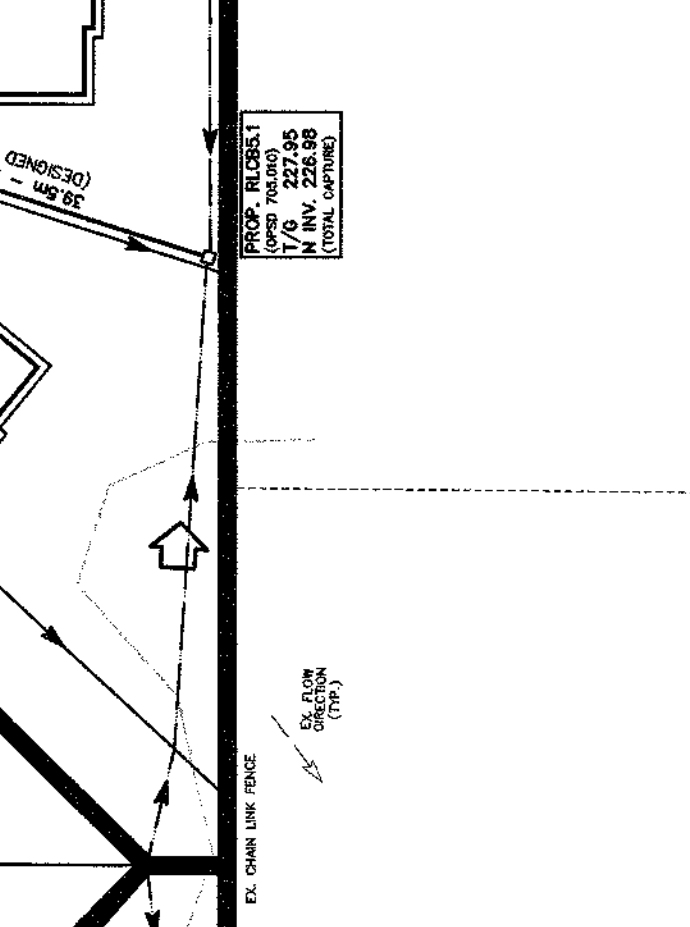
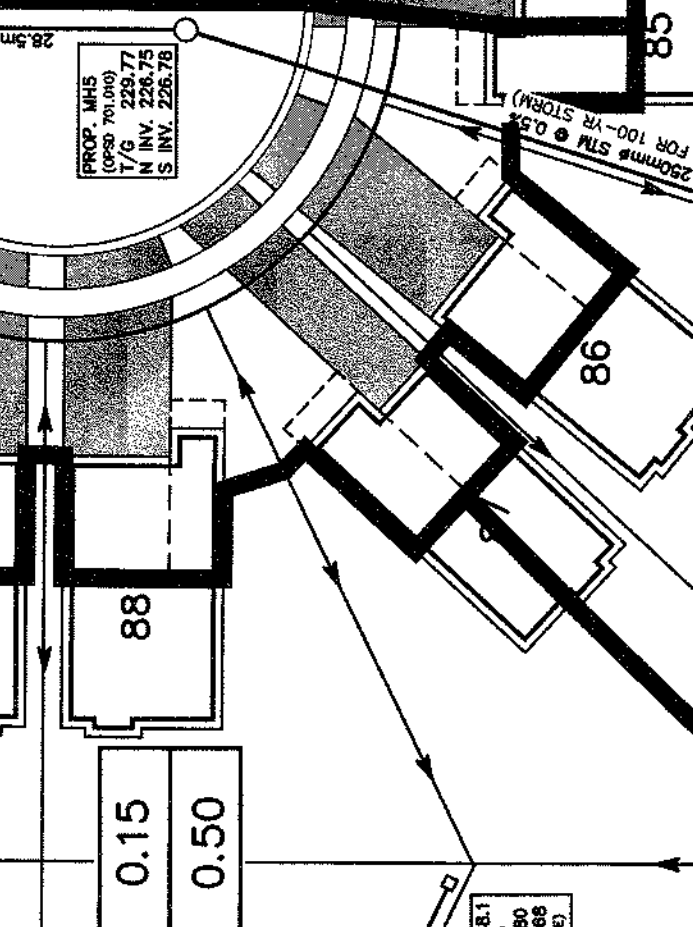
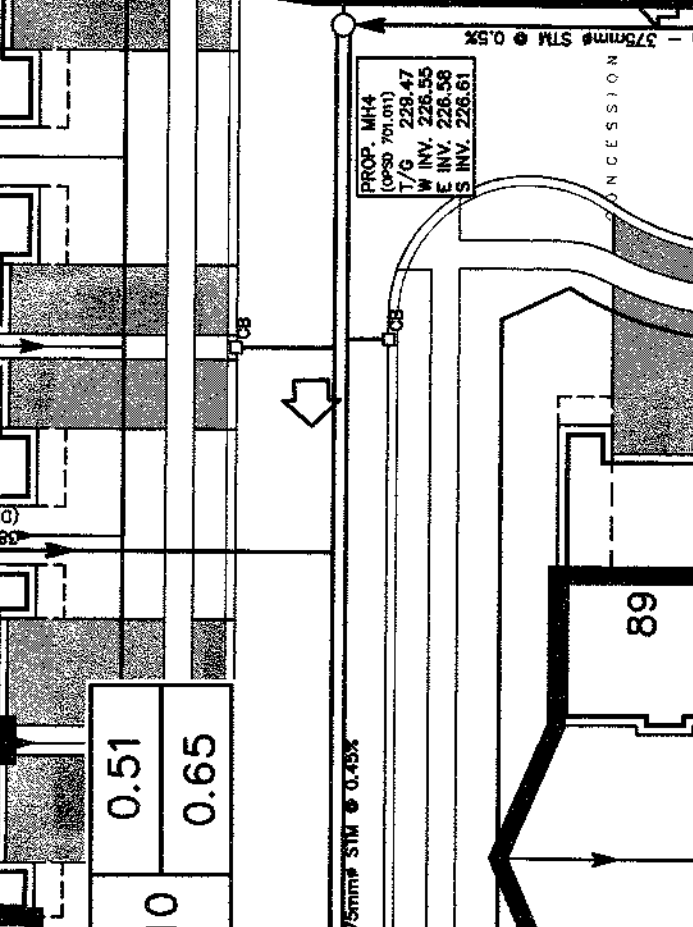
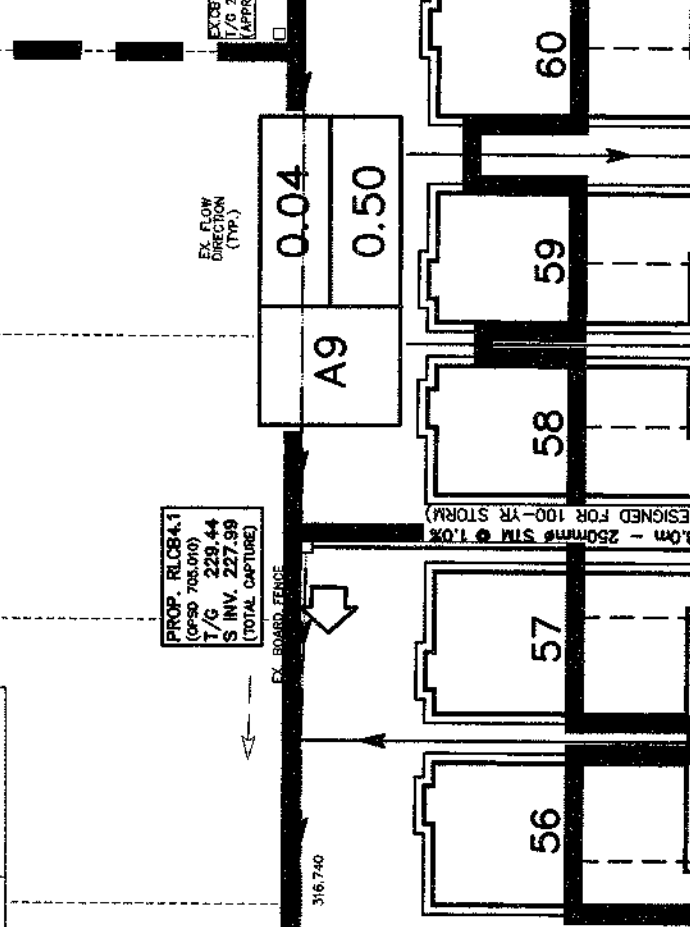
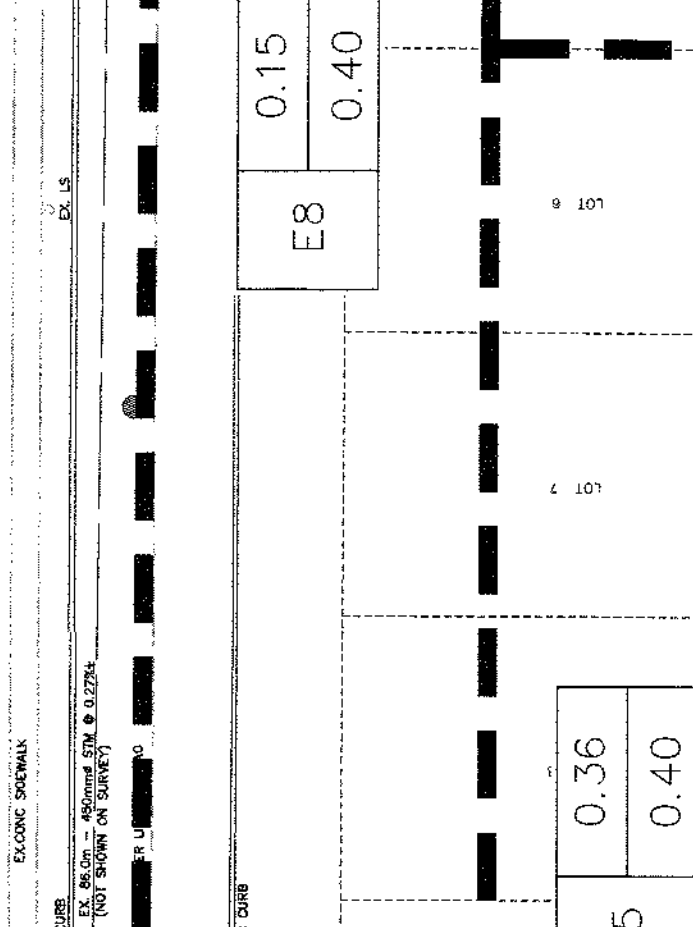
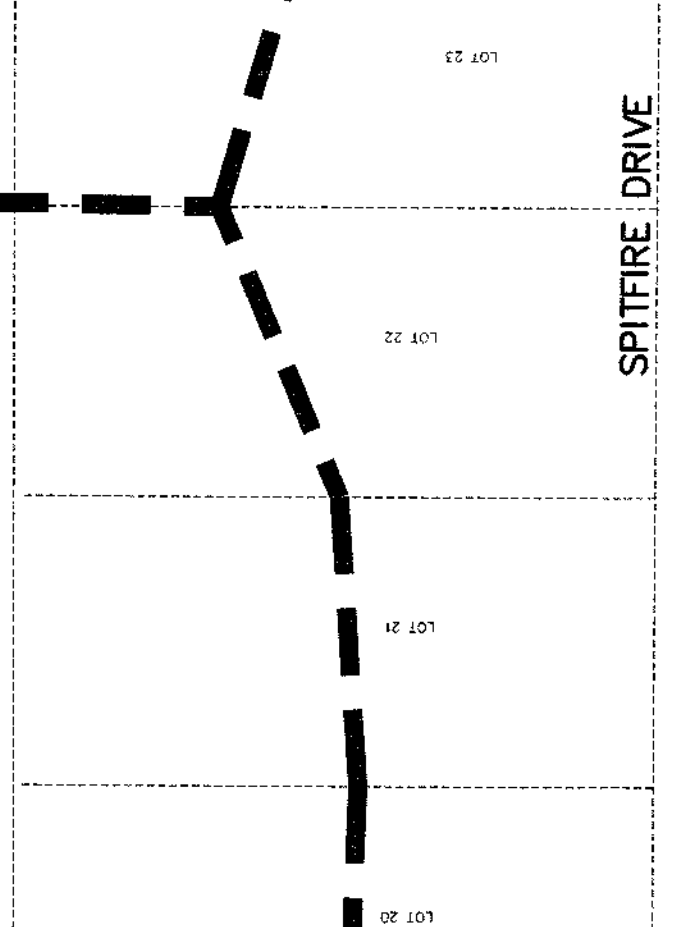
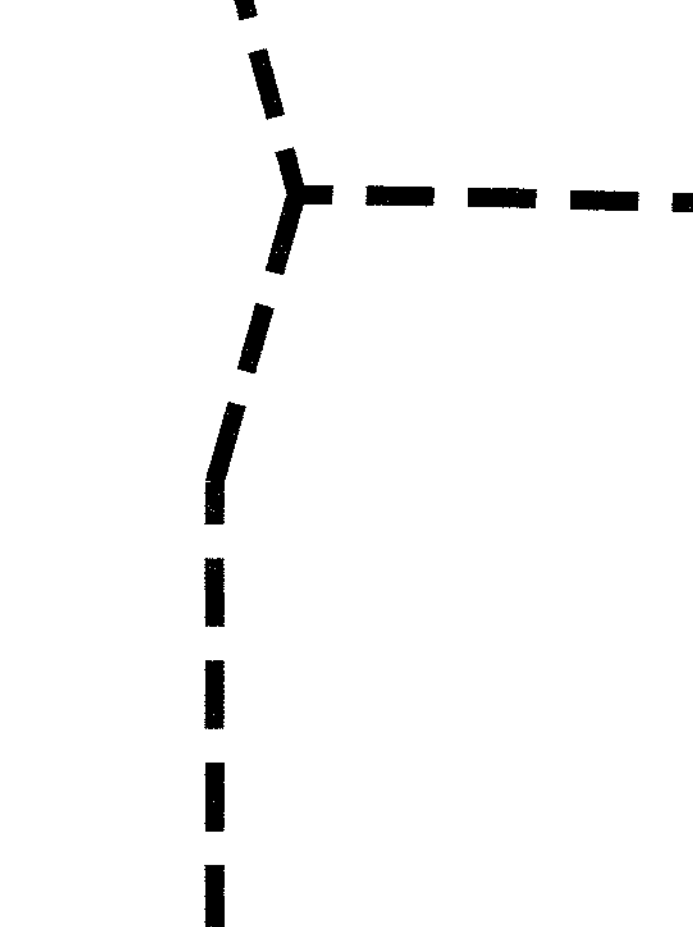
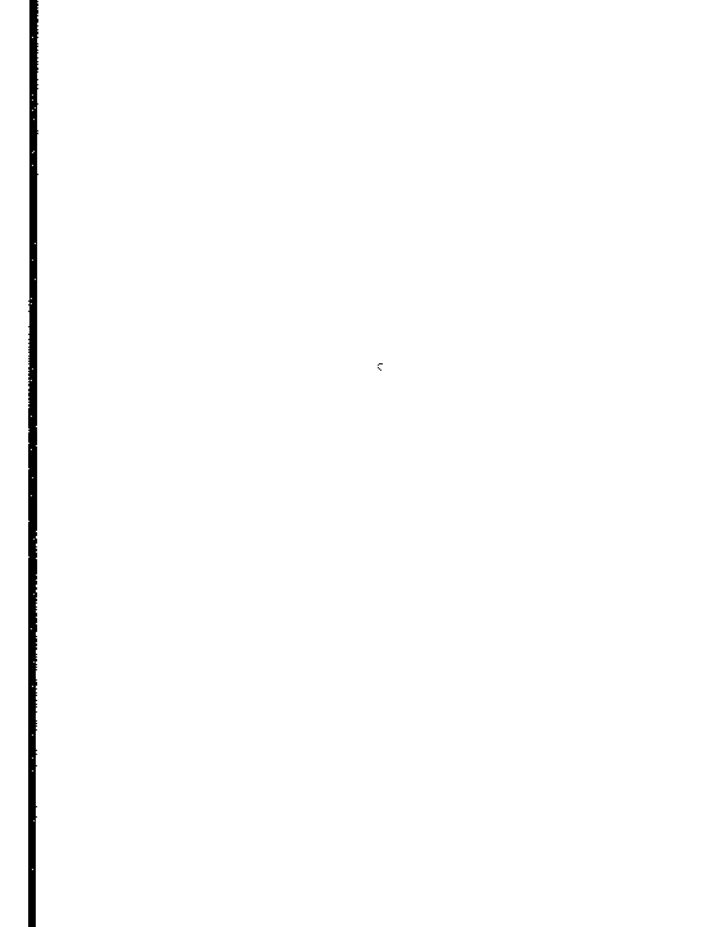
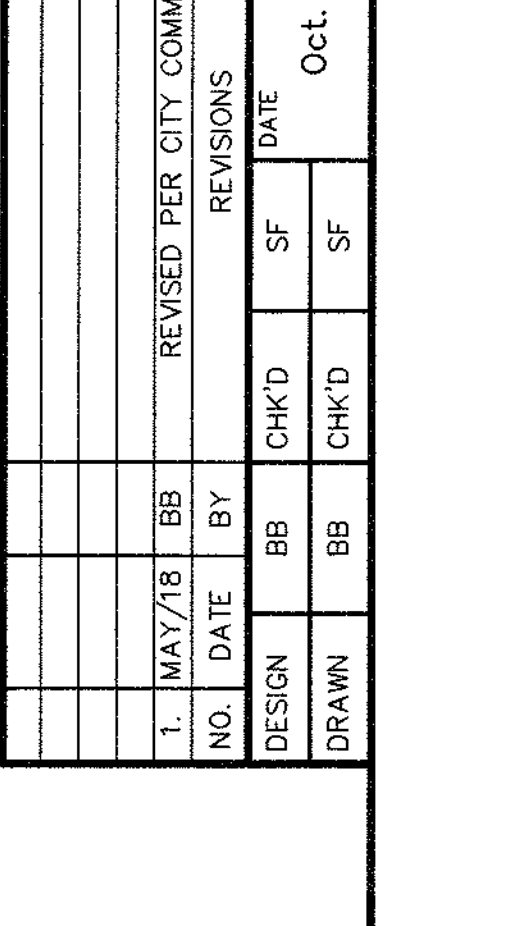
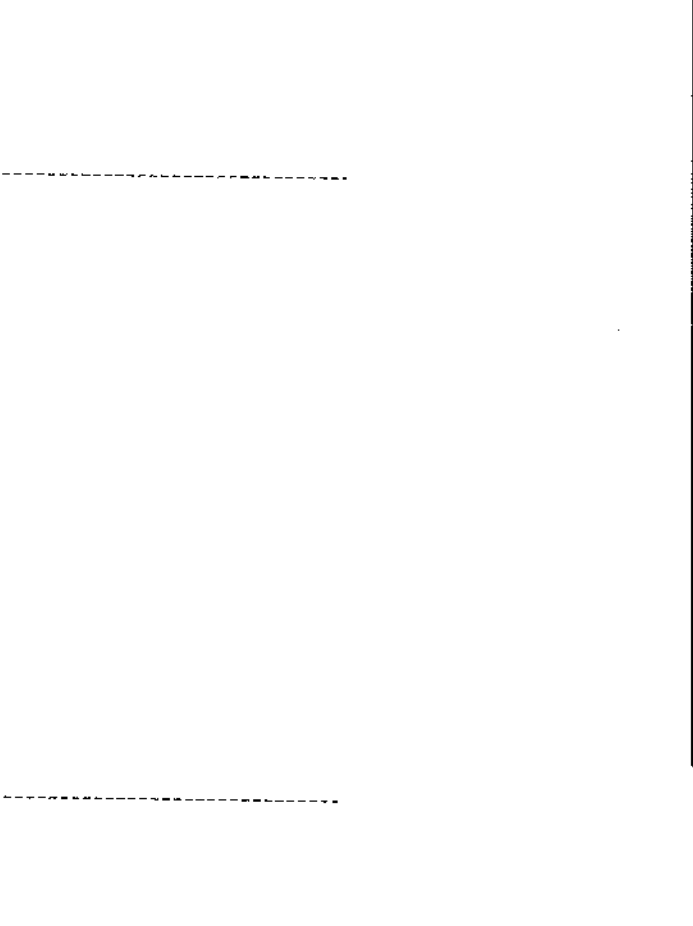
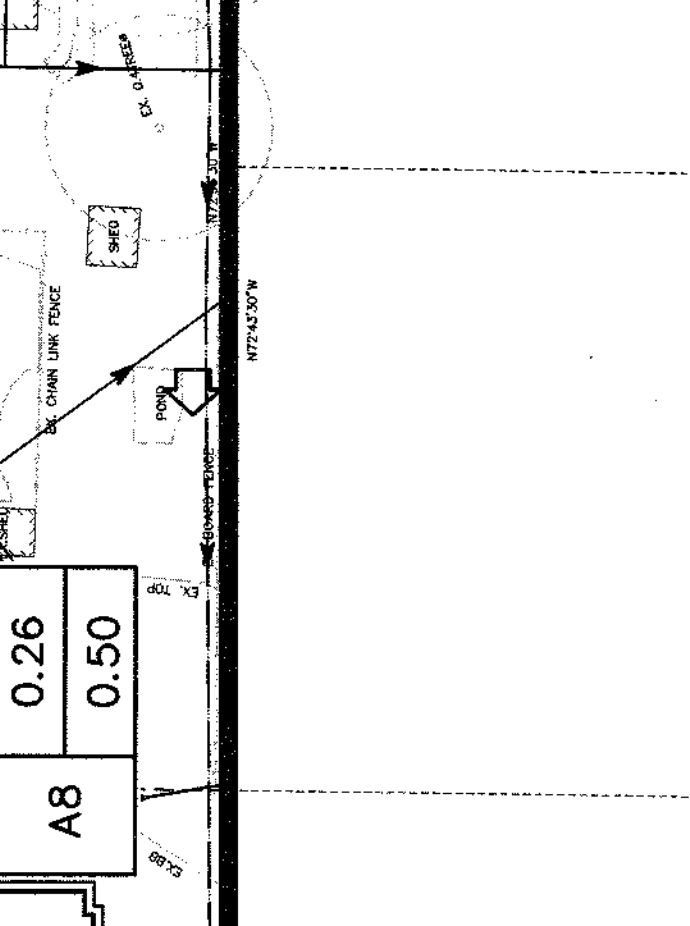
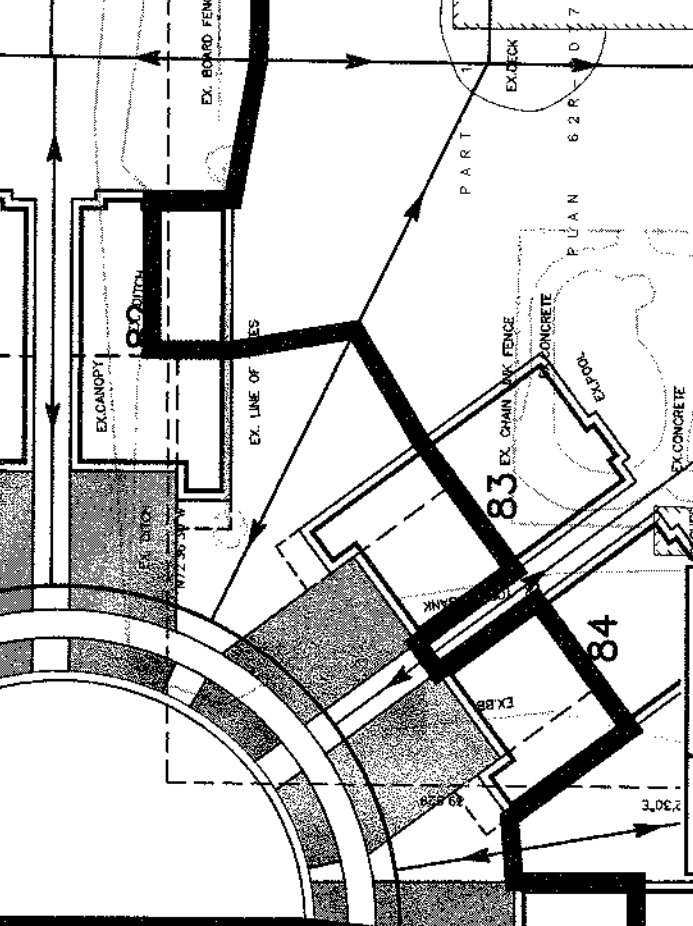
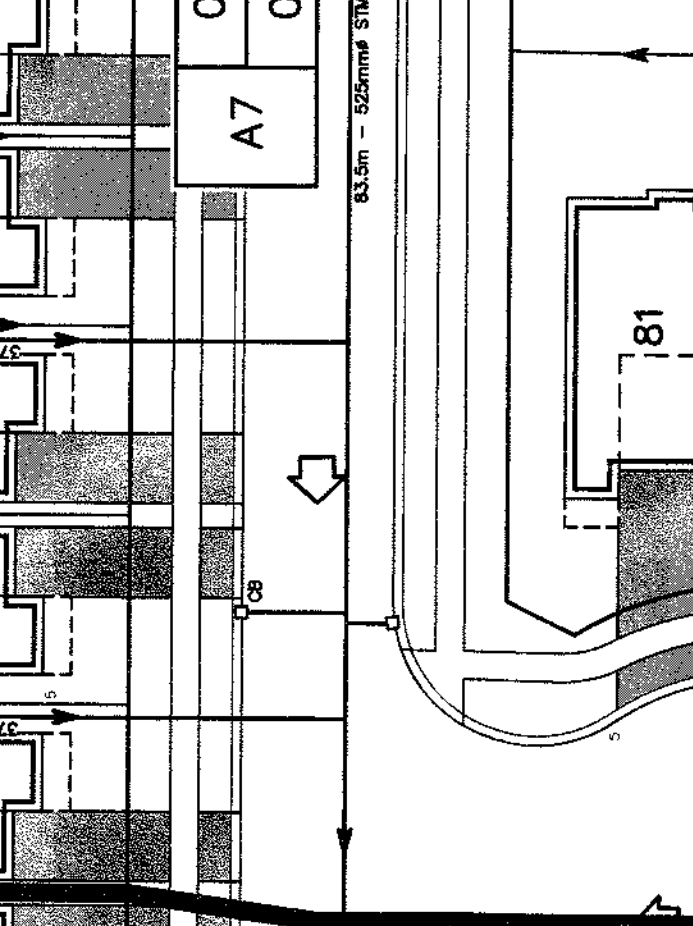
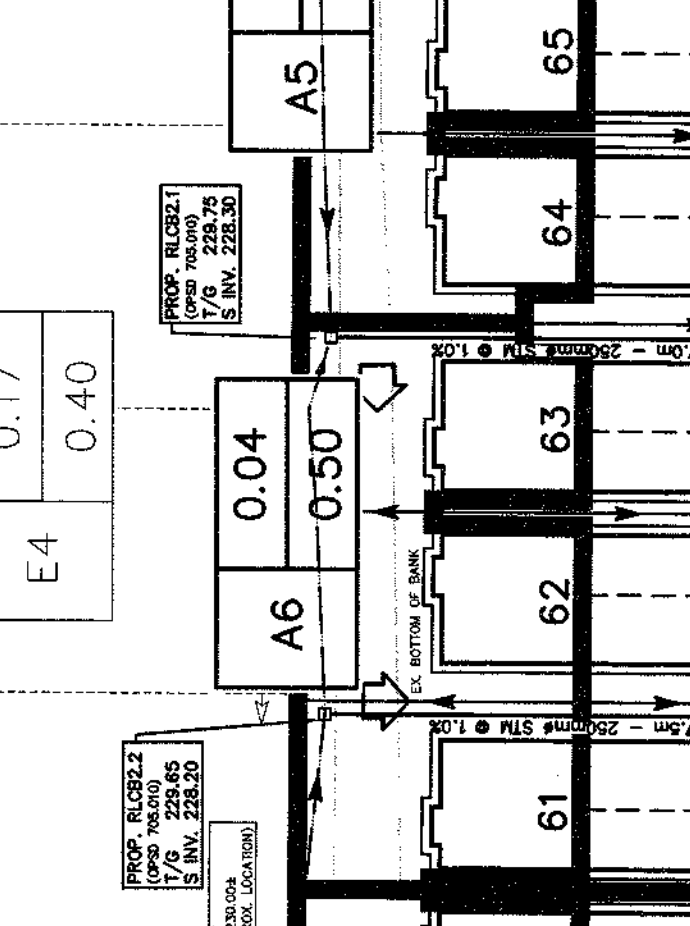
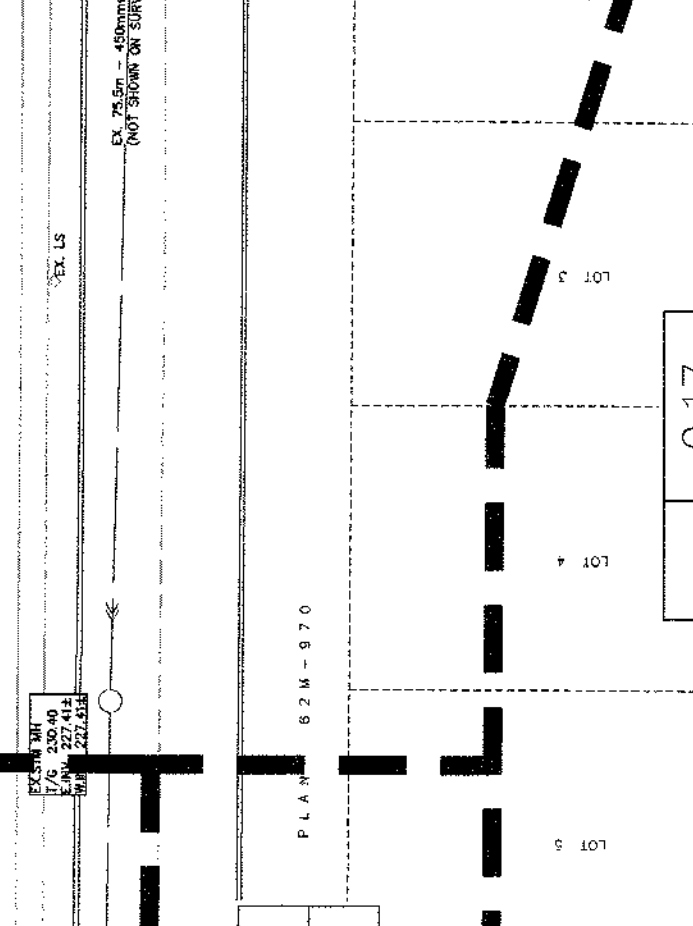
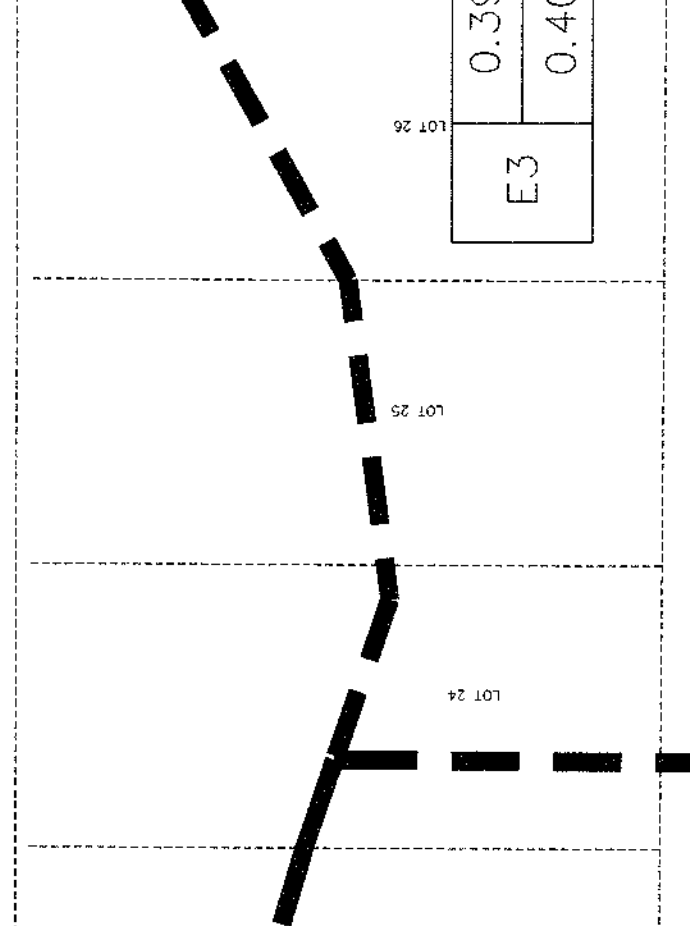
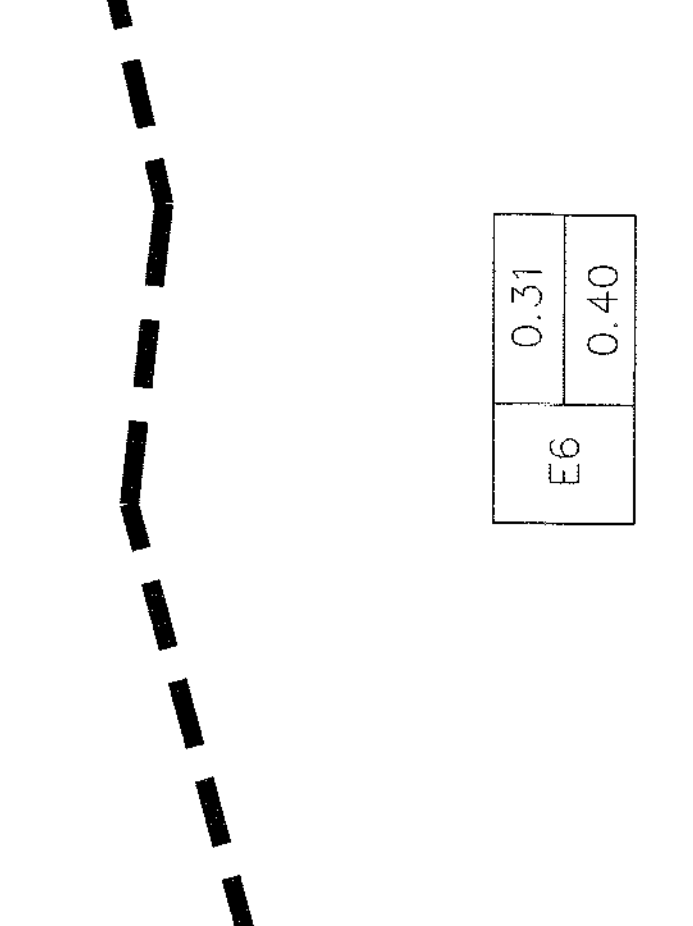
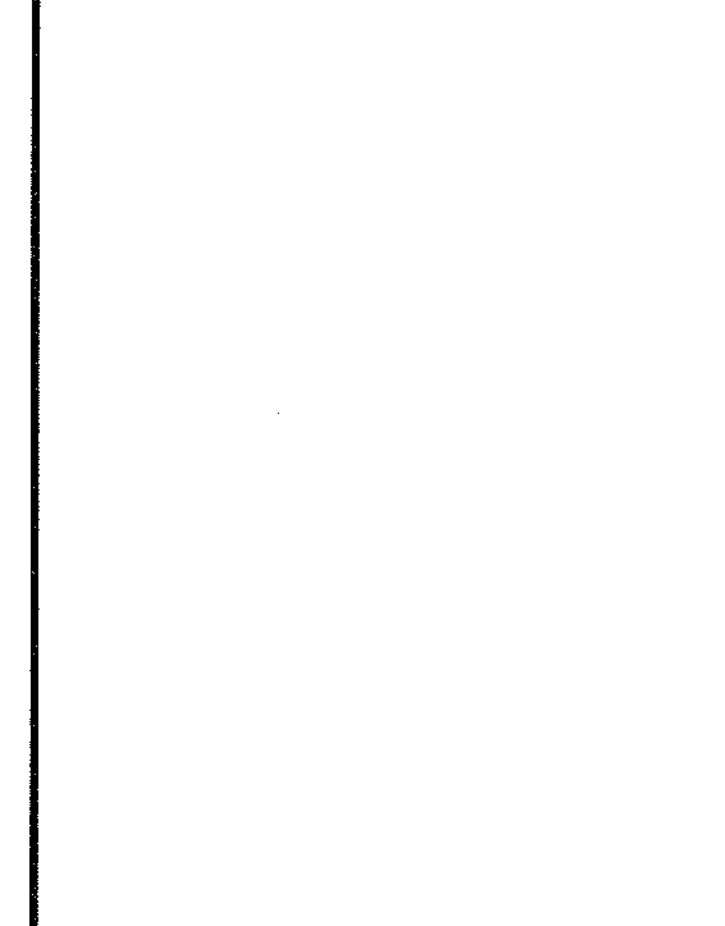
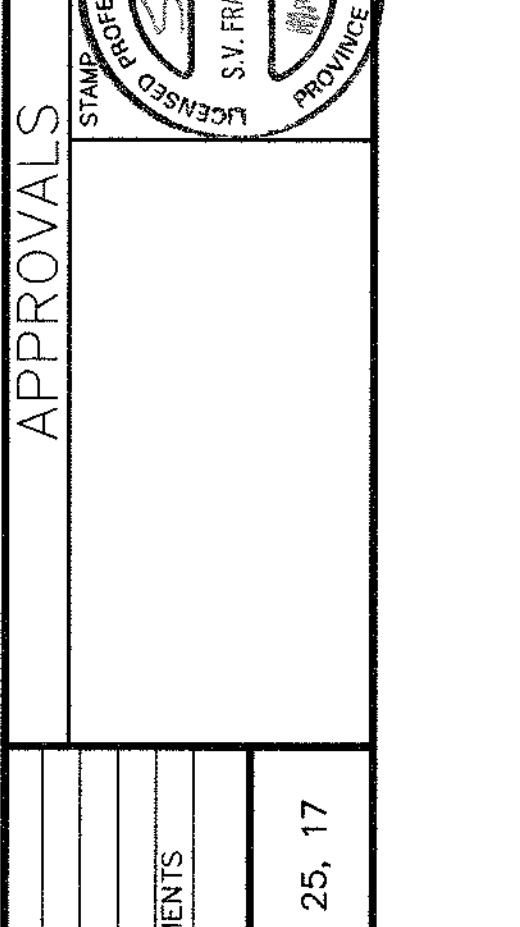
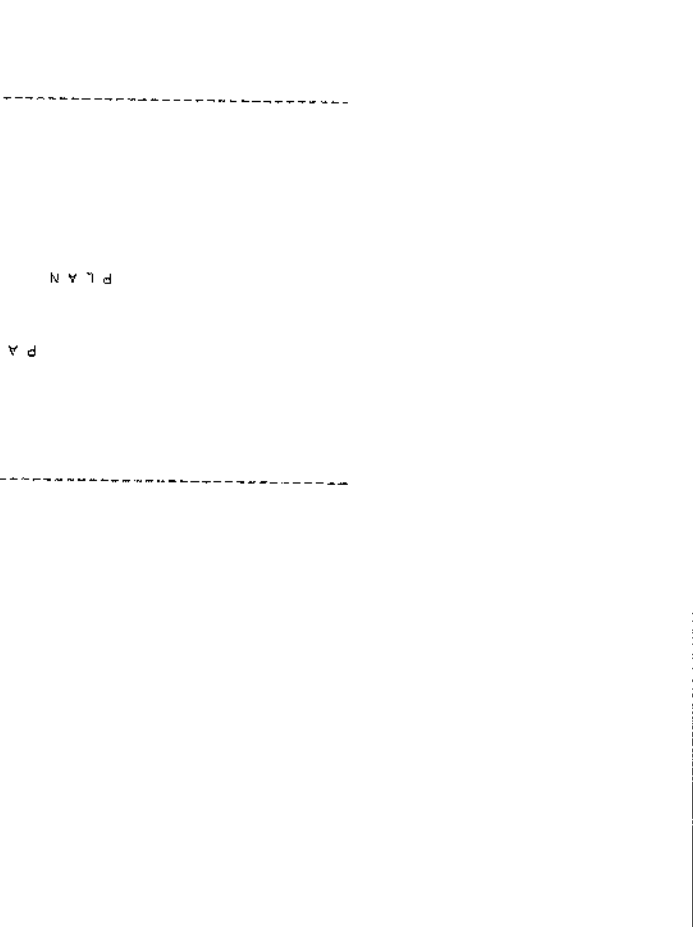
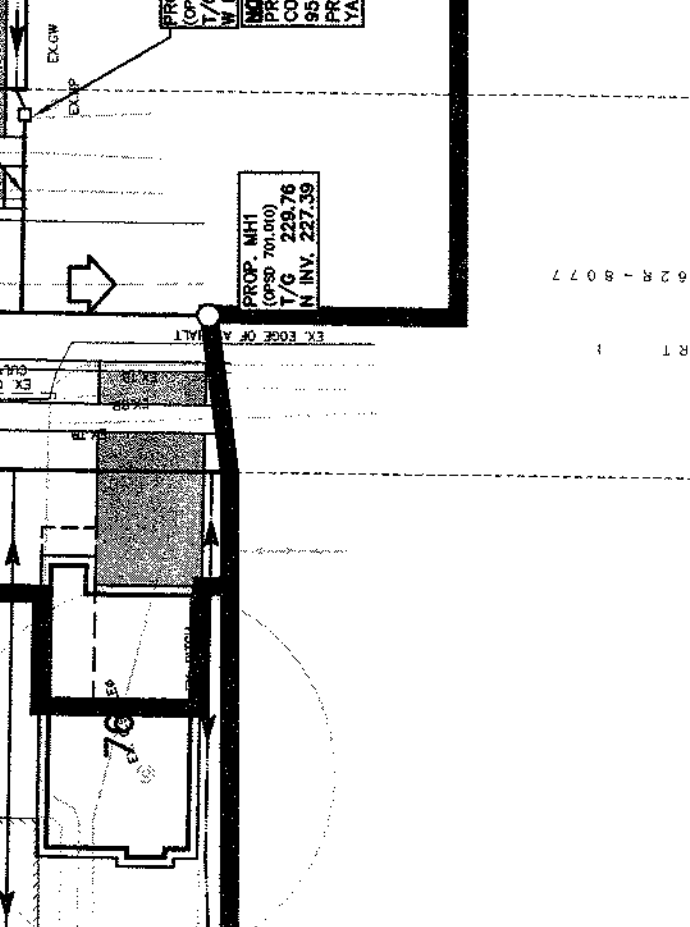
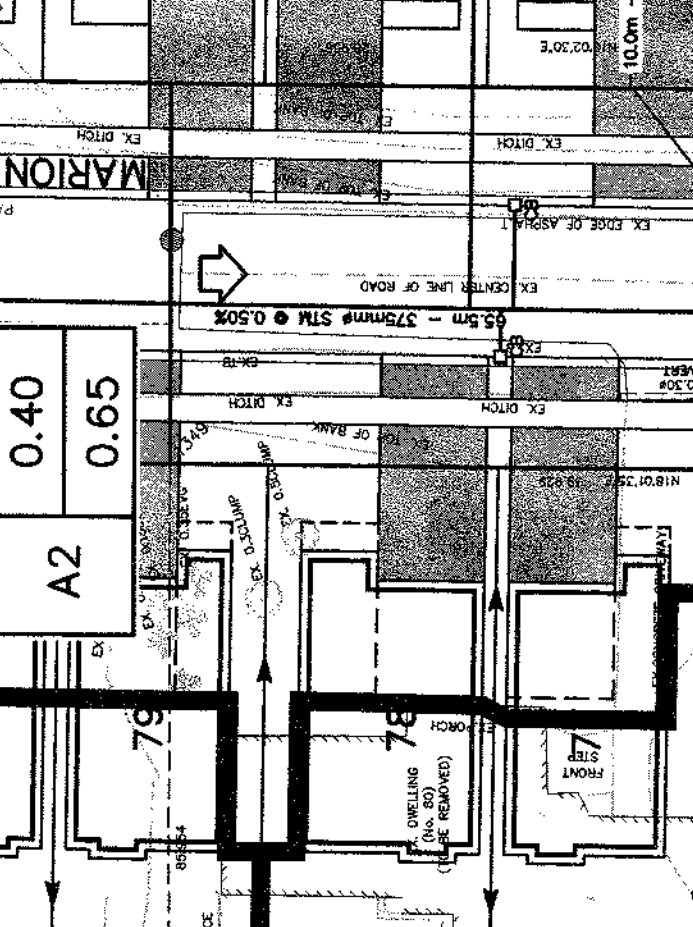
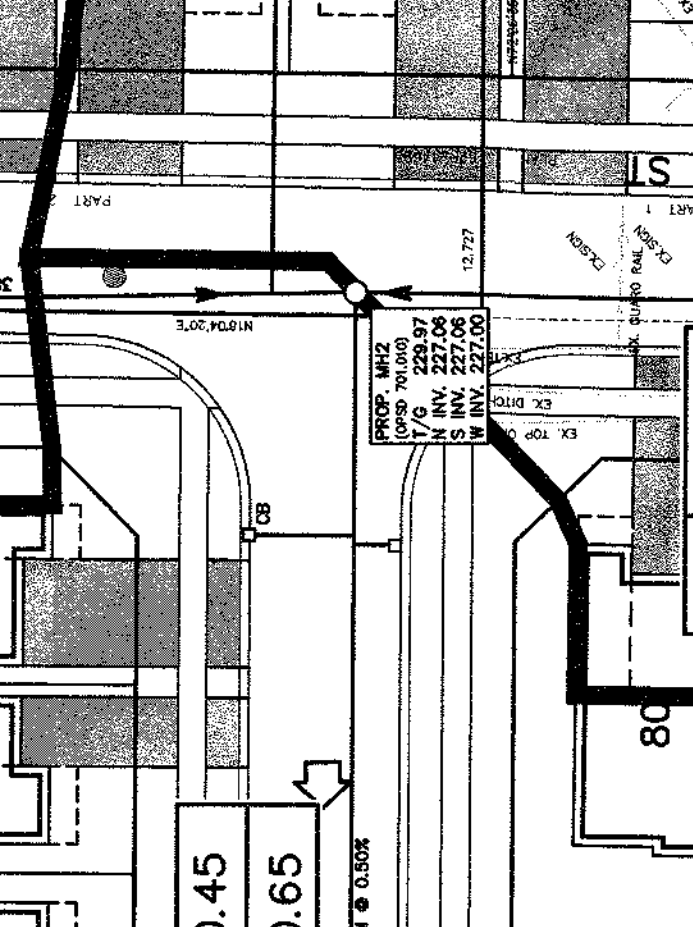
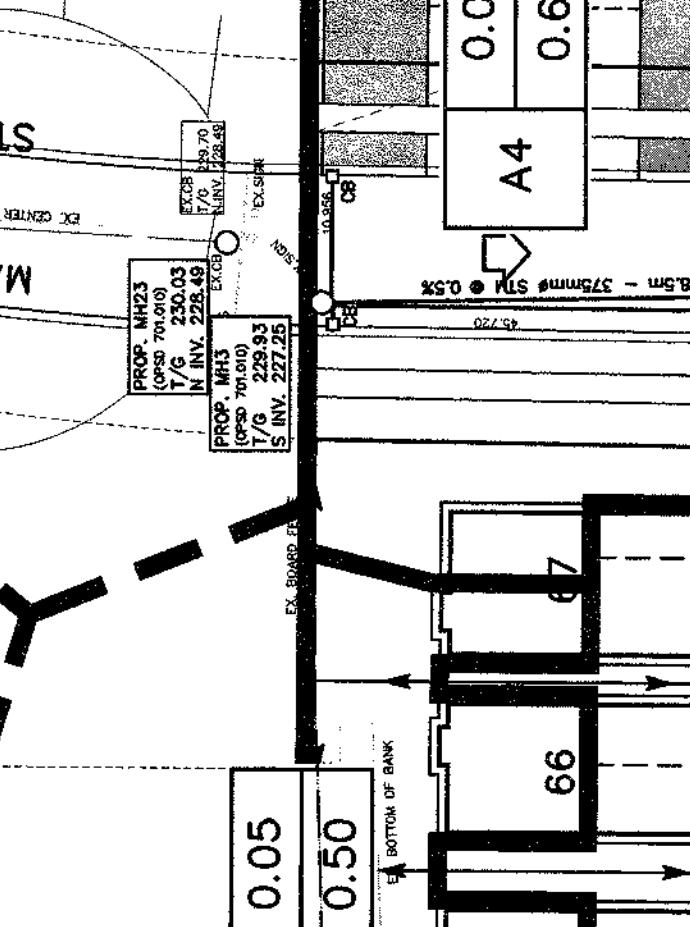
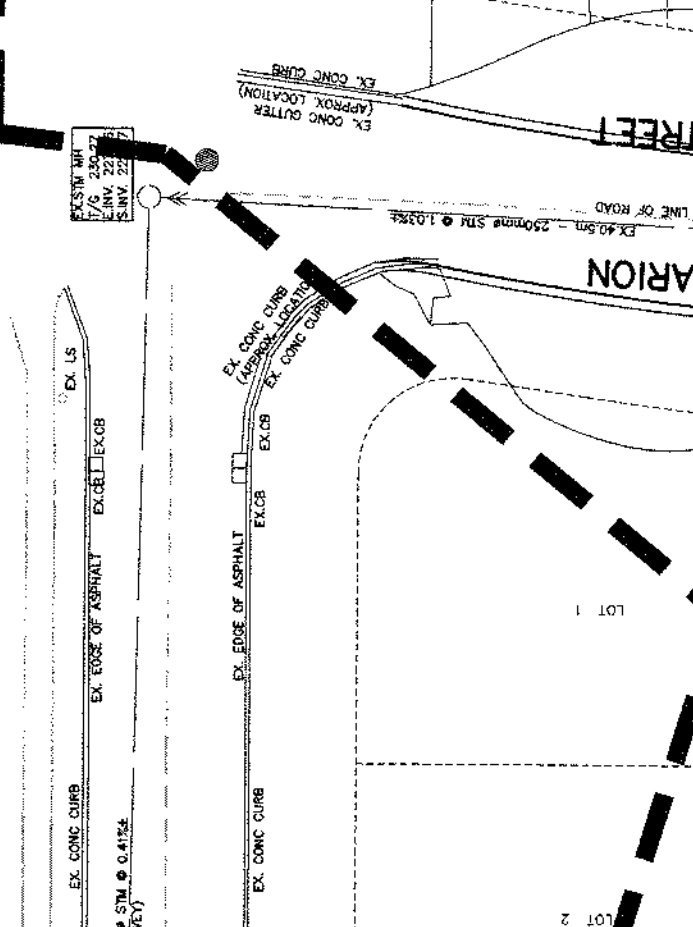
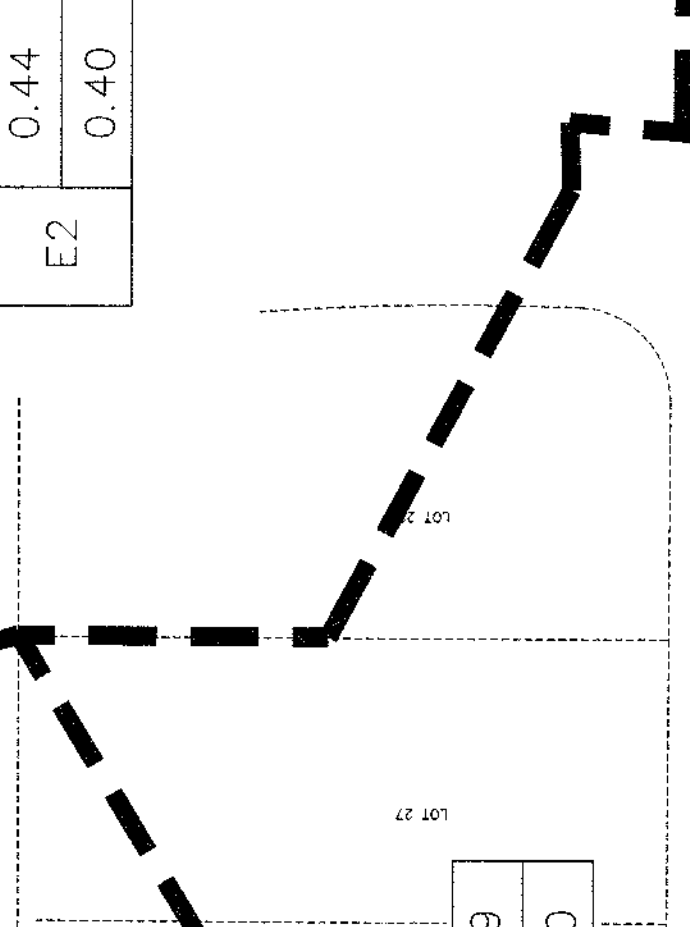
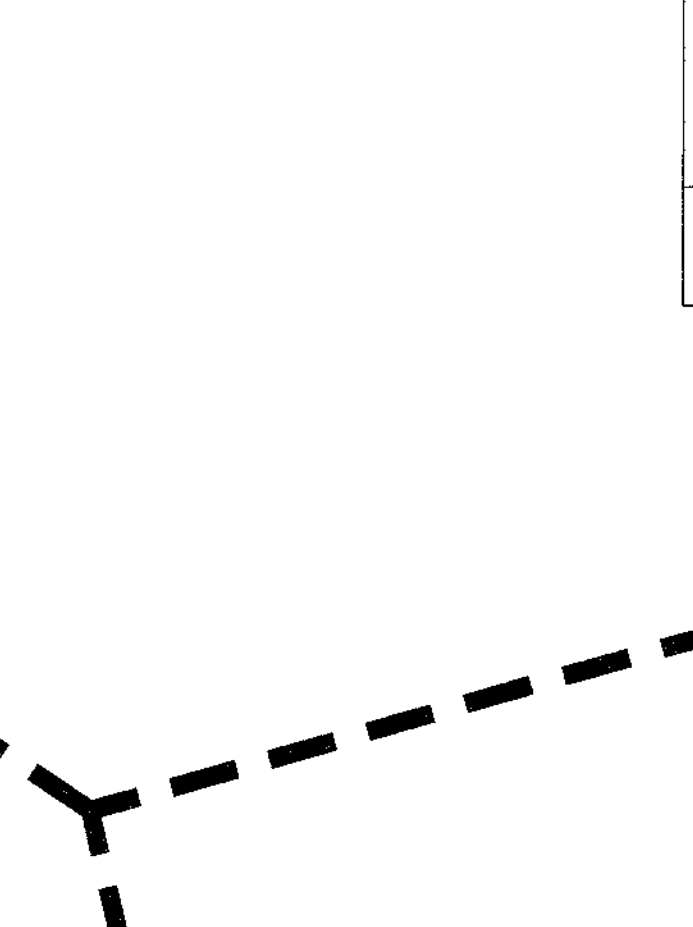
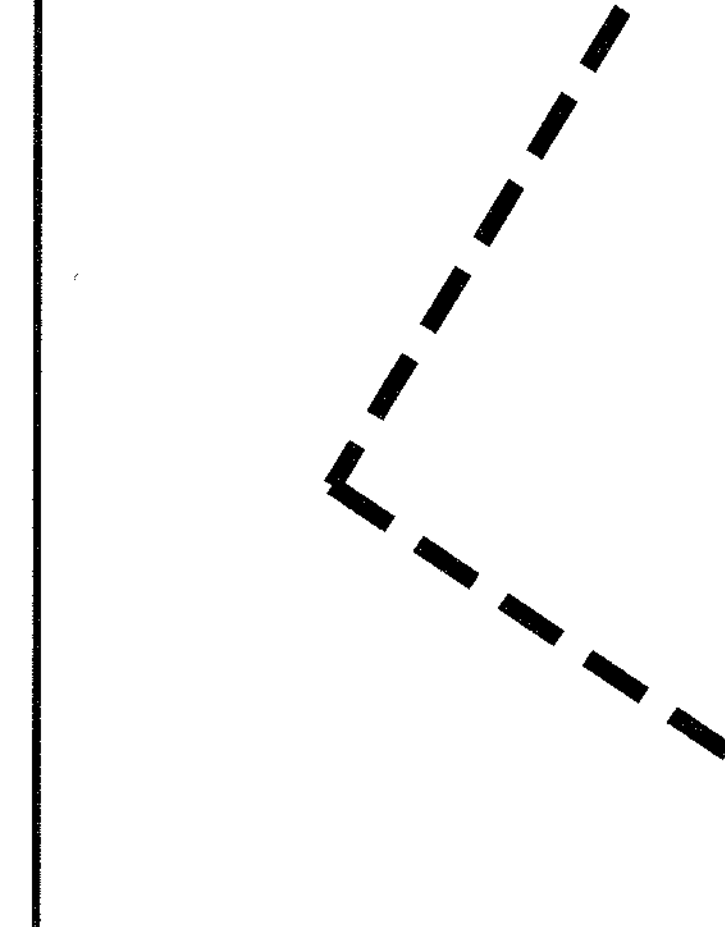
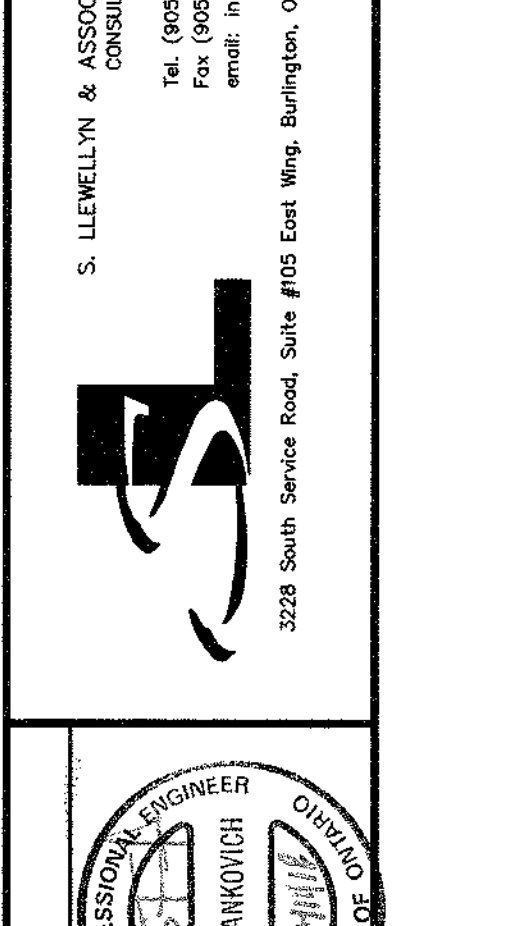
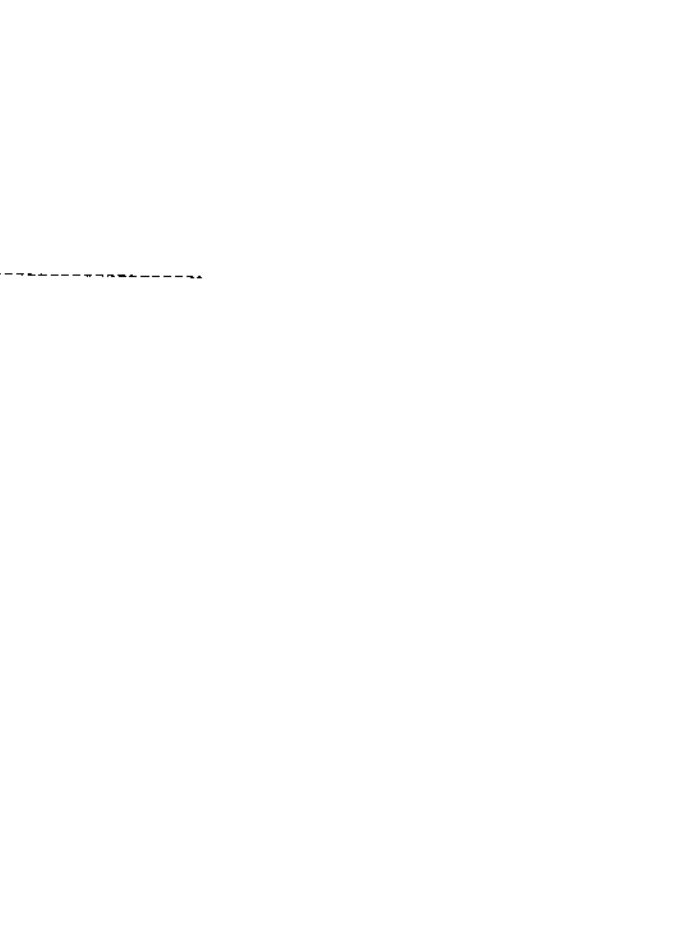
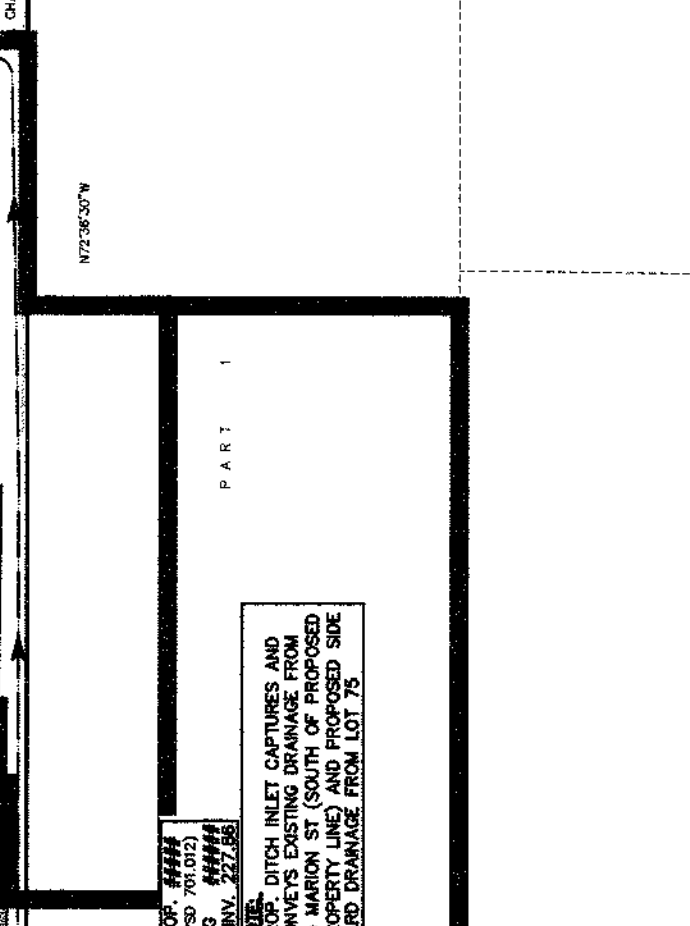
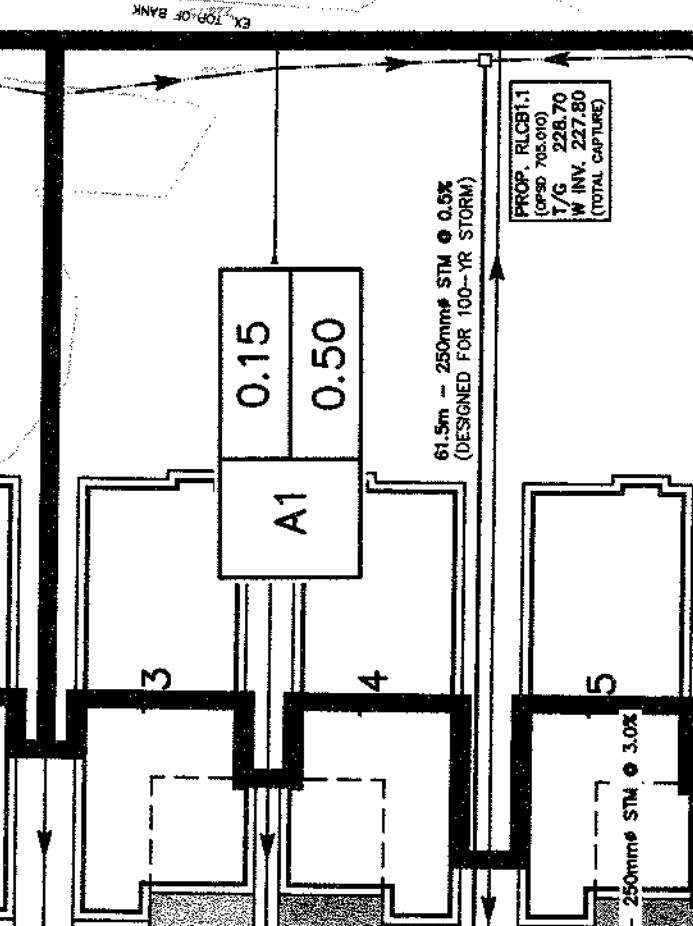
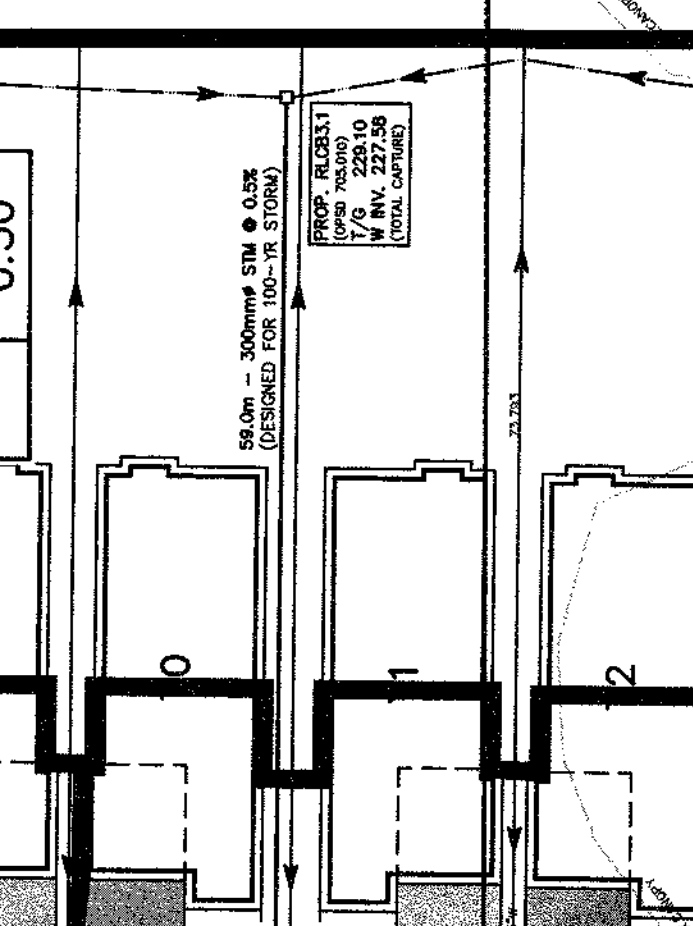
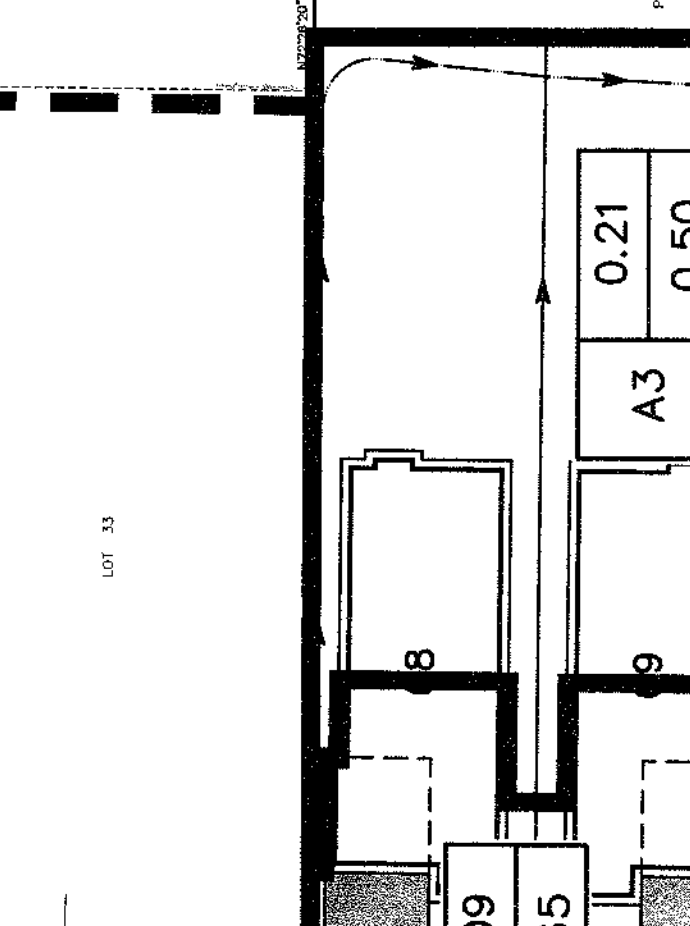
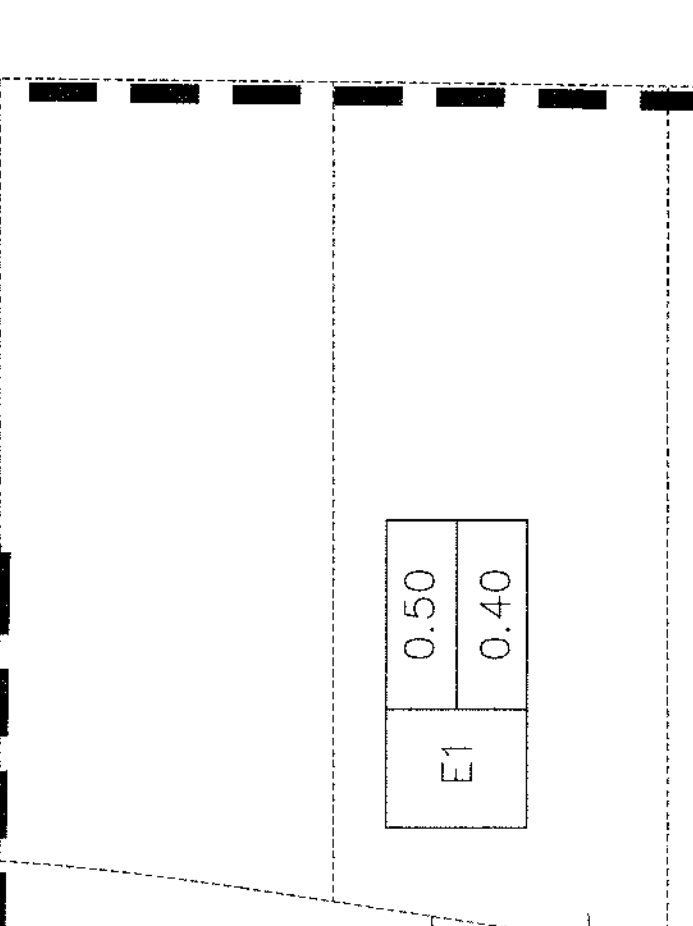
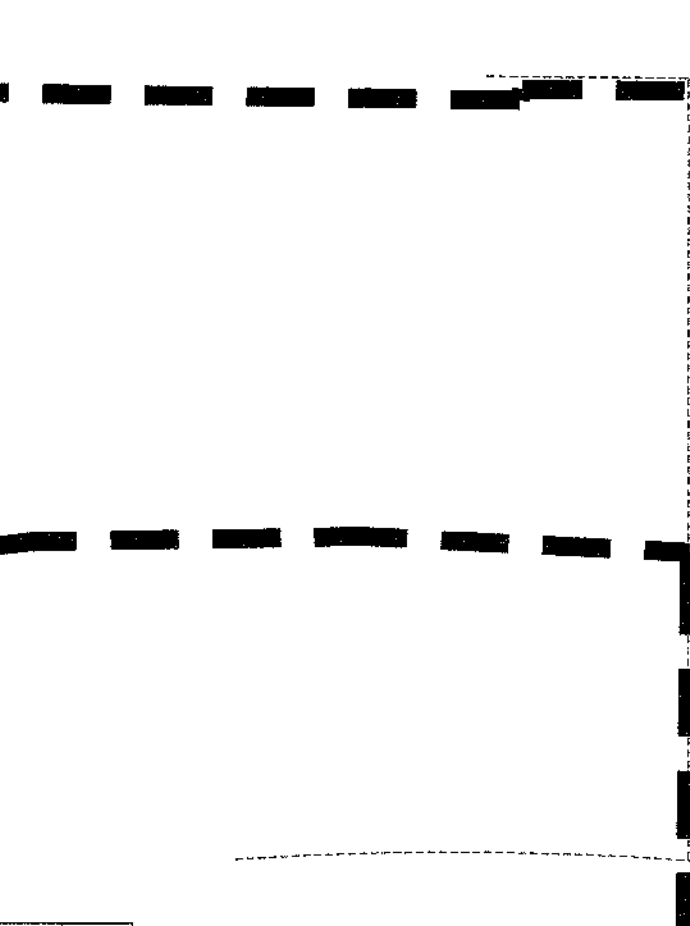
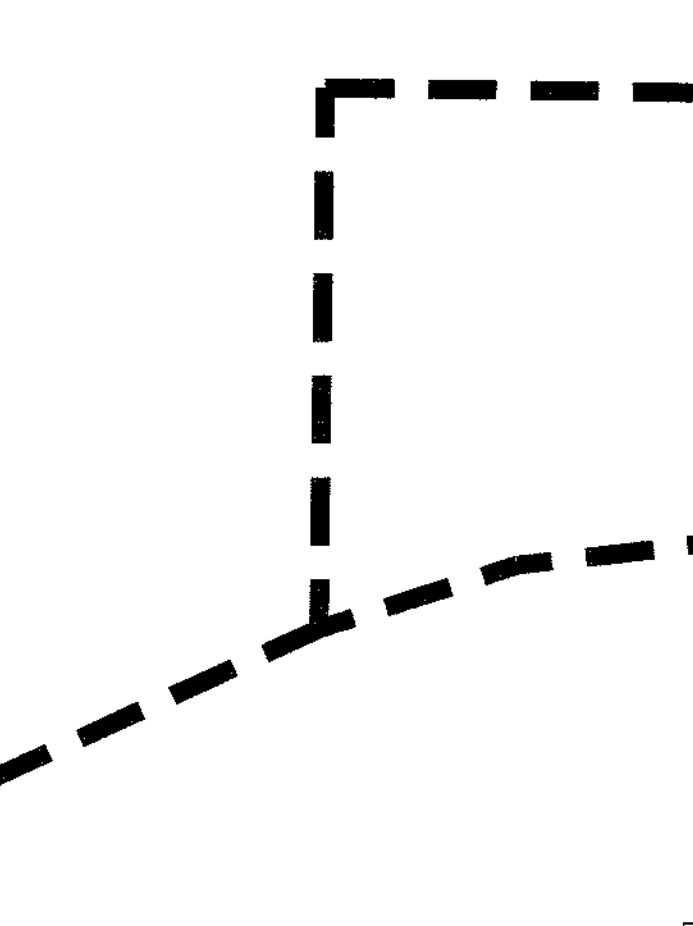
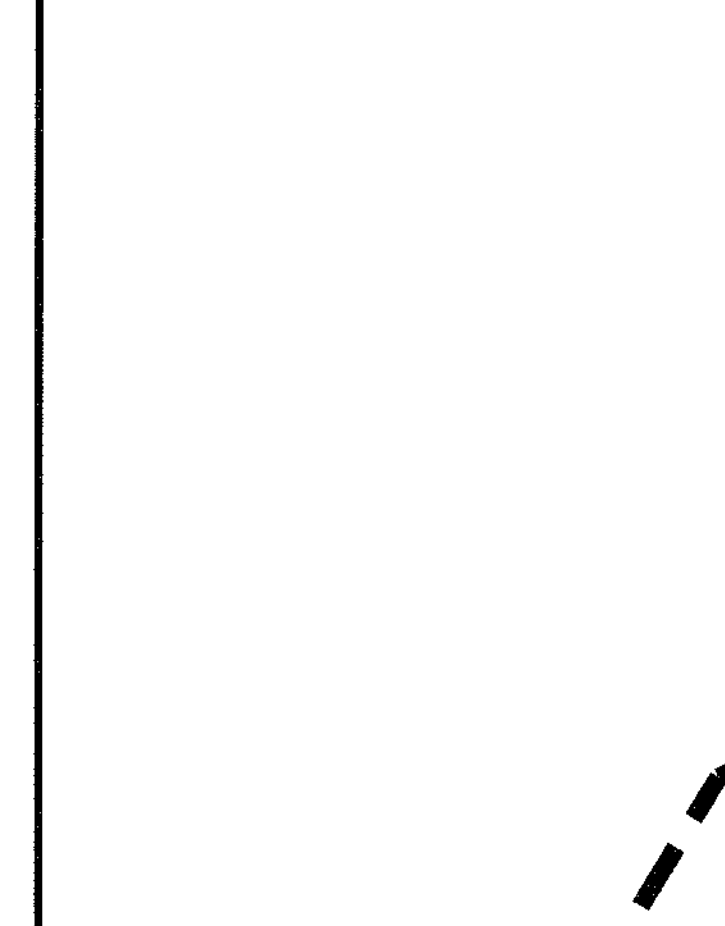
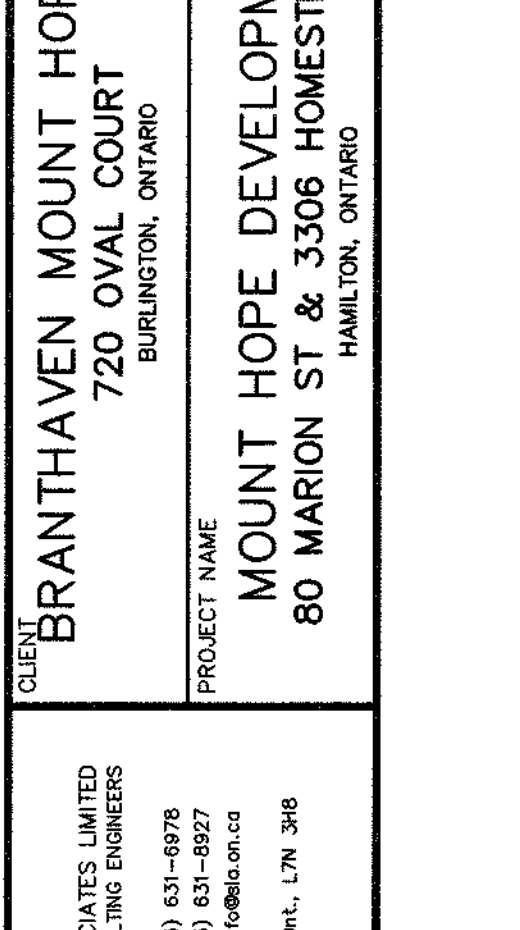
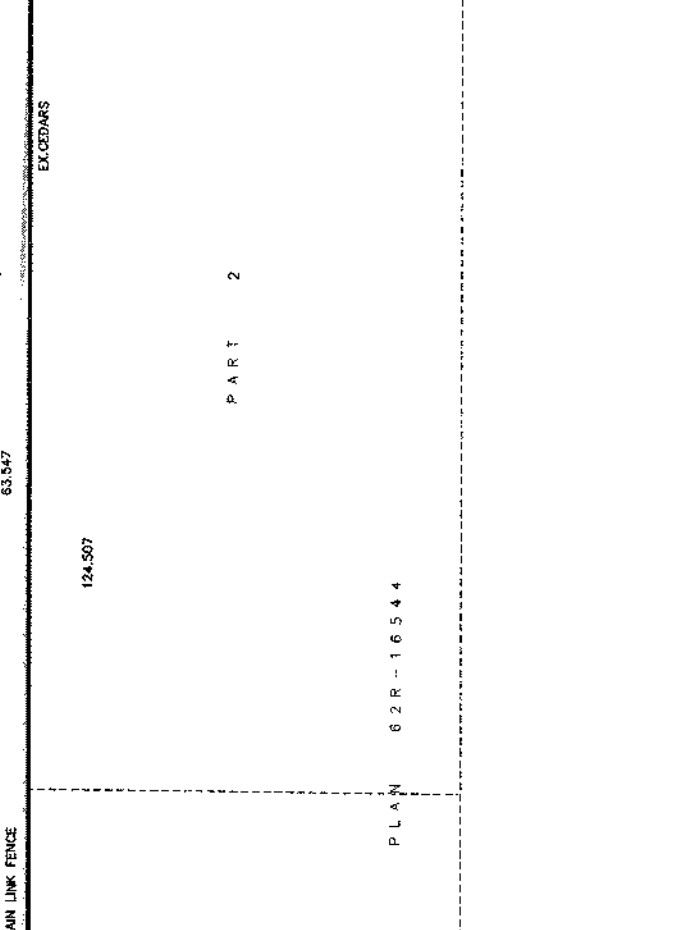
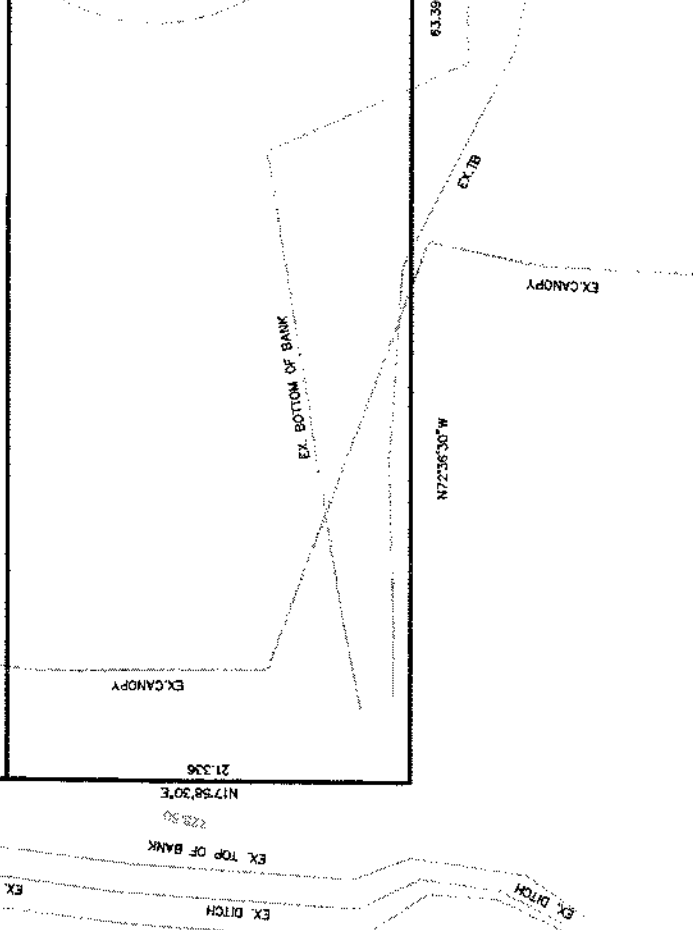
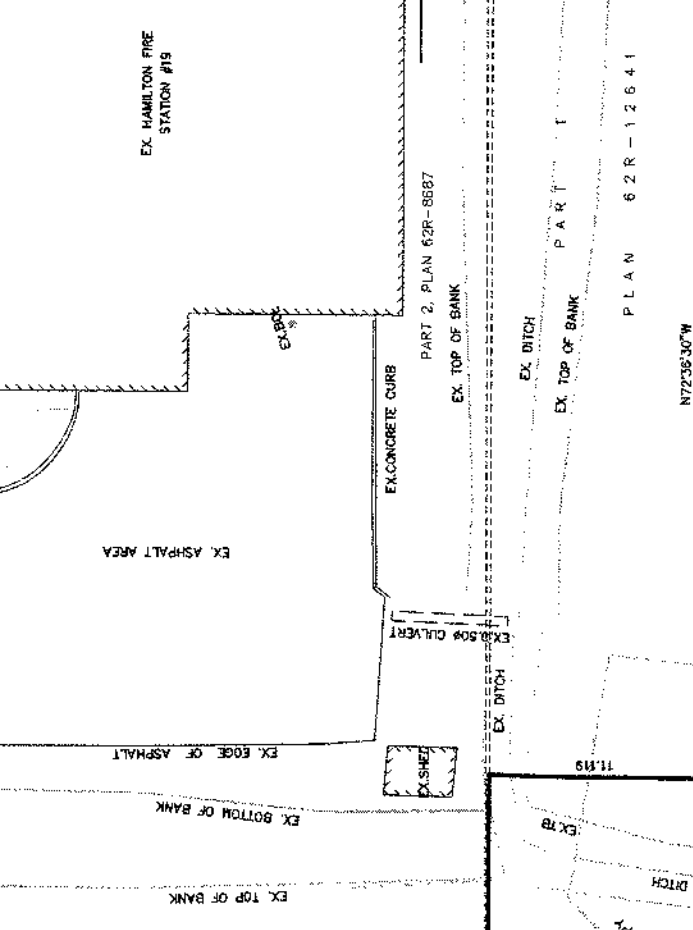
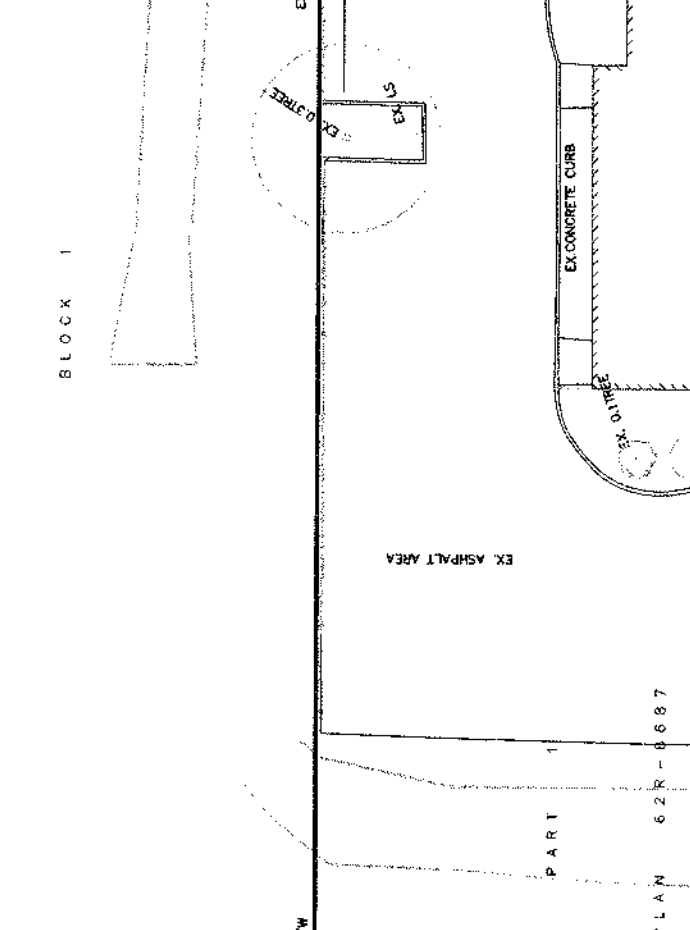
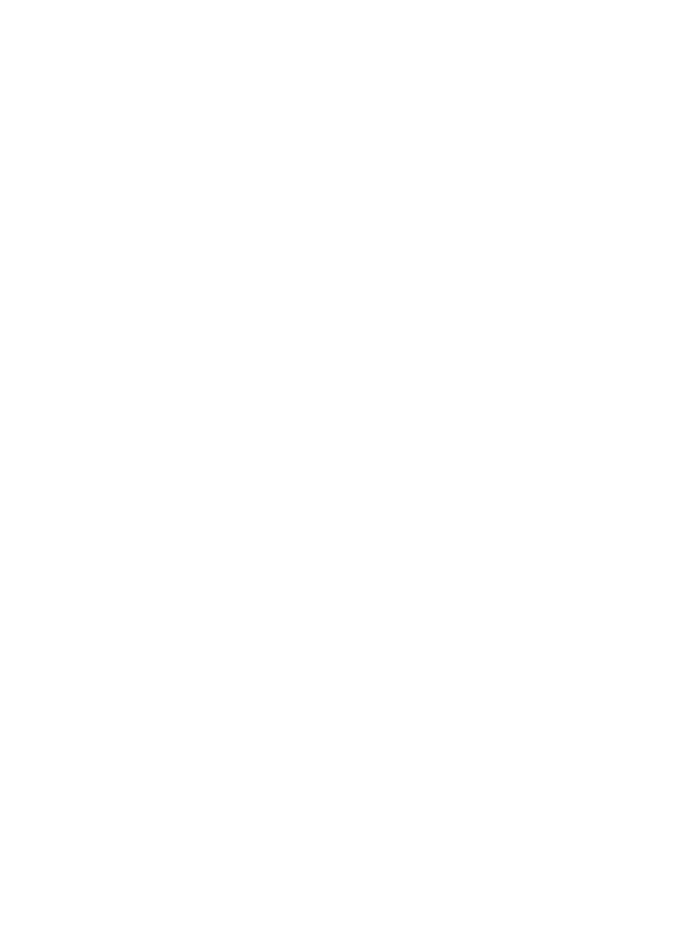
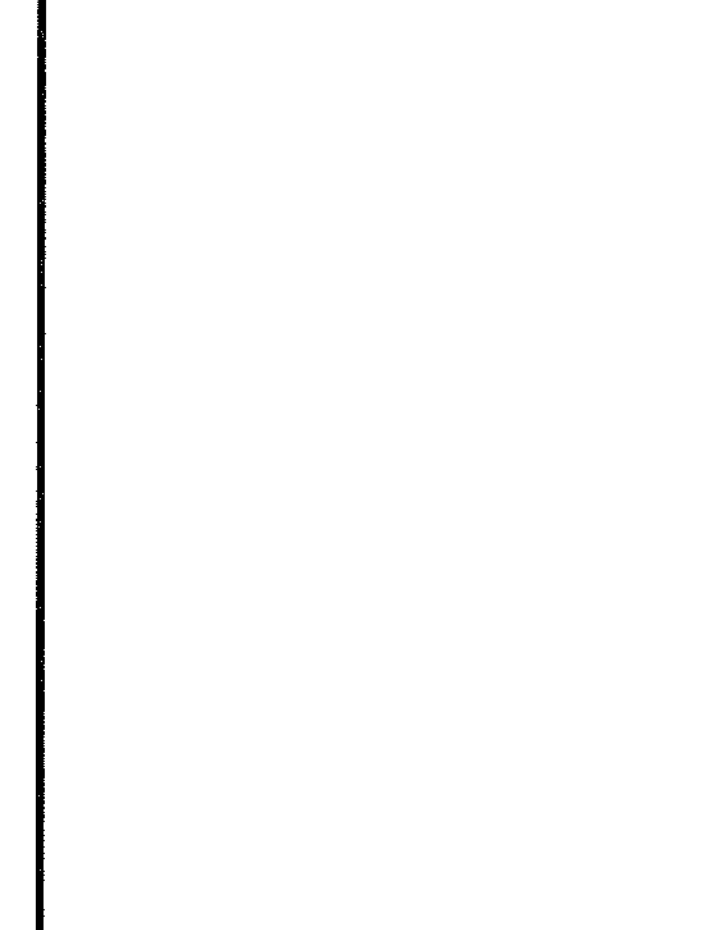

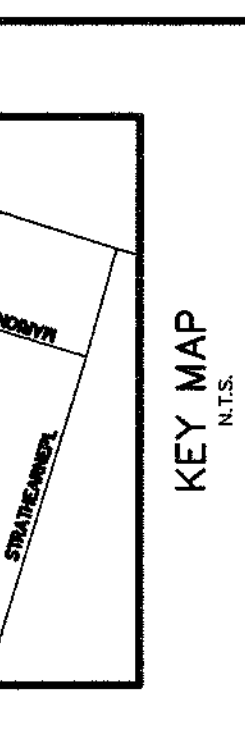
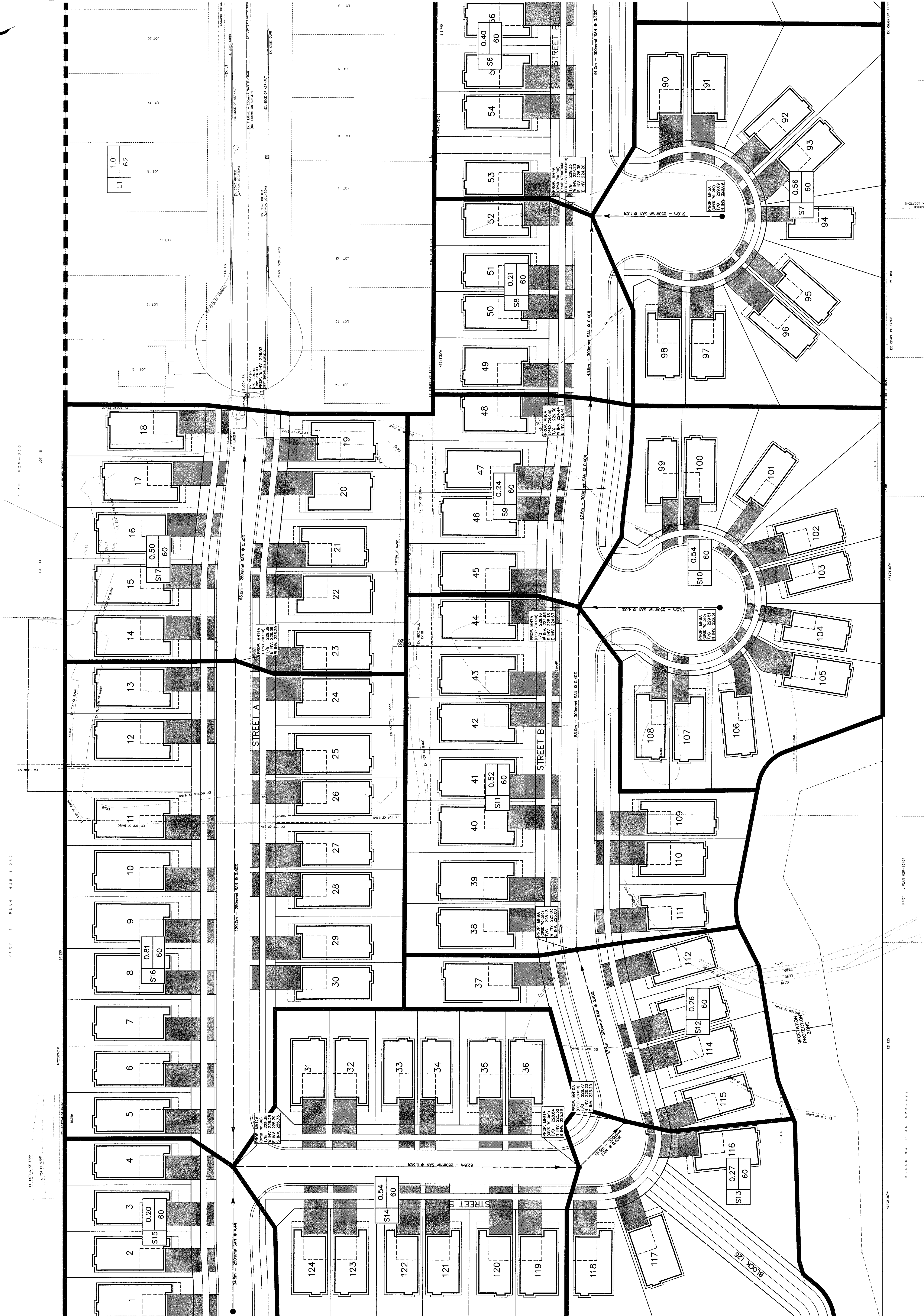

LEGEND:

- AREA IN HECTARES
- POPULATION DENSITY (PERSON PER HECTARE)
- AREA NUMBER
- PROPOSED SANITARY AREA DRAINAGE BOUNDARY
- EXISTING SANITARY AREA DRAINAGE BOUNDARY

SI	0.10	60
E1	1.01	6.2

BENCH MARK NOTE:
 MOUNT HOPE SCHOOL ALONG AIRPORT ROAD,
 5. TABLE IN EAST CONCRETE FOUNDATION, 57cm
 BELOW FINISH GRADE. ELEVATION: 253.03m.
 BELOW FINISH GRADE. ELEVATION: 253.03m. CORN-1928

BRANTHAVEN MOUNT HOPE INC.
 7220 EAST AIRPORT ROAD
 LAMINGTON, ONTARIO
MOUNT HOPE DEVELOPMENT
 80 MARION ST. & 3306 HOMESTEAD DR
 LAMINGTON, ONTARIO

APPROVALS

NO.	DATE	BY	REVISIONS

S. LEWELLYN & ASSOCIATES LIMITED
 CONSULTING ENGINEERS
 16 8000 431-8979
 16 8000 431-8979
 email: hls@lewa.com
 3228 South Service Road, Suite #108 East Wex, Burlington, Ont. L7R 3H8

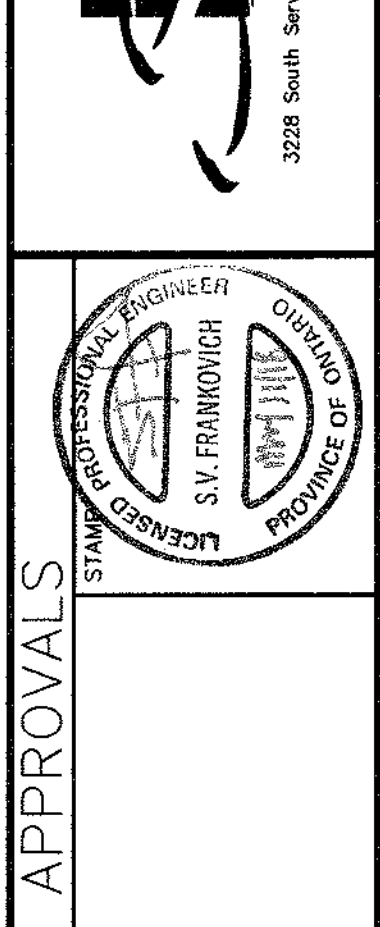

REVISIONS PER CITY COMMENTS

NO.	DATE	BY	REVISIONS

DESIGN: BB
 DRAWN: BB
 CHK'D: SF
 DATE: Oct. 25, 17

PROJECT No. 17085
SCALE 1:300
DAP-3

TITLE: SANITARY DRAINAGE AREA PLAN
1 OF 2

PLAN 62M-860
LOT 15
LOT 14
LOT 13
LOT 12
LOT 11
LOT 10
LOT 9
LOT 8
LOT 7
LOT 6
LOT 5
LOT 4
LOT 3
LOT 2
LOT 1

PLAN 62M-860
LOT 15
LOT 14
LOT 13
LOT 12
LOT 11
LOT 10
LOT 9
LOT 8
LOT 7
LOT 6
LOT 5
LOT 4
LOT 3
LOT 2
LOT 1

PLAN 62M-860
LOT 15
LOT 14
LOT 13
LOT 12
LOT 11
LOT 10
LOT 9
LOT 8
LOT 7
LOT 6
LOT 5
LOT 4
LOT 3
LOT 2
LOT 1

