

1 Section

C3-1

1:50

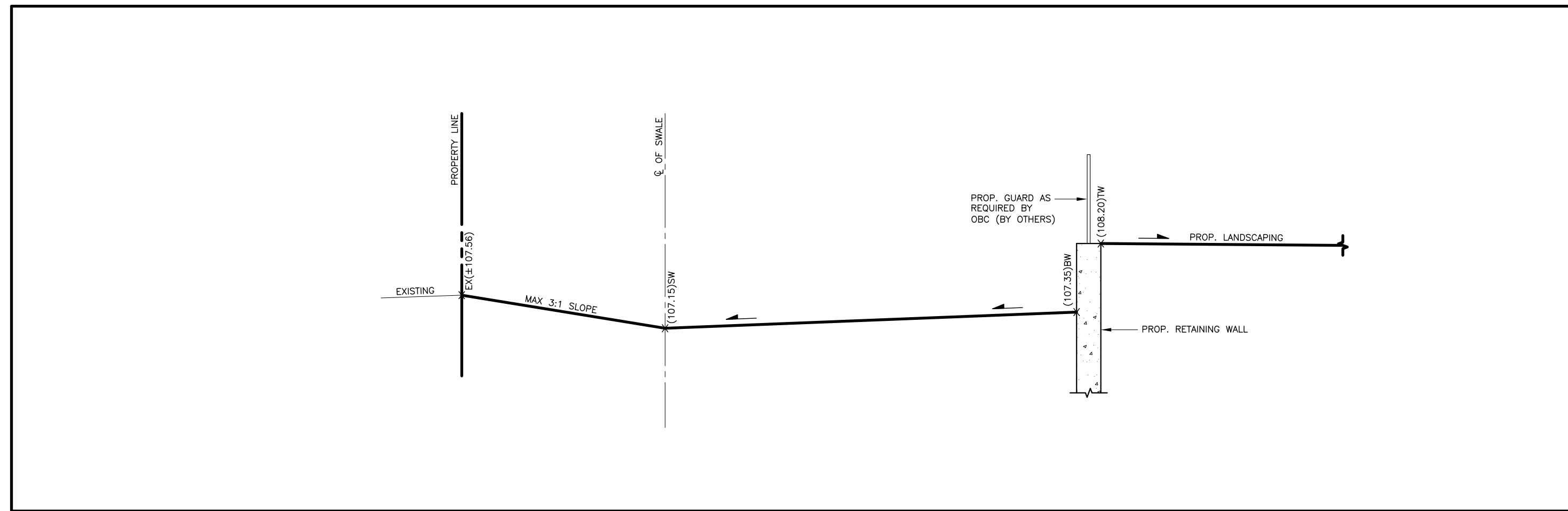

2 Section

C3-1

1:50

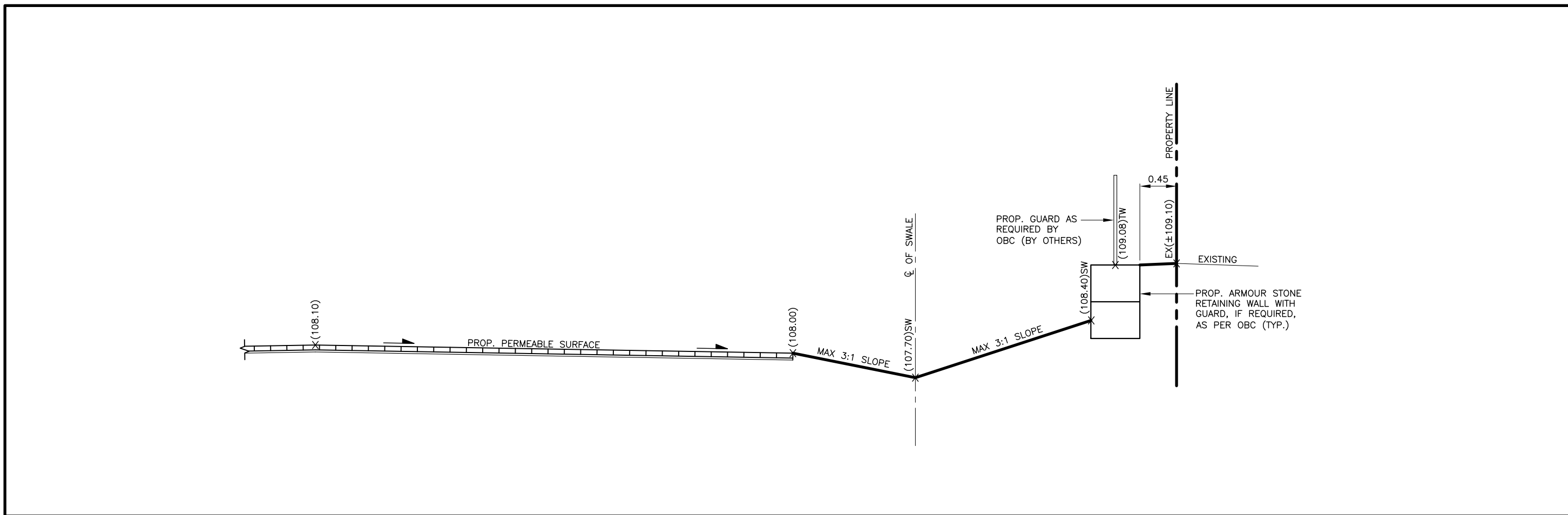

3 Section

C3-1

1:50

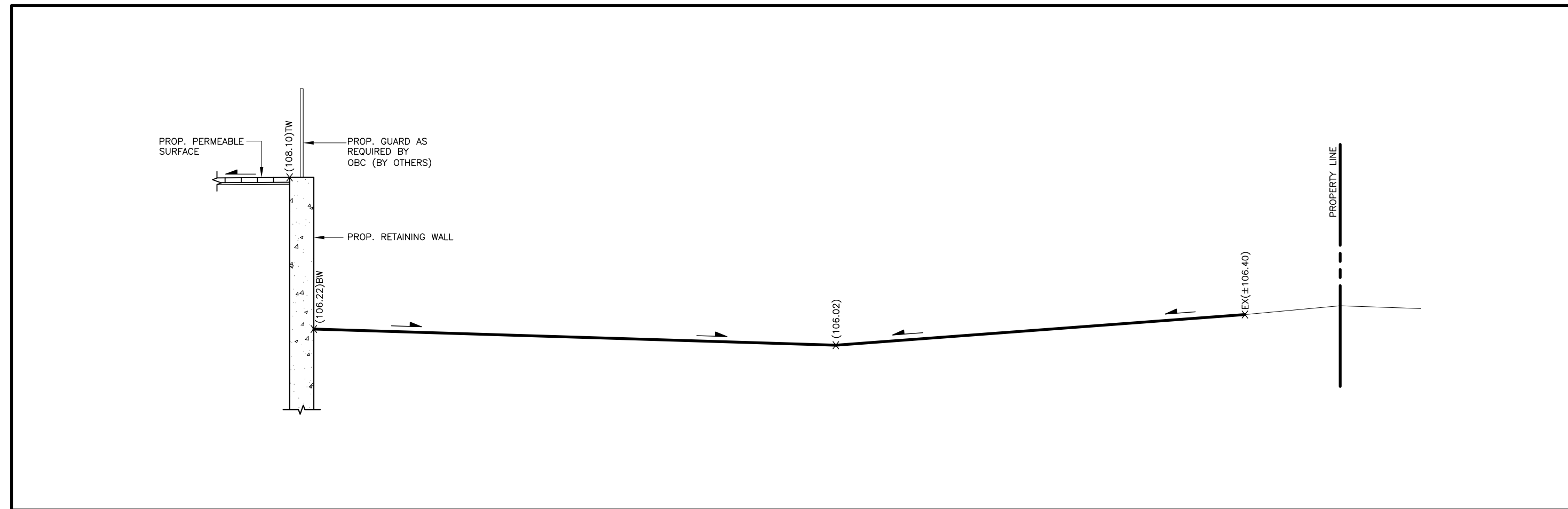

4 Section

C3-1

1:50

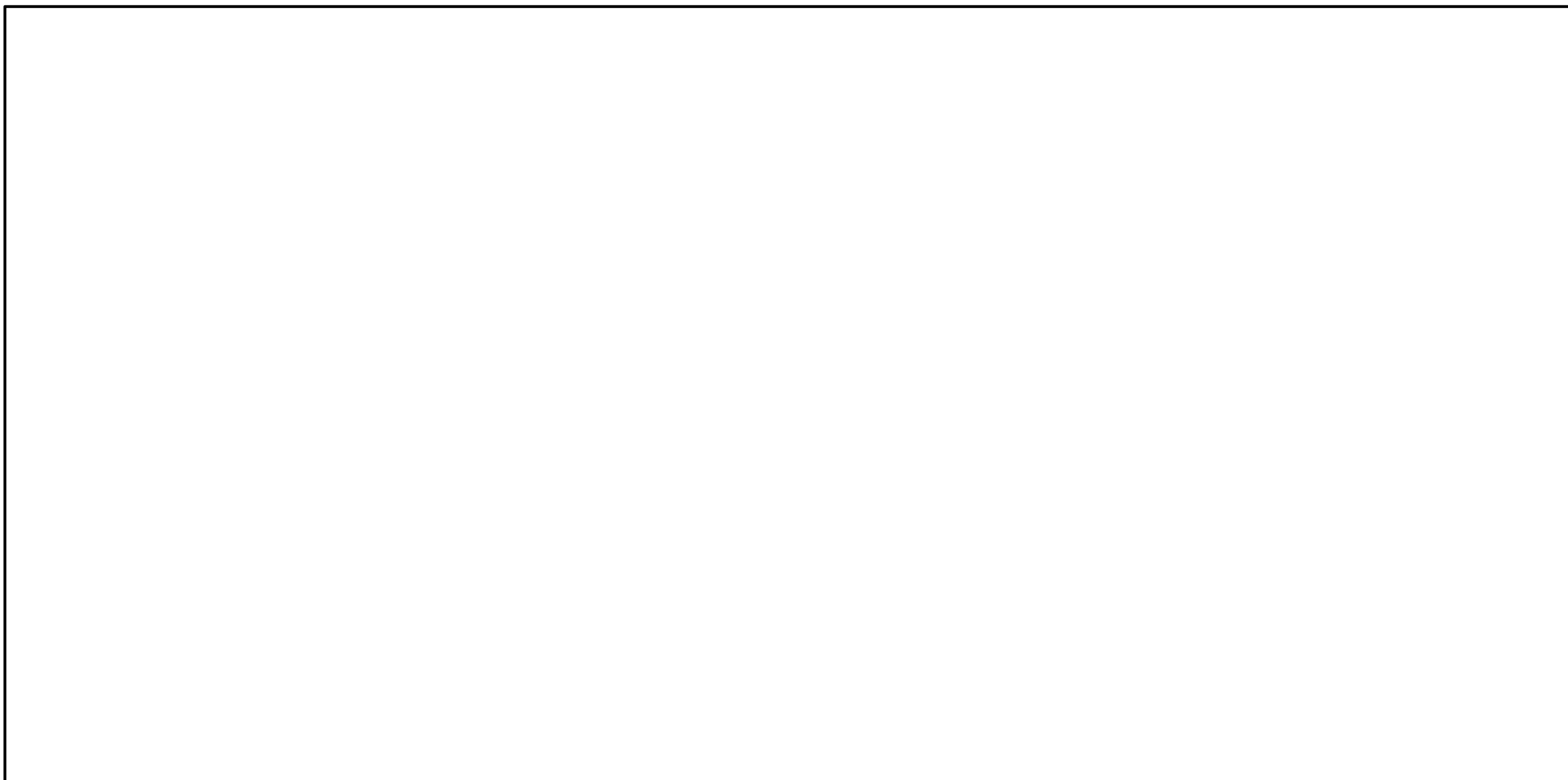

5 Section

C3-1

N.T.S.

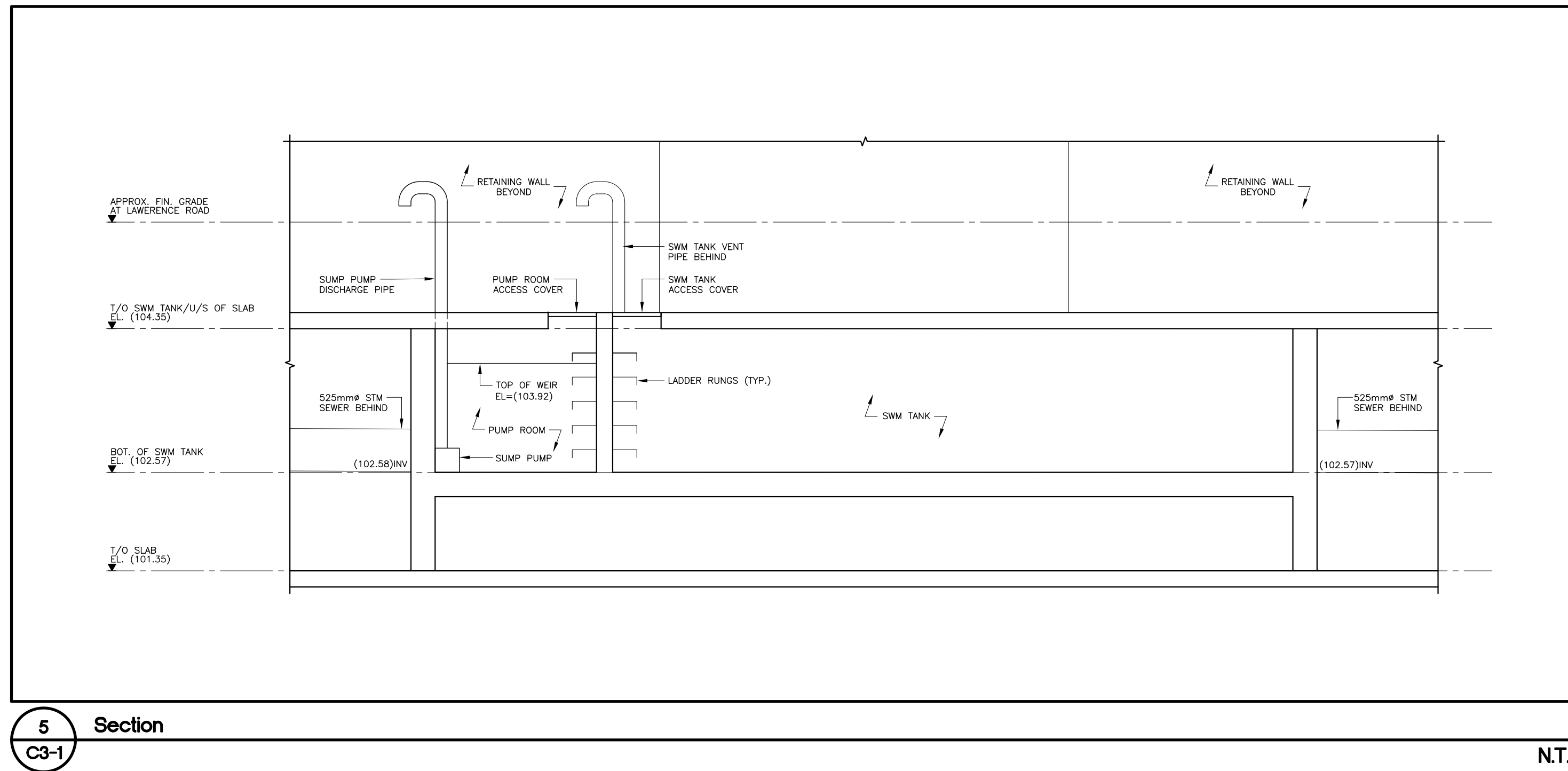

Contractor must verify all dimensions on the Project Site and report any discrepancies before proceeding with the Work.

This drawing is a part of the Contract Documents and is to be read in conjunction with all other Contract Documents.

© COPYRIGHT - LANHACK Consultants Inc. All rights reserved.

SOURCE: EXISTING BOUNDARY SURVEY AND TOPOGRAPHICAL INFORMATION OBTAINED FROM A.T. McJUREN LTD., DWG No. 28975, DATED AUGUST 20, 2020.

THE POSITION OF THE POLE LINES, CONDUITS, WATERMANS, SEWERS, AND OTHER UTILITIES AND STRUCTURES ARE NOT NECESSARILY SHOWN ON THE CONTRACT DRAWINGS, AND WHERE SHOWN, THE ACCURACY OF THE POSITION OF SUCH UTILITIES AND STRUCTURES IS NOT GUARANTEED.

Revision Record

No.	Description	Date (m/d/y)
A	ISSUED AS PER CITY COMMENTS	02/11/22

Issue Record



NOT FOR CONSTRUCTION

LANHACK Consultants Inc.
Consulting Engineers
1709 Upper James Street
Hamilton, ON L8B 1K7
Tel: (905) 777-1454
Fax: (905) 538-6142

NHDGI Pulse Residential Development
1842 KING STREET EAST
HAMILTON, ON

Date: MARCH 2021
Drawn By: GRW
Chkd By: SMP
Scale: AS NOTED

Sections

Project No.: 20064A Drawing No.: C3-1 Rev.: A
Date: 02/11/22
1842 KING STREET EAST - NHDGI and 185 (P&M)
20064A_01 - Grading and Servicing Plan.dwg